

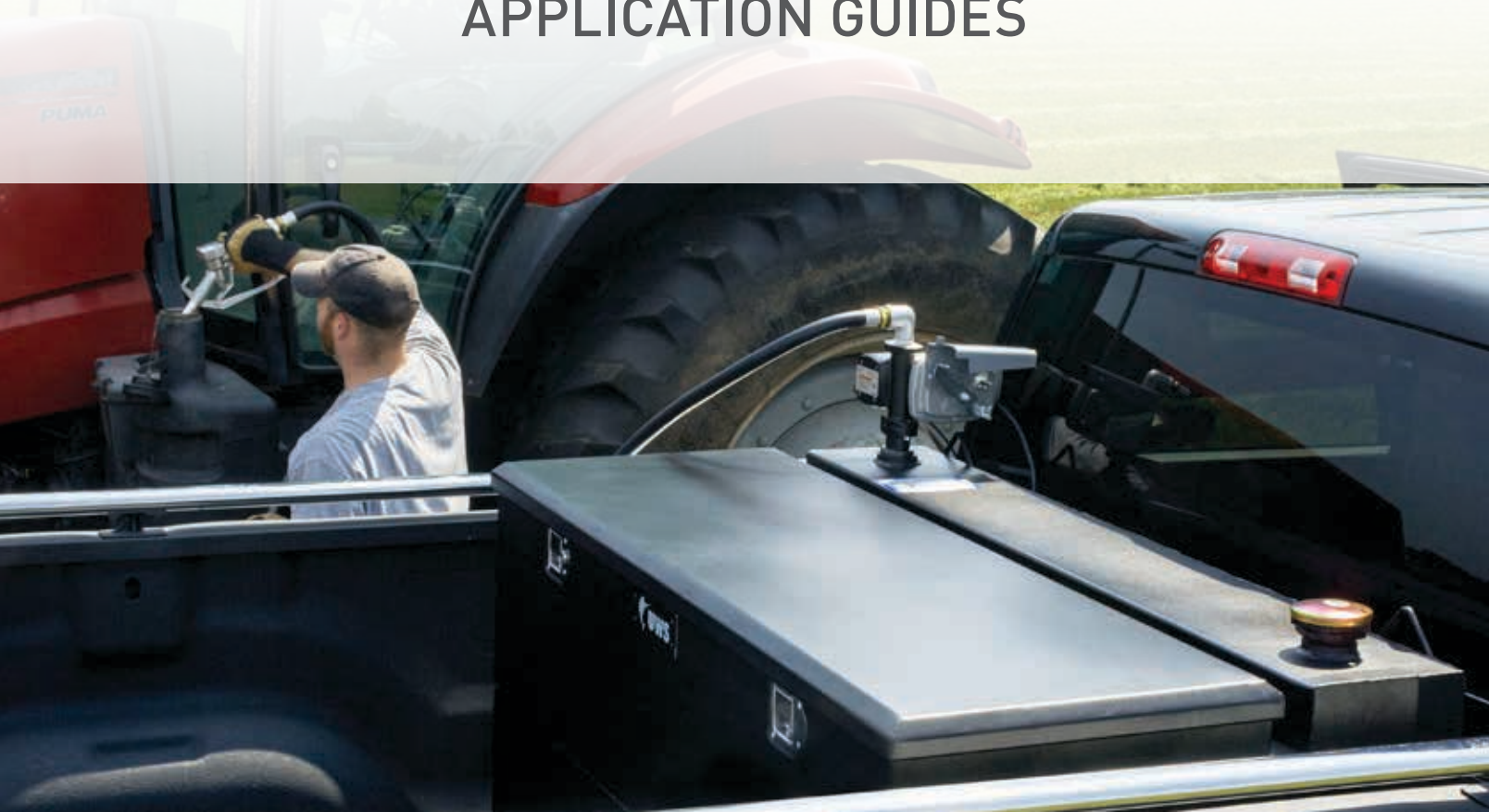

2019 CATALOG
APPLICATION GUIDES





CURT is the leading manufacturer of USA-made trailer hitches and a complete line of towing and electrical products.



ARIES is a fast-paced marketer and innovator of truck, Jeep, SUV and CUV accessories.



UWS is a leading manufacturer and designer of USA-made truck tool boxes.



LUPERNE is a leading manufacturer of functional aftermarket accessories for pickup trucks, commercial vans and SUVs.



RETRAC is a leading manufacturer of OEM and aftermarket mirrors and front-end protection for heavy-duty and medium-duty trucks.

A leading sales, marketing, engineering and distribution company of towing products and truck accessories for all types of vehicles, from passenger cars to commercial trucks. We stand for EXCELLENCE in our products and our associates. We aspire to be the industry LEADER by recognizing that the customer is KING and our associates are our greatest ASSET.



We are a unified team of more than 1,000 dedicated associates world-wide.



We manufacture products in Wisconsin, South Dakota, Florida and Mexico.



We ship from 12 regional warehouses across the United States and Canada.

Steel-aluminum
combo tanks



CONTINUOUS IMPROVEMENT. UNFLINCHING QUALITY.

UWS is committed to continuous improvement in our products, our people and our customer service. For 2019, we are pleased to introduce a variety of new assets and initiatives.

First, we have launched a brand new website at uwsta.com. This new website features a modern look, clearer navigation, improved data and more media assets. We are excited for how this new website will benefit our customers and consumers.

Next, we have launched a heavy-duty packaging initiative. Tool boxes in this program are packed with extra foam padding and placed inside a secondary box to withstand the rigors of parcel shipping. We are so confident in this new initiative that we are offering a damage-free delivery guarantee!

Finally, we are improving our product line with a greater focus on DOT approvals and quality certifications. Our new line of steel transfer tanks is a product of this effort, featuring a 100% pressure-tested design. [See page 82 to learn more.](#)



INNOVATION IN EVERYTHING WE DO.

NEW PRODUCTS



SECURE LOCK UNDER TONNEAU CHEST BOXES

38



UTV SIDE MOUNT TOOL BOXES

60



84

STEEL TRANSFER TANKS



PRODUCT INDEX

ATV Tool Boxes	62
Cargo Carrier	106
Crossover Boxes, Application Guide	24
Crossover Boxes, Extra Wide	18
Crossover Boxes, Gull Wing	14
Crossover Boxes, Pull Handle	12
Crossover Boxes, Secure Lock	10
Crossover Boxes, Slim-Line	16
Crossover Boxes, Standard	20
Dog Boxes, Accessory Box	101
Dog Boxes, Northern	102
Dog Boxes, Southern	100
Drawer Truck Tool Boxes	78
Foot Lockers	56
Ladder Racks	107
Replacement Parts	108
Topside Truck Tool Boxes	66
Tote Boxes	56
Transfer Tanks, Aluminum Combo	88
Transfer Tanks, Aluminum L-Shaped	90

Transfer Tanks, Aluminum Rectangular	90
Transfer Tanks, Application Guide	92
Transfer Tanks, Steel-Aluminum Combo	84
Transfer Tanks, Steel L-Shaped	86
Transfer Tanks, Steel Rectangular	86
Truck Fender Tool Boxes	70
Truck Side Tool Boxes	68
Underbody Tool Boxes	72
Utility Chest Boxes with Drawers	76
Utility Chests, 5th Wheel	50
Utility Chests, Cargo Carrier	52
Utility Chests, Notched	40
Utility Chests, Secure Lock Under Tonneau	38
Utility Chests, Standard	52
Utility Chests, Trailer Tongue	54
Utility Chests, Wedged	42
Utility Chests, Wedged, Application Guide	44
UTV Tool Boxes, Crossover	60
UTV Tool Boxes, Side Mount	60

TABLE OF CONTENTS

CROSSOVER TRUCK BOXES

Multiple sizes, styles, handle types, finishes and more

06 - 35

UTILITY CHEST BOXES

Notched, wedged, 5th wheel, under tonneau, trailer tongue, totes

36 - 57

UTV & ATV BOXES

UTV crossover, UTV side mount, ATV tool boxes

58 - 63

SIDE MOUNT BOXES

Topside, truck side, truck fender, underbody

64 - 73

DRAWER BOXES

Utility chest with drawers, drawer boxes, fender boxes

74 - 81

TRANSFER TANKS

Combo, L-shaped, rectangular

82 - 97

DOG BOXES

Northern, southern, one-door, two-door, accessories box

98 - 103

ACCESSORIES

Cargo carrier, ladder rack, replacement parts

104 - 109

MARKETING MATERIALS

Literature, catalog, banners, retail signage, display stands

110 - 112



CROSSOVER TRUCK TOOL BOXES

LOCK IT UP WITH CONFIDENCE

UWS crossover tool boxes are uniquely dependable and customized for your customers' truck – whether they're working, playing or doing a little of both. Each of our crossover boxes features our patented RigidCore™ foam-filled lid and extra-thick aluminum construction, providing enhanced structural integrity with a lightweight, non-corrosive design. We also offer a wide selection of box sizes and styles, providing a more custom fit in the truck bed versus a one-size-fits-all approach.



FEATURED PRODUCTS



Secure Lock boxes

Secure Lock boxes have unique dual-locking handles for maximum security, as well as a removable BedRug™ liner for easy cleaning.



Pull handle boxes

UWS crossover boxes with pull handles offer a uniquely comfortable grip when operating the lid, and they provide extra hand clearance.



Black badging

New for 2019, we have begun manufacturing our black boxes with a matching black badge, rather than blue, for a sleek, professional look.

PRODUCT INDEX



10

Secure Lock
Boxes

Made in USA



12

Pull Handle
Boxes

Made in USA



14

Gull Wing
Boxes

Made in USA



16

Slim-Line
Boxes

Made in USA



18

Extra-Wide
Boxes

Made in USA



20

Standard
Boxes

Made in USA

CROSSOVER TRUCK TOOL BOXES



KEY FEATURES

Patented RigidCore™ foam-filled lid to maximize strength and prevent binding

0.058" extra-thick, one-piece aluminum tub holds heavy tools and cargo

Product Details

- Stainless steel lock handles for security and corrosion-resistant operation
- Connecting rod allows for convenient operation from driver or passenger side
- Widespread handles are easy to reach from either side of the truck
- Interior rod enclosure helps prevent bending or jamming of lock system
- MicroSeal™ gasket helps seal out moisture, dust and dirt
- Lid self-opens for convenient operation and loading (Secure Lock is self-closing)
- Built-in screwdriver holders for easy organization (select models)
- Sliding tray and built-in tool trays for convenient small item storage and retrieval
- Multiple box sizes available for a custom fit on each truck application
- Easy to install with pre-drilled mounting slots and included hardware
- Multiple styles available, see the product index on page 7 for details
- [See page 24 for application information](#)



TBS-60

TBS-60-BLK

Finishes & Materials



Finish:
Bright
aluminum

Material:
Aluminum
alloy



Finish:
Gloss
black

Material:
Aluminum
alloy



Finish:
Matte
black

Material:
Aluminum
alloy

Profile Options

Standard



Top portion of the tool box overhangs the bed rails to maximize space

Low



Built lower on the bed rail for a better view out the rear window

Handle Options

Secure Lock



Easy-to-operate, dual-locking twist handles for strength and security

Pull



Stainless steel handles provide more clearance for easier opening

Paddle



Standard handle type on most of our tool boxes, opens by pulling outward

Lid Options

Lid Rail



Lid rail provides a reliable anchor for tying down cargo on top

Single



Standard lid type for most of our tool boxes, opened facing the truck bed

Gull Wing



Features two single lids for convenient half-box access

Tub Options

Standard



Tub type for most of our tool boxes, featuring a rectangular shape

Deep



Built extra-low for max space. Available with other tub options

Angled



Accommodates unique bed sizes and wheel well shapes

Slim-Line



Designed for truck beds with very limited space in front of the wheel wells

Extra-Wide



Extra box width provides maximum storage area for tools and equipment

SECURE LOCK CROSSOVER BOXES



KEY FEATURES

Easy-to-operate, dual-locking twist handles offer strength and maximum security

Removable BedRug™ liner protects tools, reduces noise and allows for easy cleaning

See page 24 for application information

See page 8 for a full list of product details and options



SL-69-LP-R

SL-72-A-LP-MB

Finishes & Materials

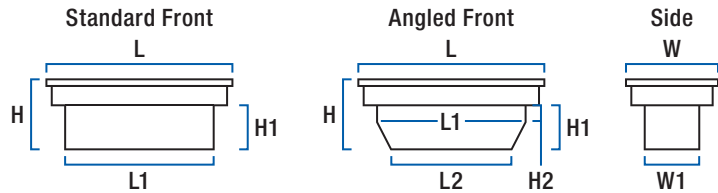
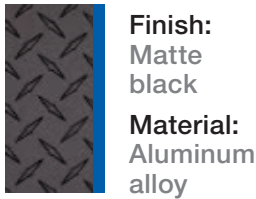
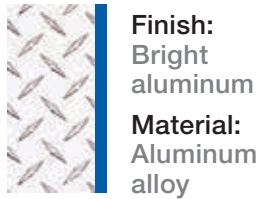

Secure Lock Crossover Boxes

Part#	Profile	Finish	Angled	Rail	Cubic Feet	Dimensions (inches)							
						L	L1	L2	W	W1	H	H1	H2
Standard Tub													
SL-69-LP	Low	Bright alum.	No	No	8.4	69.875	59	--	20	17	14.5	11.75	--
SL-69-LP-MB	Low	Matte black	No	No	8.4	69.875	59	--	20	17	14.5	11.75	--
SL-69-LP-R	Low	Bright alum.	No	Yes	8.4	69.875	59	--	20	17	16.5	11.75	--
SL-69-LP-MB-R	Low	Matte black	No	Yes	8.4	69.875	59	--	20	17	16.5	11.75	--
SL-72-LP	Low	Bright alum.	No	No	8.6	72.875	62	--	20	17	14.5	11.75	--
SL-72-LP-MB	Low	Matte black	No	No	8.6	72.875	62	--	20	17	14.5	11.75	--
SL-72-LP-R	Low	Bright alum.	No	Yes	8.6	72.875	62	--	20	17	16.5	11.75	--
SL-72-LP-MB-R	Low	Matte black	No	Yes	8.6	72.875	62	--	20	17	16.5	11.75	--
Deep Tub													
SLD-69-A-LP*	Low	Bright alum.	Yes	No	10	69.875	59	46	20	17	18.75	15.875	4.375
SLD-69-A-LP-MB*	Low	Matte black	Yes	No	10	69.875	59	46	20	17	18.75	15.875	4.375
SLD69-A-LP-MB-R*	Low	Matte black	Yes	Yes	10	69.875	59	46	20	17	20.75	15.875	4.375

* Built-in screwdriver holder not included

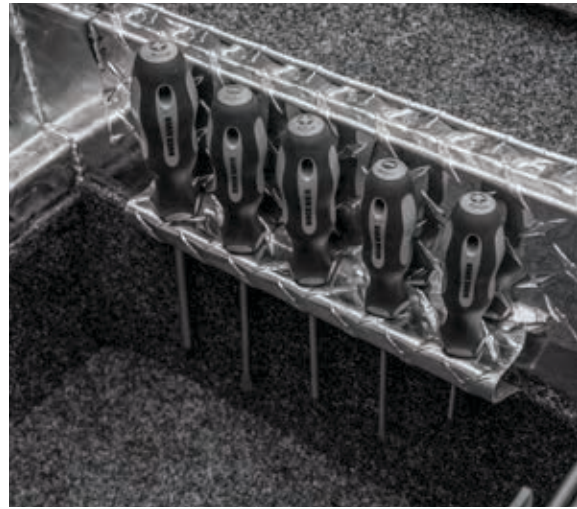

PULL HANDLE CROSSOVER BOXES



KEY FEATURES

Stainless steel pull handles provide more clearance for easier opening

Built lower on the bed rail for a better view out the rear window

See page 24 for application information

See page 8 for a full list of product details and options



Finishes & Materials



Finish:
Bright aluminum
Material:
Aluminum alloy



Finish:
Gloss black
Material:
Aluminum alloy



Finish:
Matte black
Material:
Aluminum alloy

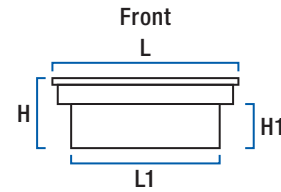

Pull Handle Crossover Boxes

Part#	Profile	Finish	Angled	Rail	Cubic Feet	Dimensions (inches)					
						L	L1	W	W1	H	H1
Standard Tub											
TBS-69-LP-PH	Low	Bright aluminum	No	No	8.4	69.875	59	20	17	14.5	11.75
TBS-69-LP-PH-B	Low	Gloss black	No	No	8.4	69.875	59	20	17	14.5	11.75
TBS-69-LP-PH-MB	Low	Matte black	No	No	8.4	69.875	59	20	17	14.5	11.75
TBS-72-LP-PH	Low	Bright aluminum	No	No	8.6	72.875	62	20	17	14.5	11.75
TBS-72-LP-PH-B	Low	Gloss black	No	No	8.6	72.875	62	20	17	14.5	11.75
TBS-72-LP-PH-MB	Low	Matte black	No	No	8.6	72.875	62	20	17	14.5	11.75



GULL WING CROSSOVER BOXES



KEY FEATURES

Features two single lids for convenient half-box access

Patented RigidCore™ foam-filled lids to maximize strength and prevent binding

See page 24 for application information

See page 8 for a full list of product details and options



Finish & Material



Finish:
Bright aluminum

Material:
Aluminum alloy

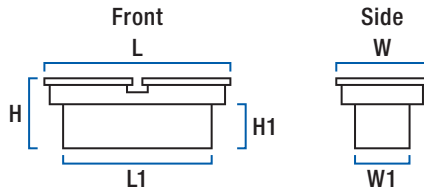

Gull Wing Crossover Boxes

Part#	Profile	Finish	Angled	Rail	Cubic Feet	Dimensions (inches)					
						L	L1	W	W1	H	H1
Standard Tub											
TB-60	Standard	Bright aluminum	No	No	7.3	60.875	50	20	17	14.75	9
TB-63	Standard	Bright aluminum	No	No	8	63.875	53	20	17	14.75	9
TB-69	Standard	Bright aluminum	No	No	8.5	69.875	59	20	17	14.75	9
TB-72	Standard	Bright aluminum	No	No	9	72.875	62	20	17	14.75	9
Deep Tub											
TBD-69	Standard	Bright aluminum	No	No	12.4	69.875	59	20	17	20.5	15
TBD-72	Standard	Bright aluminum	No	No	12.7	72.875	62	20	17	20.5	15



SLIM-LINE CROSSOVER BOXES



KEY FEATURES

Designed for truck beds with extremely limited space in front of the wheel wells

Patented RigidCore™ foam-filled lid to maximize strength and prevent binding

See page 24 for application information

See page 8 for a full list of product details and options



Finishes & Materials

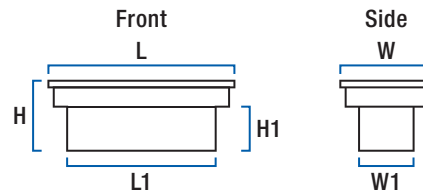
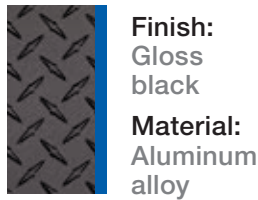
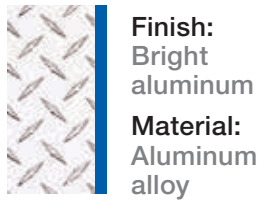

Slim-Line Crossover Boxes											
Part#	Profile	Finish	Angled	Rail	Cubic Feet	Dimensions (inches)					
						L	L1	W	W1	H	H1
Standard Tub											
TBS-60-SL	Standard	Bright aluminum	No	No	3.2	60.875	50	12.75	9.75	10.375	4.625
TBS-60-SL-BLK	Standard	Gloss black	No	No	3.2	60.875	50	12.75	9.75	10.375	4.625
TBS-63-SL	Standard	Bright aluminum	No	No	3.4	63.875	53	12.75	9.75	10.375	4.625
TBS-63-SL-BLK	Standard	Gloss black	No	No	3.4	63.875	53	12.75	9.75	10.375	4.625
TBS-69-SL	Standard	Bright aluminum	No	No	3.8	69.875	59	12.75	9.75	10.375	4.625
TBS-69-SL-LP	Low	Bright aluminum	No	No	3.5	69.875	59	12.75	9.75	10.375	7.5
TBS-69-SL-BLK	Standard	Gloss black	No	No	3.8	69.875	59	12.75	9.75	10.375	4.625
TBS-69-SL-LP-B	Low	Gloss black	No	No	3.5	69.875	59	12.75	9.75	10.375	7.5
TBS-72-SL	Standard	Bright aluminum	No	No	3.9	72.875	62	12.75	9.75	10.375	4.625
TBS-72-SL-BLK	Standard	Gloss black	No	No	3.9	72.875	62	12.75	9.75	10.375	4.625
Deep Tub											
TBSD-69-SL	Standard	Bright aluminum	No	No	6.4	69.875	59	12.75	9.75	18.3125	12.5
TBSD-69-SL-LP	Low	Bright aluminum	No	No	6.1	69.875	59	12.75	9.75	18.3125	15.5
TBSD-69-SL-BLK	Standard	Gloss black	No	No	6.4	69.875	59	12.75	9.75	18.3125	12.5
TBSD-69-SL-LP-B	Low	Gloss black	No	No	6.1	69.875	59	12.75	9.75	18.3125	15.5
TBSD-72-SL-LP	Low	Bright aluminum	No	No	6.5	72.875	62	12.75	9.75	18.3125	15.5
TBSD-72-SL-LP-B	Low	Gloss black	No	No	6.5	72.875	62	12.75	9.75	18.3125	15.5



EXTRA-WIDE CROSSOVER BOXES



KEY FEATURES

Extra box width provides maximum storage area for tools and equipment

Patented RigidCore™ foam-filled lid to maximize strength and prevent binding

See page 24 for application information

See page 8 for a full list of product details and options



TBS-69-LBTA-BLK

TBS-69-LBTA

Finishes & Materials



Finish:
Bright
aluminum
Material:
Aluminum
alloy



Finish:
Gloss
black
Material:
Aluminum
alloy

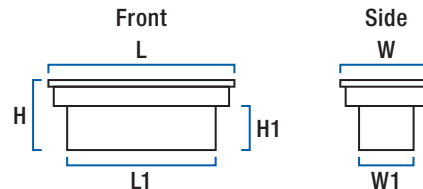

Extra-Wide Crossover Boxes

Part#	Profile	Finish	Angled	Rail	Cubic Feet	Dimensions (inches)					
						L	L1	W	W1	H	H1
Standard Tub											
TBS-69-LBTA	Standard	Bright aluminum	No	No	12.2	69.875	59	28.125	25.25	14	8.5
TBS-69-LBTA-BLK	Standard	Gloss black	No	No	12.2	69.875	59	28.125	25.25	14	8.5
TBS-72-LBTA	Standard	Bright aluminum	No	No	12.7	72.875	62	28.125	25.25	14	8.5
TBS-72-LBTA-BLK	Standard	Gloss black	No	No	12.7	72.875	62	28.125	25.25	14	8.5
Deep Tub											
TBSD-69-LBTA	Standard	Bright aluminum	No	No	16.7	69.875	59	28.125	25.25	18.875	13.25
TBSD-69-LBTA-B	Standard	Gloss black	No	No	16.7	69.875	59	28.125	25.25	18.875	13.25
TBSD-72-LBTA	Standard	Bright aluminum	No	No	17.1	72.875	62	28.125	25.25	18.875	13.25
TBSD-72-LBTA-B	Standard	Gloss black	No	No	17.1	72.875	62	28.125	25.25	18.875	13.25



STANDARD CROSSOVER BOXES



KEY FEATURES

Patented RigidCore™ foam-filled lid to maximize strength and prevent binding

0.058" extra-thick, one-piece aluminum tub holds heavy tools and cargo

[See page 24 for application information](#)

See page 8 for a full list of product details and options



TBSD-60A-BLK



TBS-69-LP-R



TBS-69



TBS-69-LP-MB

Finishes & Materials



Finish:
Bright
aluminum
Material:
Aluminum
alloy



Finish:
Gloss
black
Material:
Aluminum
alloy

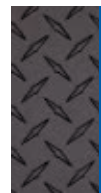

Finish:
Matte
black
Material:
Aluminum
alloy



STANDARD CROSSOVER BOXES

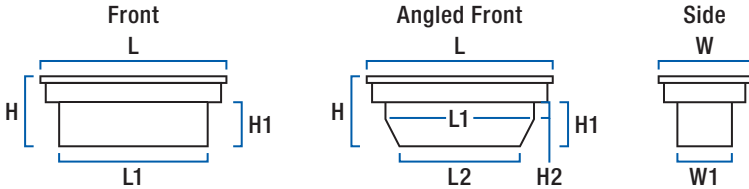

Standard Crossover Boxes

Part#	Profile	Finish	Angled	Rail	Cu. Ft.	Dimensions (inches)							
						L	L1	L2	W	W1	H	H1	H2
Standard Tub													
TBS-54	Standard	Bright aluminum	No	No	6.9	54.875	44	--	20	17	14.75	9	--
TBS-54-LP	Low	Bright aluminum	No	No	6.3	54.875	44	--	20	17	14.75	11.75	--
TBS-54-BLK	Standard	Gloss black	No	No	6.9	54.875	44	--	20	17	14.75	9	--
TBS-54-LP-BLK	Low	Gloss black	No	No	6.3	54.875	44	--	20	17	14.75	11.75	--
TBS-58	Standard	Bright aluminum	No	No	7.1	58.875	48	--	20	17	14.75	9	--
TBS-58-LP	Low	Bright aluminum	No	No	6.6	58.875	48	--	20	17	14.75	11.75	--
TBS-58-BLK	Standard	Gloss black	No	No	7.1	58.875	48	--	20	17	14.75	9	--
TBS-58-LP-BLK	Low	Gloss black	No	No	6.6	58.875	48	--	20	17	14.75	11.75	--
TBS-60	Standard	Bright aluminum	No	No	7.4	60.875	50	--	20	17	14.75	9	--
TBS-60-LP	Low	Bright aluminum	No	No	7.2	60.875	50	--	20	17	14.75	11.75	--
TBS-60-BLK	Standard	Gloss black	No	No	7.4	60.875	50	--	20	17	14.75	9	--
TBS-60-LP-BLK	Low	Gloss black	No	No	7.2	60.875	50	--	20	17	14.75	11.75	--
TBS-60-A*	Standard	Bright aluminum	Yes	No	7	60.875	50	35.75	20	17	14.75	9	3
TBS-60-A-LP*	Low	Bright aluminum	Yes	No	6.6	60.875	50	35.75	20	17	14.75	11.75	3.125
TBS-60-A-BLK*	Standard	Gloss black	Yes	No	7	60.875	50	35.75	20	17	14.75	9	3
TBS-60-A-LP-BLK*	Low	Gloss black	Yes	No	6.6	60.875	50	35.75	20	17	14.75	11.75	3.125
TBS-63	Standard	Bright aluminum	No	No	7.8	63.875	53	--	20	17	14.75	9	--
TBS-63-LP	Low	Bright aluminum	No	No	7.3	63.875	53	--	20	17	14.75	11.75	--
TBS-63-BLK	Standard	Gloss black	No	No	7.8	63.875	53	--	20	17	14.75	9	--
TBS-63-LP-BLK	Low	Gloss black	No	No	7.3	63.875	53	--	20	17	14.75	11.75	--
TBS-63-A*	Standard	Bright aluminum	Yes	No	7.4	63.875	53	38.75	20	17	14.75	9	3
TBS-63-A-LP*	Low	Bright aluminum	Yes	No	7	63.875	53	38.75	20	17	14.75	11.75	2.875
TBS-63-A-BLK*	Standard	Gloss black	Yes	No	7.4	63.875	53	38.75	20	17	14.75	9	3
TBS-63-A-LP-BLK*	Low	Gloss black	Yes	No	7	63.875	53	38.75	20	17	14.75	11.75	2.875
TBS-63-A-LP-MB*	Low	Matte black	Yes	No	7	63.875	53	38.75	20	17	14.75	11.75	2.875
TBS-66	Standard	Bright aluminum	No	No	8.2	66.875	56	--	20	17	14.75	9	--
TBS-66-LP	Low	Bright aluminum	No	No	7.5	66.875	56	--	20	17	14.75	11.75	--
TBS-66-BLK	Standard	Gloss black	No	No	8.2	66.875	56	--	20	17	14.75	9	--
TBS-66-LP-BLK	Low	Gloss black	No	No	7.5	66.875	56	--	20	17	14.75	11.75	--

* Built-in screwdriver holder not included

Standard Crossover Boxes

Part#	Profile	Finish	Angled	Rail	Cu. Ft.	Dimensions (inches)							
						L	L1	L2	W	W1	H	H1	H2
Standard Tub (continued)													
TBS-69	Standard	Bright aluminum	No	No	8.6	69.875	59	--	20	17	14.75	9	--
TBS-69-LP	Low	Bright aluminum	No	No	8.4	69.875	59	--	20	17	14.75	11.75	--
TBS-69-BLK	Standard	Gloss black	No	No	8.6	69.875	59	--	20	17	14.75	9	--
TBS-69-LP-BLK	Low	Gloss black	No	No	8.4	69.875	59	--	20	17	14.75	11.75	--
TBS-69-MB	Standard	Matte black	No	No	8.6	69.875	59	--	20	17	14.75	9	--
TBS-69-LP-MB	Low	Matte black	No	No	8.4	69.875	59	--	20	17	14.75	11.75	--
TBS-69-A-LP*	Low	Bright aluminum	Yes	No	8.3	69.875	59	48	20	17	14.75	11.75	2.875
TBS-69-A-LP-BLK*	Low	Gloss black	Yes	No	8.3	69.875	59	48	20	17	14.75	11.75	2.875
TBS-69-LBTA	Standard	Bright aluminum	No	No	12.2	69.875	59	--	28.125	25.25	14	8.5	--
TBS-69-LBTA-BLK	Standard	Gloss black	No	No	12.2	69.875	59	--	28.125	25.25	14	8.5	--
TBS-69-R	Standard	Bright aluminum	No	Yes	8.6	69.875	59	--	20	17	14.75	9	--
TBS-69-LP-R	Low	Bright aluminum	No	Yes	8.4	69.875	59	20	17	16.75	11.75		--
TBS-72	Standard	Bright aluminum	No	No	9	72.875	62	--	20	17	14.75	9	--
TBS-72-LP	Low	Bright aluminum	No	No	8.6	72.875	62	--	20	17	14.75	11.75	--
TBS-72-BLK	Standard	Gloss black	No	No	9	72.875	62	--	20	17	14.75	9	--
TBS-72-LP-BLK	Low	Gloss black	No	No	8.6	72.875	62	--	20	17	14.75	11.75	--
TBS-72-MB	Standard	Matte black	No	No	9	72.875	62	--	20	17	14.75	9	--
TBS-72-LP-MB	Low	Matte black	No	No	8.6	72.875	62	--	20	17	14.75	11.75	--
TBS-72-LBTA	Standard	Bright aluminum	No	No	12.7	72.875	62	--	28.125	25.25	14	8.5	--
TBS-72-LBTA-BLK	Standard	Gloss black	No	No	12.7	72.875	62	--	28.125	25.25	14	8.5	--
TBS-72-R	Standard	Bright aluminum	No	Yes	9	72.875	62	--	20	17	14.75	9	--
Deep Tub													
TBSD-60A*	Standard	Bright aluminum	Yes	No	7.5	60.875	50	38	20	17	20.75	15	--
TBSD-60A-LP	Low	Bright aluminum	Yes	No	6.3	60.875	50	35.75	20	17	17.75	14.875	2.875
TBSD-60A-BLK*	Standard	Gloss black	Yes	No	7.5	60.875	50	38	20	17	20.75	15	--
TBSD-60A-LP-BLK	Low	Gloss black	Yes	No	6.3	60.875	50	35.75	20	17	17.75	14.875	2.875
TBSD-63	Standard	Bright aluminum	No	No	7.7	63.875	53	--	20	17	20.75	15	--
TBSD-63A*	Standard	Bright aluminum	Yes	No	7.7	63.875	53	40	20	17	20.75	15.875	--
TBSD-63A-LP*	Low	Bright aluminum	Yes	No	6.8	63.875	53	36	20	17	17.75	15.875	2.875
TBSD-63A-BLK*	Standard	Gloss black	Yes	No	7.7	63.875	53	40	20	17	20.75	15	--
TBSD-63A-LP-BLK*	Low	Gloss black	Yes	No	6.8	63.875	53	36	20	17	17.75	14.875	2.875
TBSD-69	Standard	Bright aluminum	No	No	12.4	69.875	59	--	20	17	20.75	15	--
TBSD-69-LP	Low	Bright aluminum	No	No	10.8	69.875	59	--	20	17	18.75	15.875	--
TBSD-69-BLK	Standard	Gloss black	No	No	12.4	69.875	59	--	20	17	20.75	15	--
TBSD-69-LP-BLK	Low	Gloss black	No	No	10.8	69.875	59	--	20	17	18.75	15.875	--
TBSD-69-A	Standard	Bright aluminum	Yes	No	10.2	69.875	59	46	20	17	20.75	15	3.78
TBSD-69-A-LP*	Low	Bright aluminum	Yes	No	10	69.875	59	46	20	17	18.75	15.875	2.875
TBSD-69-A-BLK	Standard	Gloss black	Yes	No	10.2	69.875	59	46	20	17	20.75	15	3.75
TBSD-69-A-LP-B*	Low	Gloss black	Yes	No	10	69.875	59	46	20	17	18.75	15.875	2.875
TBSD-69-A-MB	Standard	Matte black	Yes	No	10.2	69.875	59	46	20	17	20.75	15	3.75
TBSD-69-A-LP-MB*	Low	Matte black	Yes	No	10	69.875	59	46	20	17	18.75	15.875	2.875
TBSD-69-LBTA	Standard	Bright aluminum	No	No	16.7	69.875	59	--	28.125	25.25	18.875	13.25	--
TBSD-69-LBTA-B	Standard	Gloss black	No	No	16.7	69.875	59	--	28.125	25.25	18.875	13.25	--
TBSD-72-A	Standard	Bright aluminum	Yes	No	12.6	72.875	62	56	20	17	20.75	15	12
TBSD-72-A-LP	Low	Bright aluminum	Yes	No	11.2	72.875	62	56	20	17	18.75	15.875	2.875
TBSD-72-A-BLK	Standard	Gloss black	Yes	No	12.6	72.875	62	56	20	17	20.75	15	12
TBSD-72-A-LP-B	Low	Gloss black	Yes	No	11.2	72.875	62	56	20	17	18.75	15.875	2.875
TBSD-72-LBTA	Standard	Bright aluminum	No	No	17.1	72.875	62	--	28.125	25.25	18.875	13.25	--
TBSD-72-LBTA-B	Standard	Gloss black	No	No	17.1	72.875	62	--	28.125	25.25	18.875	13.25	--

* Built-in screwdriver holder not included



Available ordering options
(listed above part numbers)
All part#s listed are Bright Aluminum. Use key below to identify alternative finishes or to add a rail. Then add desired suffix shown to end of part#.

A - Matte Black (add **-MB**)
B - Aluminum with Rail (add **-R**)
C - Matte Black with Rail (add **-MB-R**)
E - Gloss Black (add **-BLK**)

Secure Lock		Pull Handle		Gull Wing				Slim Line										
Stand.	D.	Stand.	Standard		Deep		Standard				Deep							
A, B, C	A, B, C	A, C†	A, E*	A, E*	--	--	--	--	--	E	E	E	E*	E	E	E*	E*	
SL-69-LP	SL-72-LP	SLD-69-A-LP	TBS-69-LP-PH	TBS-72-LP-PH	TB-60	TB-63	TB-69	TB-72	TBD-69	TBD-72	TBS-60-SL	TBS-63-SL	TBS-69-SL	TBS-69-SL-LP	TBS-72-SL	TBSD-69-SL	TBSD-69-SL-LP	TBSD-72-SL-LP

Make / Model	Cab Length	Years	Bed Style	Bed Length	Foot Notes	SL-69-LP	SL-72-LP	SLD-69-A-LP	TBS-69-LP-PH	TBS-72-LP-PH	TB-60	TB-63	TB-69	TB-72	TBD-69	TBD-72	TBS-60-SL	TBS-63-SL	TBS-69-SL	TBS-69-SL-LP	TBS-72-SL	TBSD-69-SL	TBSD-69-SL-LP	TBSD-72-SL-LP		
Chevrolet																										
Colorado	Crew	19 - 19	Fleetside	5'	--	--	--	--	--	--	•	--	--	--	--	--	--	•	--	--	--	--	--	--	--	
		15 - 18	Fleetside	5' 6"	--	--	--	--	--	--	--	•	--	--	--	--	--	--	•	--	--	--	--	--	--	--
		15 - 18	Fleetside	6'	--	--	--	--	--	--	--	•	--	--	--	--	--	--	•	--	--	--	--	--	--	--
		04 - 12	Styleside	5' 5"	--	--	--	--	--	--	--	--	--	--	--	--	--	--	--	--	--	--	--	--	--	--
		04 - 12	Styleside	6'	--	--	--	--	--	--	--	--	--	--	--	--	--	--	--	--	--	--	--	--	--	--
S10	Standard	04 - 12	Styleside	6'	--	--	--	--	--	--	--	--	--	--	--	--	--	--	--	--	--	--	--	--	--	
		15 - 18	Fleetside	6'	--	--	--	--	--	--	--	•	--	--	--	--	--	--	•	--	--	--	--	--	--	--
Silverado 1500	Crew	01 - 04	Fleetside	4' 8"	--	--	--	--	--	•	--	--	--	--	--	--	•	--	--	--	--	--	--	--	--	
		94 - 03	Fleetside	6'	--	--	--	--	--	•	--	--	--	--	--	--	--	•	--	--	--	--	--	--	--	
		96 - 03	Stepside	6'	--	--	--	--	--	--	--	--	--	--	--	--	--	--	--	--	--	--	--	--	--	--
		94 - 03	Fleetside	6'	--	--	--	--	--	•	--	--	--	--	--	--	--	•	--	--	--	--	--	--	--	--
	Extended	94 - 03	Fleetside	7' 6"	--	--	--	--	--	•	--	--	--	--	--	--	--	•	--	--	--	--	--	--	--	--
		14 - 19	Fleetside	5' 8"	--	•	--	•	--	--	--	•	--	•	--	--	--	--	•	•	--	--	•	•	--	--
		14 - 19	Fleetside	6' 6"	--	•	--	•	--	--	--	•	--	•	--	--	--	--	•	•	--	--	•	•	--	--
		07 - 13	Fleetside	5' 8"	--	--	--	--	--	--	--	•	--	--	--	--	--	--	•	•	--	--	•	•	--	--
		04 - 06	Fleetside	8'	--	•	--	•	--	--	--	•	--	•	--	--	--	--	•	•	--	--	•	•	--	--
		99 - 06	Fleetside	5' 8.5"	--	--	--	--	--	--	--	•	--	•	--	--	--	--	•	•	--	--	•	•	--	--
		14 - 19	Fleetside	6' 6"	--	•	--	•	--	--	--	•	--	•	--	--	--	--	•	•	--	--	•	•	--	--
		07 - 13	Fleetside	6' 6"	--	•	--	•	--	--	--	•	--	•	--	--	--	--	•	•	--	--	•	•	--	--
	Standard	07 - 13	Fleetside	8'	--	•	--	•	--	--	--	•	--	•	--	--	--	--	•	•	--	--	•	•	--	--
		99 - 05	Stepside	6' 6"	--	--	--	--	--	--	--	--	--	--	--	--	--	--	--	--	--	--	--	--	--	--
		99 - 06	Fleetside	6' 6"	--	•	--	•	--	--	--	•	--	•	--	--	--	--	•	•	--	--	•	•	--	--
		99 - 06	Fleetside	8'	--	•	--	•	--	--	--	•	--	•	--	--	--	--	•	•	--	--	•	•	--	--
14 - 19		Fleetside	6' 6"	--	•	--	•	--	--	--	•	--	•	--	--	--	--	•	•	--	--	•	•	--	--	
14 - 19		Fleetside	8'	--	•	--	•	--	--	--	•	--	•	--	--	--	--	•	•	--	--	•	•	--	--	
07 - 13		Fleetside	6' 6"	--	•	--	•	--	--	--	•	--	•	--	--	--	--	•	•	--	--	•	•	--	--	
07 - 13		Fleetside	8'	--	•	--	•	--	--	--	•	--	•	--	--	--	--	•	•	--	--	•	•	--	--	
Silverado 1500 Classic	Crew	07 - 07	Fleetside	5' 8.5"	--	--	--	--	--	--	•	--	•	--	--	--	--	•	•	--	--	•	•	--	--	
		07 - 07	Fleetside	8'	--	•	--	•	--	--	•	--	•	--	--	--	--	•	•	--	--	•	•	--	--	
	Standard	07 - 07	Fleetside	6' 6"	--	•	--	•	--	--	--	•	--	•	--	--	--	--	•	•	--	--	•	•	--	--
07 - 07		Fleetside	8'	--	•	--	•	--	--	--	•	--	•	--	--	--	--	•	•	--	--	•	•	--	--	
Silverado 1500 Legacy	Standard	07 - 07	Fleetside	8'	--	•	--	•	--	--	--	•	--	--	--	--	--	•	•	--	--	•	•	--	--	
Silverado 2500		07 - 07	Fleetside	6' 6"	--	•	--	•	--	--	--	--	•	--	--	--	--	•	•	--	--	•	•	--	--	
Silverado 2500 HD	Crew	19 - 19	Fleetside	6' 6"	--	•	--	•	--	--	--	•	--	•	--	--	--	•	•	--	--	•	•	--	--	
		15 - 19	Fleetside	8'	--	•	--	•	--	--	--	•	--	•	--	--	--	•	•	--	--	•	•	--	--	
	Extended	01 - 06	Fleetside	8'	--	•	--	•	--	--	--	•	--	•	--	--	--	•	•	--	--	•	•	--	--	
		01 - 19	Fleetside	6' 6"	--	•	--	•	--	--	--	•	--	•	--	--	--	--	•	•	--	--	•	•	--	--
	Standard	01 - 19	Fleetside	8'	--	•	--	•	--	--	--	•	--	•	--	--	--	--	•	•	--	--	•	•	--	--
01 - 06		Fleetside	6' 6"	--	•	--	•	--	--	--	•	--	•	--	--	--	--	•	•	--	--	•	•	--	--	
Silverado 2500 HD Classic	Crew	07 - 07	Fleetside	8'	--	•	--	•	--	--	--	•	--	•	--	--	--	•	•	--	--	•	•	--	--	
		07 - 07	Fleetside	6' 6"	--	•	--	•	--	--	--	•	--	•	--	--	--	--	•	•	--	--	•	•	--	--
	Standard	07 - 07	Fleetside	8'	--	•	--	•	--	--	--	•	--	•	--	--	--	--	•	•	--	--	•	•	--	--
		07 - 07	Fleetside	6' 6"	--	•	--	•	--	--	--	•	--	•	--	--	--	--	•	•	--	--	•	•	--	--

Footnotes		For the most up-to-date application information please visit uwsta.com	
1 If your model is equipped with a factory, hard-plastic Tonneau System covering the bed rail, a crossover tool box will not fit.	3 If your model is equipped with a factory track-system, standard box-mounting may not apply.	* For Gloss Black, add -B instead of -BLK	
2 If your model is equipped with a Ram Box, a crossover tool box will not fit.	4 If your model is equipped with a factory bed-rail system, standard box-mounting may not apply.	† For Matte Black with rail, use part# SLD69-A-LP-MB-R	



Available ordering options
(listed above part numbers)

All part#s listed are Bright Aluminum. Use key below to identify alternative finishes or to add a rail. Then add desired suffix shown to end of part#.

A - Matte Black (add **-MB**)
B - Aluminum with Rail (add **-R**)
C - Matte Black with Rail (add **-MB-R**)
E - Gloss Black (add **-BLK**)

Secure Lock		Pull Handle		Gull Wing				Slim Line									
Stand.	D.	Stand.	Standard		Deep		Standard		Deep								
A,B,C	A,B,C	A,C†	A,E*	A,E*	--	--	--	--	E	E	E	E*	E	E	E*	E*	
SL-69-LP	SL-72-LP	SLD-69-A-LP	TBS-69-LP-PH	TBS-72-LP-PH	TB-60	TB-63	TB-69	TB-72	TBD-69	TBD-72	TBS-60-SL	TBS-63-SL	TBS-69-SL	TBS-69-SL-LP	TBS-72-SL	TBSD-69-SL	TBSD-69-SL-LP

Make / Model	Cab Length	Years	Bed Style	Bed Length	Foot Notes	SL-69-LP	SL-72-LP	SLD-69-A-LP	TBS-69-LP-PH	TBS-72-LP-PH	TB-60	TB-63	TB-69	TB-72	TBD-69	TBD-72	TBS-60-SL	TBS-63-SL	TBS-69-SL	TBS-69-SL-LP	TBS-72-SL	TBSD-69-SL	TBSD-69-SL-LP	TBSD-69-SL-LP	TBSD-72-SL-LP		
Chevrolet (continued)																											
Silverado 3500	Crew	01 - 06	Fleetside	8'	--	●	--	●	●	--	--	--	●	--	●	--	--	--	●	●	--	●	●	--	●	●	--
	Extended	01 - 06	Fleetside	8'	--	●	--	●	●	--	--	--	●	--	●	--	--	--	●	●	--	●	●	--	●	●	--
	Standard	01 - 06	Fleetside	8'	--	●	--	●	●	--	--	--	●	--	●	--	--	--	●	●	--	●	●	--	●	●	--
Silverado 3500 Classic	Crew	07 - 07	Fleetside	8'	--	●	--	●	●	--	--	--	●	--	●	--	--	--	●	●	--	●	●	--	●	●	--
	Extended	07 - 07	Fleetside	8'	--	●	--	●	●	--	--	--	●	--	●	--	--	--	●	●	--	●	●	--	●	●	--
	Standard	07 - 07	Fleetside	8'	--	●	--	●	●	--	--	--	●	--	●	--	--	--	●	●	--	●	●	--	●	●	--
Silverado 3500 HD	Crew	15 - 19	Fleetside	6' 6"	--	●	--	●	●	--	--	--	●	--	●	--	--	--	●	●	--	●	●	--	●	●	--
		15 - 19	Fleetside	8'	--	●	--	●	●	--	--	--	●	--	●	--	--	--	●	●	--	●	●	--	●	●	--
	Extended	11 - 19	Fleetside	6' 6"	--	●	--	●	●	--	--	--	●	--	●	--	--	--	●	●	--	●	●	--	●	●	--
	Standard	07 - 19	Fleetside	8'	--	●	--	●	●	--	--	--	●	--	●	--	--	--	●	●	--	●	●	--	●	●	--
Dodge																											
Dakota	Extended	09 - 10	Fleetside	5' 6"	--	--	--	--	--	--	--	--	--	--	--	--	--	●	--	--	--	--	--	--	--	--	
		00 - 04	Fleetside	5' 6"	--	--	--	--	--	--	--	--	--	--	--	--	--	--	●	--	--	--	--	--	--	--	--
		97 - 04	Fleetside	6' 6"	--	--	--	--	--	--	●	--	--	--	--	--	--	--	●	--	--	--	--	--	--	--	--
	Standard	00 - 04	Fleetside	5' 6"	--	--	--	--	--	--	--	--	--	--	--	--	--	--	●	--	--	--	--	--	--	--	--
Ram 1500	Crew	09 - 10	Fleetside	5' 7"	--	--	--	--	--	--	--	--	●	--	--	--	--	--	●	●	--	--	--	--	--	--	
		09 - 10	Fleetside	6' 4"	2	●	--	--	●	--	--	--	●	--	●	--	--	--	●	●	--	--	--	--	--	--	
		09 - 10	Fleetside	8'	--	●	--	--	●	--	--	--	●	--	●	--	--	--	●	●	--	--	--	--	--	--	
	Extended	09 - 10	Fleetside	5' 7"	--	--	--	--	--	--	--	--	●	--	--	--	--	--	--	●	●	--	--	--	--	--	
		09 - 10	Fleetside	6' 4"	2	●	--	--	●	--	--	--	●	--	●	--	--	--	--	●	●	--	--	--	--	--	
		09 - 10	Fleetside	8'	--	●	--	--	●	--	--	--	●	--	●	--	--	--	--	●	●	--	--	--	--	--	
	Ext. Crew	06 - 08	Fleetside	6' 6"	--	--	●	--	--	●	--	--	--	●	--	--	--	--	--	--	--	●	--	--	●	--	
		06 - 08	Fleetside	8'	--	--	●	--	--	●	--	--	--	●	--	●	--	--	--	--	--	●	--	--	●	--	
	Standard	09 - 10	Fleetside	5' 7"	--	--	--	--	--	--	--	--	●	--	--	--	--	--	--	●	●	--	--	--	--	--	
		09 - 10	Fleetside	6' 4"	2	--	●	--	--	●	--	--	--	●	--	●	--	--	--	--	--	●	--	--	●	--	
Ram 2500	Crew	03 - 08	Fleetside	6' 6"	--	--	●	--	--	●	--	--	●	--	●	--	--	--	--	--	●	--	--	●	--		
		03 - 08	Fleetside	8'	--	--	●	--	--	●	--	--	●	--	●	--	--	--	--	--	●	--	--	●	--		
	Ext. Crew	06 - 08	Fleetside	6' 6"	--	--	●	--	--	●	--	--	●	--	●	--	--	--	--	--	●	--	--	●	--		
		06 - 08	Fleetside	8'	--	--	●	--	--	●	--	--	●	--	●	--	--	--	--	--	●	--	--	●	--		
	Standard	03 - 08	Fleetside	6' 6"	--	--	●	--	--	●	--	--	●	--	●	--	--	--	--	--	●	--	--	●	--		
Ram 3500	Crew	03 - 08	Fleetside	6' 6"	--	--	●	--	--	●	--	--	●	--	●	--	--	--	--	--	●	--	--	●	--		
		03 - 08	Fleetside	8'	--	--	●	--	--	●	--	--	●	--	●	--	--	--	--	--	●	--	--	●	--		
	Ext. Crew	06 - 08	Fleetside	6' 6"	--	--	●	--	--	●	--	--	●	--	●	--	--	--	--	--	●	--	--	●	--		
		06 - 08	Fleetside	8'	--	--	●	--	--	●	--	--	●	--	●	--	--	--	--	--	●	--	--	●	--		
	Standard	03 - 08	Fleetside	6' 6"	--	--	●	--	--	●	--	--	●	--	●	--	--	--	--	--	●	--	--	●	--		
Ford																											
Explorer Sport Trac	--	07 - 10	Styleside	4' 6"	--	--	--	--	--	--	--	--	--	--	--	--	--	--	--	--	--	--	--	--	--	--	
		01 - 05	Styleside	4' 6"	--	--	--	--	--	--	--	●	--	--	--	--	--	--	●	--	--	--	--	--	--	--	

Footnotes	For the most up-to-date application information please visit uwsta.com
1 If your model is equipped with a factory, hard-plastic Tonneau System covering the bed rail, a crossover tool box will not fit.	3 If your model is equipped with a factory track-system, standard box-mounting may not apply.
2 If your model is equipped with a Ram Box, a crossover tool box will not fit.	4 If your model is equipped with a factory bed-rail system, standard box-mounting may not apply.
	* For Gloss Black, add -B instead of -BLK
	† For Matte Black with rail, use part# SLD69-A-LP-MB-R

	Low Profile														Standard Profile														Extra Wide							
	Standard							Deep							Standard							Deep							Stand.	Deep						
	E	E	E	E	E	A,E	E	A,B,E	E	A,E	E	E	E	E	E	E*	E	E	E	E	E	E	E	A,B,E	A,B,E	E	--	E	E	A,E	E	E	E	E*	E*	
TBS-54-LP																																				
TBS-58-LP																																				
TBS-60-LP																																				
TBS-60-A-LP																																				
TBS-63-LP																																				
TBS-63-A-LP																																				
TBS-66-LP																																				
TBS-69-LP																																				
TBS-69-A-LP																																				
TBS-72-LP																																				
TBSD-60A-LP																																				
TBSD-63A-LP																																				
TBSD-69-LP																																				
TBSD-69-A-LP																																				
TBSD-72-A-LP																																				
TBS-54																																				
TBS-58																																				
TBS-60																																				
TBS-60-A																																				
TBS-63																																				
TBS-63-A																																				
TBS-66																																				
TBS-69																																				
TBS-72																																				
TBSD-60A																																				
TBSD-63																																				
TBSD-63A																																				
TBSD-69																																				
TBSD-69-A																																				
TBSD-72-A																																				
TBS-69-LBTA																																				
TBS-72-LBTA																																				
TBSD-69-LBTA																																				
TBSD-72-LBTA																																				

Footnotes		For the most up-to-date application information please visit uwsta.com	
1	If your model is equipped with a factory, hard-plastic Tonneau System covering the bed rail, a crossover tool box will not fit.	3	If your model is equipped with a factory track-system, standard box-mounting may not apply.
2	If your model is equipped with a Ram Box, a crossover tool box will not fit.	4	If your model is equipped with a factory bed-rail system, standard box-mounting may not apply.
			* For Gloss Black, add -B instead of -BLK
			† For Matte Black with rail, use part# SLD69-A-LP-MB-R



Available ordering options
(listed above part numbers)

All part#s listed are Bright Aluminum.
Use key below to identify alternative finishes or to add a rail. Then add desired suffix shown to end of part#.

- A - Matte Black (add -**MB**)
- B - Aluminum with Rail (add -**R**)
- C - Matte Black with Rail (add -**MB-R**)
- E - Gloss Black (add -**BLK**)

Make / Model	Cab Length	Years	Bed Style	Bed Length	Foot Notes	Secure Lock		Pull Handle		Gull Wing				Slim Line										
						Stand.	D.	Stand.	Standard		Deep	Standard			Deep									
						A,B,C	A,B,C	A,C†	A,E*	A,E*	--	--	--	--	--	--	E	E	E	E*	E	E	E*	E*
						SL-69-LP	SL-72-LP	SLD-69-A-LP	TBS-69-LP-PH	TBS-72-LP-PH	TB-60	TB-63	TB-69	TB-72	TBD-69	TBD-72	TBS-60-SL	TBS-63-SL	TBS-69-SL	TBS-69-SL-LP	TBS-72-SL	TBSD-69-SL	TBSD-69-SL-LP	TBSD-72-SL-LP
F-150	Crew	15 - 19	Styleside	5' 6"	--	●	--	--	●	--	--	●	--	--	●	●	--	●	●	--	●	●	--	
		15 - 19	Styleside	6' 6"	--	●	--	●	--	--	--	●	--	●	--	--	●	●	--	●	●	--	●	●
		09 - 14	Styleside	5' 6"	--	●	--	--	●	--	--	●	--	--	--	●	●	--	●	●	--	●	●	--
		09 - 14	Styleside	6' 6"	--	●	--	●	--	--	--	●	--	--	--	●	●	--	●	●	--	●	●	--
		04 - 08	Styleside	5' 6"	--	--	--	--	--	--	--	●	--	--	--	●	●	--	--	●	●	--	--	--
		01 - 03	Styleside	5'	--	--	--	●	--	--	--	●	--	--	--	●	●	--	--	●	●	--	--	--
		01 - 03	Styleside	6' 6"	--	●	--	●	--	--	--	●	--	●	--	--	●	●	--	●	●	--	●	●
		01 - 08	Styleside	8'	--	●	--	●	--	--	--	●	--	●	--	--	●	●	--	●	●	--	●	●
	Extended	15 - 19	Styleside	6' 6"	--	●	--	●	--	--	--	●	--	●	--	--	●	●	--	●	●	--	●	●
		15 - 19	Styleside	8'	--	●	--	●	--	--	--	●	--	●	--	--	●	●	--	●	●	--	●	●
		09 - 14	Styleside	6' 6"	--	●	--	●	--	--	--	●	--	--	--	●	●	--	●	●	--	●	●	--
		04 - 08	Styleside	6' 6"	--	--	--	●	--	--	--	●	--	--	--	●	●	--	●	●	--	●	●	--
		04 - 08	Flareside	6' 6"	--	--	--	●	--	--	--	●	--	--	--	●	●	--	●	●	--	●	●	--
		04 - 08	Styleside	8'	--	●	--	●	--	--	--	●	--	--	--	●	●	--	●	●	--	●	●	--
		97 - 03	Styleside	6' 6"	--	●	--	●	--	--	--	●	--	--	--	●	●	--	●	●	--	●	●	--
		97 - 03	Flareside	6' 6"	--	--	--	--	--	--	●	--	--	--	--	●	●	--	--	--	--	--	--	--
	Standard	15 - 19	Styleside	6' 6"	--	●	--	●	--	--	--	●	--	●	--	--	●	●	--	●	●	--	●	●
		15 - 19	Styleside	8'	--	●	--	●	--	--	--	●	--	●	--	--	●	●	--	●	●	--	●	●
		09 - 14	Styleside	6' 6"	--	●	--	●	--	--	--	●	--	--	--	●	●	--	●	●	--	●	●	--
		09 - 14	Styleside	8'	--	●	--	●	--	--	--	●	--	●	--	--	●	●	--	●	●	--	●	●
04 - 08		Flareside	6' 6"	--	--	--	●	--	--	--	●	--	--	--	●	●	--	●	●	--	●	●	--	
04 - 08		Styleside	5' 6"	--	--	--	--	--	--	--	●	--	--	--	●	●	--	--	--	--	--	--	--	
04 - 08		Styleside	8'	--	●	--	●	--	--	--	●	--	●	--	--	●	●	--	●	●	--	●	●	
97 - 03		Styleside	6' 6"	--	●	--	●	--	--	--	●	--	●	--	--	●	●	--	●	●	--	●	●	
97 - 03	Flareside	6' 6"	--	--	--	--	--	--	●	--	--	--	--	●	●	--	--	--	--	--	--	--		
97 - 03	Styleside	8'	--	●	--	●	--	--	--	●	--	●	--	--	●	●	--	●	●	--	●	●		
F-150 Heritage	Extended	04 - 04	Styleside	6' 6"	--	●	--	●	--	--	●	--	●	--	--	●	●	--	●	●	--	●	●	
		04 - 04	Styleside	8'	--	●	--	●	--	--	--	●	--	●	--	--	●	●	--	●	●	--	●	●
	Standard	04 - 04	Styleside	6' 6"	--	●	--	●	--	--	--	●	--	●	--	--	●	●	--	●	●	--	●	●
		04 - 04	Flareside	6' 6"	--	--	--	--	--	●	--	--	--	--	●	●	--	--	--	--	--	--	--	--
04 - 04	Styleside	8'	--	●	--	●	--	--	--	●	--	●	--	--	●	●	--	●	●	--	●	●		
F-250 Super Duty	Crew	17 - 19	Styleside	8'	--	--	●	--	--	●	--	--	●	--	●	--	--	●	●	--	●	●	--	
		17 - 19	Styleside	6' 9"	--	--	●	--	--	●	--	--	●	--	●	--	--	●	●	--	●	●	--	●
		11 - 16	Styleside	6' 9"	--	--	--	--	--	●	--	--	--	--	●	●	--	--	●	●	--	--	--	●
		11 - 16	Styleside	8'	--	--	●	--	--	●	--	--	●	--	●	--	--	●	●	--	●	●	--	●
		99 - 10	Styleside	6' 9"	--	--	●	--	--	●	--	--	●	--	●	--	--	●	●	--	●	●	--	●
		99 - 10	Styleside	8'	--	--	●	--	--	●	--	--	●	--	●	--	--	●	●	--	●	●	--	●
	Extended	17 - 19	Styleside	6' 9"	--	--	●	--	--	●	--	--	●	--	●	--	--	●	●	--	●	●	--	●
		17 - 19	Styleside	8'	--	--	●	--	--	●	--	--	●	--	●	--	--	●	●	--	●	●	--	●
		11 - 16	Styleside	6' 9"	--	--	--	--	--	●	--	--	--	--	●	●	--	--	●	●	--	--	--	●
		11 - 16	Styleside	8'	--	--	●	--	--	●	--	--	●	--	●	--	--	●	●	--	●	●	--	●
		99 - 10	Styleside	6' 9"	--	--	●	--	--	●	--	--	●	--	●	--	--	●	●	--	●	●	--	●
		99 - 10	Styleside	8'	--	--	●	--	--	●	--	--	●	--	●	--	--	●	●	--	●	●	--	●
	Standard	17 - 19	Styleside	8'	--	--	●	--	--	●	--	--	●	--	●	--	--	●	●	--	●	●	--	●
		11 - 16	Styleside	6' 9"	--	--	--	--	--	●	--	--	--	--	●	●	--	--	●	●	--	--	--	●
		11 - 16	Styleside	8'	--	--	●	--	--	●	--	--	●	--	●	--	--	●	●	--	●	●	--	●
99 - 10		Styleside	6' 9"	--	--	●	--	--	●	--	--	●	--	●	--	--	●	●	--	●	●	--	●	
99 - 10		Styleside	8'	--	--	●	--	--	●	--	--	●	--	●	--	--	●	●	--	●	●	--	●	

Footnotes		
<p>1 If your model is equipped with a factory, hard-plastic Tonneau System covering the bed rail, a crossover tool box will not fit.</p>	<p>3 If your model is equipped with a factory track-system, standard box-mounting may not apply.</p>	<p>* For Gloss Black, add -B instead of -BLK</p>
<p>2 If your model is equipped with a Ram Box, a crossover tool box will not fit.</p>	<p>4 If your model is equipped with a factory bed-rail system, standard box-mounting may not apply.</p>	<p>† For Matte Black with rail, use part# SLD69-A-LP-MB-R</p>

Available ordering options
 (listed above part numbers)

All part#s listed are Bright Aluminum. Use key below to identify alternative finishes or to add a rail. Then add desired suffix shown to end of part#.

- A - Matte Black (add **-MB**)
- B - Aluminum with Rail (add **-R**)
- C - Matte Black with Rail (add **-MB-R**)
- E - Gloss Black (add **-BLK**)

Make / Model	Cab Length	Years	Bed Style	Bed Length	Foot Notes	Secure Lock		Pull Handle	Gull Wing				Slim Line									
						Stand.	D.	Stand.	Standard		Deep		Standard		Deep							
						A, B, C	A, B, C	A, C†	A, E*	A, E*	--	--	--	--	E	E	E	E*	E	E	E*	E*
SL-69-LP	SL-72-LP	SLD-69-A-LP	TBS-69-LP-PH	TBS-72-LP-PH	TB-60	TB-63	TB-69	TB-72	TBD-69	TBD-72	TBS-60-SL	TBS-63-SL	TBS-69-SL	TBS-69-SL-LP	TBS-72-SL	TBSD-69-SL	TBSD-69-SL-LP	TBSD-72-SL-LP				
Ford (continued)																						
F-350 Super Duty	Crew	17 - 19	Styleside	6' 9"	--	--	●	--	--	●	--	--	--	--	●	--	●	--	●	--	●	
		17 - 19	Styleside	8'	--	--	●	--	●	--	--	--	●	--	●	--	●	--	●	--	●	
		11 - 16	Styleside	6' 9"	--	--	--	--	--	●	--	--	--	--	●	--	--	--	●	--	--	●
		11 - 16	Styleside	8'	--	--	●	--	●	--	--	--	●	--	●	--	●	--	●	--	●	
		99 - 10	Styleside	6' 9"	--	--	●	--	●	--	--	--	●	--	●	--	●	--	●	--	●	
	Extended	17 - 19	Styleside	6' 9"	--	--	●	--	●	--	--	●	--	●	--	●	--	●	--	●	--	●
		17 - 19	Styleside	8'	--	--	●	--	●	--	--	●	--	●	--	●	--	●	--	●	--	●
		11 - 16	Styleside	6' 9"	--	--	--	--	--	●	--	--	--	--	●	--	--	--	●	--	--	●
		11 - 16	Styleside	8'	--	--	●	--	●	--	--	●	--	●	--	●	--	●	--	●	--	●
		99 - 10	Styleside	6' 9"	--	--	●	--	●	--	--	●	--	●	--	●	--	●	--	●	--	●
	Standard	17 - 19	Styleside	8'	--	--	●	--	●	--	--	●	--	●	--	●	--	●	--	●	--	●
		11 - 16	Styleside	6' 9"	--	--	--	--	--	●	--	--	--	●	--	--	--	●	--	--	●	
		11 - 16	Styleside	8'	--	--	●	--	●	--	--	●	--	●	--	●	--	●	--	●	--	●
		99 - 10	Styleside	6' 9"	--	--	●	--	●	--	--	●	--	●	--	●	--	●	--	●	--	●
F-450 Super Duty	Crew	17 - 19	Styleside	8'	--	--	●	--	●	--	--	●	--	●	--	●	--	●	--	●		
		11 - 16	Styleside	8'	--	--	●	--	●	--	--	●	--	●	--	●	--	●	--	●		
	08 - 10	Styleside	8'	--	--	●	--	●	--	--	●	--	●	--	●	--	●	--	●			
Ranger	Extended	06 - 11	Styleside	6'	--	--	--	--	--	●	--	--	--	--	●	--	--	--	--	--	--	
	Standard	98 - 11	Styleside	6'	--	--	--	--	●	--	--	--	--	●	--	--	--	--	--	--	--	
		98 - 09	Styleside	7'	--	--	--	--	●	--	--	--	--	●	--	--	--	--	--	--	--	
GMC																						
Canyon	Crew	19 - 19	Fleetside	5'	--	--	--	--	--	●	--	--	--	--	●	--	--	--	--	--	--	
		15 - 18	Fleetside	5' 6"	--	--	--	--	●	●	--	--	--	●	●	--	--	--	--	--	--	
		15 - 18	Fleetside	6'	--	--	--	--	●	●	--	--	--	●	●	--	--	--	--	--	--	
		04 - 12	Fleetside	5' 5"	--	--	--	--	●	●	--	--	--	●	●	--	--	--	--	--	--	
	Extended	15 - 18	Fleetside	6'	--	--	--	--	●	●	--	--	--	●	●	--	--	--	--	--	--	
Sierra 1500	Standard	04 - 12	Fleetside	6'	--	--	--	--	--	--	--	--	--	--	--	--	--	--	--	--	--	
	Crew	14 - 19	Fleetside	5' 8"	--	●	--	●	●	--	--	●	--	●	--	●	●	--	●	●	--	
14 - 19		Fleetside	6' 6"	--	●	--	●	●	--	--	●	--	●	--	●	●	--	●	●	--		
07 - 13		Fleetside	5' 8"	--	●	--	●	●	--	--	●	--	●	--	●	●	--	●	●	--		
04 - 06		Fleetside	8'	--	●	--	●	●	--	--	●	--	●	--	●	●	--	●	●	--		
99 - 06		Fleetside	5' 8.5"	--	●	--	●	●	--	--	●	--	●	--	●	●	--	●	●	--		
Extended		14 - 19	Fleetside	6' 6"	--	●	--	●	●	--	--	●	--	●	--	●	●	--	●	●	--	
		07 - 13	Fleetside	6' 6"	--	●	--	●	●	--	--	●	--	●	--	●	●	--	●	●	--	
		07 - 13	Fleetside	8'	--	●	--	●	●	--	--	●	--	●	--	●	●	--	●	●	--	
		99 - 05	Stepside	6' 6"	--	--	--	--	--	--	--	--	--	--	--	--	--	--	--	--	--	
		99 - 06	Fleetside	6' 6"	--	●	--	●	●	--	--	●	--	●	--	●	●	--	●	●	--	
Standard		99 - 06	Fleetside	8'	--	●	--	●	●	--	--	●	--	●	--	●	●	--	●	●	--	
	14 - 19	Fleetside	6' 6"	--	●	--	●	●	--	--	●	--	●	--	●	●	--	●	●	--		
	14 - 19	Fleetside	8'	--	●	--	●	●	--	--	●	--	●	--	●	●	--	●	●	--		
	07 - 13	Fleetside	6' 6"	--	●	--	●	●	--	--	●	--	●	--	●	●	--	●	●	--		
	07 - 13	Fleetside	8'	--	●	--	●	●	--	--	●	--	●	--	●	●	--	●	●	--		
	99 - 05	Stepside	6' 6"	--	--	--	--	--	--	--	--	--	--	--	--	--	--	--	--	--		
Sierra 1500 Classic	Crew	07 - 07	Fleetside	5' 8.5"	--	--	--	--	--	●	--	--	●	--	●	●	--	●	●	--		
		07 - 07	Fleetside	8'	--	●	--	●	●	--	--	●	--	●	--	●	●	--	●	●		
	Extended	07 - 07	Fleetside	6' 6"	--	●	--	●	●	--	--	●	--	●	--	●	●	--	●	●		
07 - 07		Fleetside	8'	--	●	--	●	●	--	--	●	--	●	--	●	●	--	●	●			
Standard	07 - 07	Fleetside	6' 6"	--	●	--	●	●	--	--	●	--	●	--	●	●	--	●	●			
	07 - 07	Fleetside	8'	--	●	--	●	●	--	--	●	--	●	--	●	●	--	●	●			

Footnotes		For the most up-to-date application information please visit uwsta.com	
1	If your model is equipped with a factory, hard-plastic Tonneau System covering the bed rail, a crossover tool box will not fit.	3	If your model is equipped with a factory track-system, standard box-mounting may not apply.
2	If your model is equipped with a Ram Box, a crossover tool box will not fit.	4	If your model is equipped with a factory bed-rail system, standard box-mounting may not apply.
		*	For Gloss Black, add -B instead of -BLK
		†	For Matte Black with rail, use part# SLD69-A-LP-MB-R



Available ordering options
(listed above part numbers)

All part#s listed are Bright Aluminum. Use key below to identify alternative finishes or to add a rail. Then add desired suffix shown to end of part#.

- A - Matte Black (add **-MB**)
- B - Aluminum with Rail (add **-R**)
- C - Matte Black with Rail (add **-MB-R**)
- E - Gloss Black (add **-BLK**)

Secure Lock		Pull Handle		Gull Wing				Slim Line										
Stand.	D.	Stand.	Standard		Deep		Standard		Deep									
A,B,C	A,B,C	A,C†	A,E*	A,E*	--	--	--	--	--	E	E	E	E*	E	E	E*	E*	
SL-69-LP	SL-72-LP	SLD-69-A-LP	TBS-69-LP-PH	TBS-72-LP-PH	TB-60	TB-63	TB-69	TB-72	TBD-69	TBD-72	TBS-60-SL	TBS-63-SL	TBS-69-SL	TBS-69-SL-LP	TBS-72-SL	TBSD-69-SL	TBSD-69-SL-LP	TBSD-72-SL-LP

Make / Model	Cab Length	Years	Bed Style	Bed Length	Foot Notes	SL-69-LP	SL-72-LP	SLD-69-A-LP	TBS-69-LP-PH	TBS-72-LP-PH	TB-60	TB-63	TB-69	TB-72	TBD-69	TBD-72	TBS-60-SL	TBS-63-SL	TBS-69-SL	TBS-69-SL-LP	TBS-72-SL	TBSD-69-SL	TBSD-69-SL-LP	TBSD-72-SL-LP
GMC (continued)																								
Sierra 1500 Limited	Extended	19 - 19	Fleetside	6' 6"	--	●	--	●	●	--	--	--	●	--	●	--	--	--	●	●	--	●	●	--
Sierra 2500	Crew	04 - 04	Fleetside	8'	--	●	--	●	●	--	--	--	●	--	●	--	--	--	●	●	--	●	●	--
	Extended	99 - 04	Fleetside	6' 6"	--	●	--	●	●	--	--	--	●	--	●	--	--	--	●	●	--	●	●	--
		99 - 04	Fleetside	8'	--	●	--	●	●	--	--	--	●	--	●	--	--	--	●	●	--	●	●	--
	Standard	99 - 04	Fleetside	6' 6"	--	●	--	●	●	--	--	--	●	--	●	--	--	--	●	●	--	●	●	--
		99 - 04	Fleetside	8'	--	●	--	●	●	--	--	--	●	--	●	--	--	--	●	●	--	●	●	--
Sierra 2500 HD	Crew	15 - 19	Fleetside	6' 6"	--	●	--	●	●	--	--	--	●	--	●	--	--	--	●	●	--	●	●	--
		15 - 19	Fleetside	8'	--	●	--	●	●	--	--	--	●	--	●	--	--	--	●	●	--	●	●	--
		01 - 06	Fleetside	8'	--	●	--	●	●	--	--	--	●	--	●	--	--	--	●	●	--	●	●	--
	Extended	01 - 19	Fleetside	6' 6"	--	●	--	●	●	--	--	--	●	--	●	--	--	--	●	●	--	●	●	--
		01 - 19	Fleetside	8'	--	●	--	●	●	--	--	--	●	--	●	--	--	--	●	●	--	●	●	--
	Standard	01 - 19	Fleetside	8'	--	●	--	●	●	--	--	--	●	--	●	--	--	--	●	●	--	●	●	--
		01 - 06	Fleetside	6' 6"	--	●	--	●	●	--	--	--	●	--	●	--	--	--	●	●	--	●	●	--
Sierra 2500 HD Classic	Crew	07 - 07	Fleetside	8'	--	●	--	●	●	--	--	--	●	--	●	--	--	--	●	●	--	●	●	--
	Extended	07 - 07	Fleetside	6' 6"	--	●	--	●	●	--	--	--	●	--	●	--	--	--	●	●	--	●	●	--
		07 - 07	Fleetside	8'	--	●	--	●	●	--	--	--	●	--	●	--	--	--	●	●	--	●	●	--
	Standard	07 - 07	Fleetside	6' 6"	--	●	--	●	●	--	--	--	●	--	●	--	--	--	●	●	--	●	●	--
		07 - 07	Fleetside	8'	--	●	--	●	●	--	--	--	●	--	●	--	--	--	●	●	--	●	●	--
Sierra 3500	Crew	01 - 06	Fleetside	8'	--	●	--	●	●	--	--	--	●	--	●	--	--	--	●	●	--	●	●	--
	Extended	01 - 06	Fleetside	8'	--	●	--	●	●	--	--	--	●	--	●	--	--	--	●	●	--	●	●	--
	Standard	01 - 06	Fleetside	8'	--	●	--	●	●	--	--	--	●	--	●	--	--	--	●	●	--	●	●	--
Sierra 3500 Classic	Crew	07 - 07	Fleetside	8'	--	●	--	●	●	--	--	--	●	--	●	--	--	--	●	●	--	●	●	--
	Extended	07 - 07	Fleetside	8'	--	●	--	●	●	--	--	--	●	--	●	--	--	--	●	●	--	●	●	--
	Standard	07 - 07	Fleetside	8'	--	●	--	●	●	--	--	--	●	--	●	--	--	--	●	●	--	●	●	--
Sierra 3500 HD	Crew	15 - 19	Fleetside	6' 6"	--	●	--	●	●	--	--	--	●	--	●	--	--	--	●	●	--	●	●	--
		15 - 19	Fleetside	8'	--	●	--	●	●	--	--	--	●	--	●	--	--	--	●	●	--	●	●	--
	Extended	11 - 19	Fleetside	6' 6"	--	●	--	●	●	--	--	--	●	--	●	--	--	--	●	●	--	●	●	--
		07 - 19	Fleetside	8'	--	●	--	●	●	--	--	--	●	--	●	--	--	--	●	●	--	●	●	--
	Standard	07 - 19	Fleetside	8'	--	●	--	●	●	--	--	--	●	--	●	--	--	--	●	●	--	●	●	--
Sonoma	Crew	01 - 04	Fleetside	4' 8"	--	--	--	--	--	--	●	--	--	--	--	--	--	●	--	--	--	--	--	--
	Extended	94 - 03	Fleetside	6'	--	--	--	--	--	--	●	--	--	--	--	--	--	●	--	--	--	--	--	--
	Standard	96 - 03	Stepside	6'	--	--	--	--	--	--	--	--	--	--	--	--	--	--	--	--	--	--	--	--
		94 - 03	Fleetside	6'	--	--	--	--	--	--	●	--	--	--	--	--	--	●	--	--	--	--	--	--
		94 - 03	Fleetside	7' 6"	--	--	--	--	--	--	●	--	--	--	--	--	--	●	--	--	--	--	--	--

Honda																								
Ridgeline	Crew	12 - 14	Fleetside	5'	--	--	--	--	--	--	●	--	--	--	--	--	●	--	--	--	--	--	--	--
		06 - 14	Fleetside	5'	--	--	--	--	--	--	●	--	--	--	--	--	●	--	--	--	--	--	--	--

Hummer																								
H3T	Crew	09 - 10	Styleside	5' 5"	3	--	--	--	--	--	●	--	--	--	--	--	●	--	--	--	--	--	--	--

Lincoln																								
Mark LT	Crew	06 - 08	Styleside	5' 6"	--	--	--	--	--	--	--	●	--	--	--	--	--	●	●	--	--	--	--	--

Mazda																								
B2300	Extended	03 - 04	Styleside	6'	--	--	--	--	--	--	●	--	--	--	--	--	--	●	--	--	--	--	--	--
	Standard	01 - 09	Styleside	6'	--	--	--	--	--	--	●	--	--	--	--	--	--	●	--	--	--	--	--	--
B2500	Extended	00 - 00	Styleside	6'	--	--	--	--	--	--	●	--	--	--	--	--	--	●	--	--	--	--	--	--
		98 - 99	Styleside	6'	--	--	--	--	--	--	●	--	--	--	--	--	--	●	--	--	--	--	--	--
	Standard	00 - 01	Styleside	6'	--	--	--	--	--	--	●	--	--	--	--	--	--	●	--	--	--	--	--	--
		98 - 99	Styleside	6'	--	--	--	--	--	--	●	--	--	--	--	--	--	●	--	--	--	--	--	--
B3000	Extended	00 - 07	Styleside	6'	--	--	--	--	--	--	●	--	--	--	--	--	--	●	--	--	--	--	--	--
		99 - 99	Styleside	6'	--	--	--	--	--	--	●	--	--	--	--	--	--	●	--	--	--	--	--	--
	Standard	00 - 07	Styleside	6'	--	--	--	--	--	--	●	--	--	--	--	--	--	●	--	--	--	--	--	--
		98 - 98	Styleside	6'	--	--	--	--	--	--	●	--	--	--	--	--	--	●	--	--	--	--	--	--
B4000	Extended	00 - 09	Styleside	6'	--	--	--	--	--	--	●	--	--	--	--	--	--	●	--	--	--	--	--	--

Footnotes	For the most up-to-date application information please visit uwsta.com
1 If your model is equipped with a factory, hard-plastic Tonneau System covering the bed rail, a crossover tool box will not fit.	3 If your model is equipped with a factory track-system, standard box-mounting may not apply.
2 If your model is equipped with a Ram Box, a crossover tool box will not fit.	4 If your model is equipped with a factory bed-rail system, standard box-mounting may not apply.
	* For Gloss Black, add -B instead of -BLK
	† For Matte Black with rail, use part# SLD69-A-LP-MB-R



Available ordering options
(listed above part numbers)

All part#s listed are Bright Aluminum. Use key below to identify alternative finishes or to add a rail. Then add desired suffix shown to end of part#.

A - Matte Black (add **-MB**)
B - Aluminum with Rail (add **-R**)
C - Matte Black with Rail (add **-MB-R**)
E - Gloss Black (add **-BLK**)

Make / Model	Cab Length	Years	Bed Style	Bed Length	Foot Notes	Secure Lock		Pull Handle		Gull Wing				Slim Line									
						Stand.		Stand.		Standard		Deep		Standard		Deep							
						A,B,C	A,B,C	D.	A,C†	A,E*	A,E*	--	--	--	--	--	--	E	E	E	E*	E	E
SL-69-LP	SL-72-LP	SLD-69-A-LP	TBS-69-LP-PH	TBS-72-LP-PH	TB-60	TB-63	TB-69	TB-72	TBD-69	TBD-72	TBS-60-SL	TBS-63-SL	TBS-69-SL	TBS-69-SL-LP	TBS-72-SL	TBSD-69-SL	TBSD-69-SL-LP	TBSD-72-SL-LP					
Mitsubishi																							
Raider	Extended	06 - 09	Styleside	5' 6"	--	--	--	--	--	--	--	--	--	--	--	--	●	--	--	--	--		
Nissan																							
Frontier	Crew	05 - 19	Styleside	5'	--	--	--	--	--	--	●	--	--	--	--	--	●	--	--	--	--		
		05 - 19	Styleside	6'	--	--	--	--	--	--	●	--	--	--	--	--	--	●	--	--	--	--	
		00 - 04	Styleside	5'	--	--	--	--	--	--	--	--	--	--	--	--	--	●	--	--	--	--	
		00 - 04	Styleside	6' 6"	--	--	--	--	--	--	--	--	--	--	--	--	--	●	--	--	--	--	
	Extended	05 - 19	Styleside	6'	--	--	--	--	--	--	●	--	--	--	--	--	--	●	--	--	--	--	
		98 - 04	Styleside	6' 6"	--	--	--	--	--	--	--	--	--	--	--	--	--	●	--	--	--	--	
Standard	98 - 01	Styleside	6' 6"	--	--	--	--	--	--	--	--	--	--	--	--	●	--	--	--	--	--		
Titan	Crew	17 - 19	Styleside	6' 6"	--	--	--	--	--	--	--	--	--	--	--	--	--	--	--	--	--		
		04 - 15	Styleside	5' 6"	--	●	--	●	--	--	--	●	--	--	--	--	--	●	●	--	●	--	
	Extended	04 - 15	Styleside	6' 6"	--	●	--	●	●	--	--	●	--	●	--	--	--	●	●	--	●	●	
		08 - 14	Styleside	7'	--	●	--	●	●	--	--	●	--	●	--	--	--	●	●	--	●	●	
		08 - 09	Styleside	8'	--	●	--	●	●	--	--	●	--	--	--	--	●	●	--	●	●		
Titan XD	Crew	16 - 19	Styleside	6' 6"	--	--	--	--	--	--	--	--	--	--	--	--	--	--	--	--	--		
Ram																							
1500	Crew	19 - 19	Fleetside	5' 7"	--	●	--	●	--	--	●	--	--	--	--	--	●	--	--	●	●		
		Extended	19 - 19	Fleetside	5' 7"	--	●	--	●	--	--	●	--	--	--	--	--	●	--	--	●	●	
	Standard	11 - 18	Fleetside	5' 7"	--	--	--	--	--	--	●	--	--	--	--	--	--	●	●	--	--	--	
		11 - 18	Fleetside	6' 4"	2	--	●	--	●	--	--	●	--	●	--	●	--	--	--	●	--	●	
		11 - 18	Fleetside	6' 4"	2	--	●	--	●	--	--	●	--	●	--	●	--	--	--	●	--	●	
		11 - 18	Fleetside	8'	--	●	--	●	--	--	●	--	●	--	●	--	--	--	●	--	●		
1500 Classic	Extended	19 - 19	Fleetside	5' 7"	--	--	--	--	--	--	●	--	--	--	--	--	●	●	--	--	--		
		19 - 19	Fleetside	6' 4"	2	--	●	--	●	--	--	●	--	●	--	●	--	--	--	●	--	●	
	Standard	19 - 19	Fleetside	6' 4"	2	--	●	--	●	--	--	●	--	●	--	●	--	--	--	●	--	●	
19 - 19		Fleetside	8'	--	--	●	--	●	--	--	●	--	●	--	●	--	--	--	●	--	●		
2500 / 3500	Crew	11 - 19	Fleetside	6' 4"	2	--	●	--	●	--	--	●	--	●	--	--	--	●	--	--	●		
		11 - 19	Fleetside	8'	--	--	●	--	●	--	--	●	--	●	--	●	--	--	--	●	--	●	
	Ext. Crew	11 - 19	Fleetside	6' 4"	2	--	●	--	●	--	--	●	--	●	--	●	--	--	--	●	--	●	
		11 - 19	Fleetside	8'	--	--	●	--	●	--	--	●	--	●	--	●	--	--	--	●	--	●	
	Standard	11 - 19	Fleetside	6' 4"	2	--	●	--	●	--	--	●	--	●	--	●	--	--	--	●	--	●	
11 - 19		Fleetside	8'	--	--	●	--	●	--	--	●	--	●	--	●	--	--	--	●	--	●		
Dakota	Extended	11 - 11	Fleetside	5' 6"	--	--	--	--	--	--	--	--	--	--	--	●	--	--	--	--	--		
Suzuki																							
Equator	Crew	09 - 12	Styleside	5'	--	--	--	--	--	--	●	--	--	--	--	--	●	--	--	--	--		
		09 - 12	Styleside	6'	--	--	--	--	--	--	●	--	--	--	--	--	--	●	--	--	--	--	
Toyota																							
Tacoma	Crew	19 - 19	Fleetside	5'	4	--	--	--	--	--	●	--	--	--	--	●	--	--	--	--	--		
		05 - 15	Fleetside	5'	4	--	--	--	--	--	--	--	--	--	--	--	--	●	--	--	--	--	
		05 - 15	Fleetside	6'	4	--	--	--	--	--	--	--	--	--	--	--	--	●	--	--	--	--	
	Extended	05 - 15	Fleetside	6'	4	--	--	--	--	--	--	--	--	--	--	--	--	●	--	--	--	--	
		Standard	05 - 14	Fleetside	6'	4	--	--	--	--	--	--	--	--	--	--	--	--	●	--	--	--	--
			96 - 04	Fleetside	6' 5"	--	--	--	--	--	--	--	--	--	--	--	--	●	--	--	--	--	--
Tundra	Crew	07 - 19	Fleetside	6' 6"	--	●	--	●	--	--	●	--	●	--	--	--	●	●	--	●	--		
		07 - 19	Fleetside	8'	--	●	--	●	●	--	--	●	--	●	--	--	--	●	●	--	●	●	
	Extended	00 - 06	Fleetside	6' 5"	--	--	--	--	--	--	--	--	--	--	--	--	--	--	--	--	--	--	
		Ext. Crew	07 - 19	Fleetside	5' 5"	--	●	--	●	--	--	●	--	●	--	--	--	--	●	●	--	●	--
	Standard		07 - 17	Fleetside	6' 6"	--	●	--	●	--	--	●	--	●	--	--	--	--	●	●	--	●	--
		07 - 17	Fleetside	8'	--	●	--	●	●	--	--	●	--	●	--	--	--	●	●	--	●	●	
		00 - 04	Fleetside	6' 5"	--	--	--	--	--	--	--	--	--	--	--	--	--	--	--	--	--	--	
		00 - 06	Fleetside	8'	--	--	--	--	--	--	--	--	--	--	--	--	--	--	--	--	--	--	

Footnotes	For the most up-to-date application information please visit uwsta.com	
1 If your model is equipped with a factory, hard-plastic Tonneau System covering the bed rail, a crossover tool box will not fit.	3 If your model is equipped with a factory track-system, standard box-mounting may not apply.	* For Gloss Black, add -B instead of -BLK
2 If your model is equipped with a Ram Box, a crossover tool box will not fit.	4 If your model is equipped with a Ram bed-rail system, standard box-mounting may not apply.	† For Matte Black with rail, use part# SLD69-A-LP-MB-R



UTILITY CHEST BOXES

SECURE, ACCESSIBLE STORAGE

UWS utility chest boxes are perfect for keeping equipment and other cargo secure and on-hand in the bed of a truck, in the shop, at home or on the job. Each features our patented RigidCore™ foam-filled lid and extra-thick aluminum build for maximum structural strength. New for 2019, we are introducing an under tonneau chest box with our Secure Lock handle system. We continue to offer our standard chests, trailer tongue boxes, 5th wheel boxes and much more.



FEATURED PRODUCTS



Under tonneau boxes

These new utility chests are built with a 16-1/2" height and an offset lid to be compatible with most truck bed tonneau covers.



5th wheel boxes

These low-profile boxes are engineered to fit in the truck bed with a 5th wheel hitch while towing a 5th wheel trailer without obstruction.



Trailer tongue boxes

Perfect for equipment and trailer accessories, these boxes mount onto the trailer tongue on both straight-tongue and A-frame trailers.

PRODUCT INDEX



38

Under Tonneau
Chest Boxes

Made in USA



40

Notched
Chest Boxes

Made in USA



42

Wedged
Chest Boxes

Made in USA



50

5th Wheel
Chest Boxes

Made in USA



52

Standard
Chest Boxes

Made in USA



54

Trailer Tongue
Chest Boxes

Made in USA



56

Tote
Boxes

Made in USA



56

Foot
Lockers

Made in USA

SECURE LOCK UNDER TONNEAU CHEST BOXES

NEW

KEY FEATURES

16-1/2" high profile with offset lid to be compatible with most tonneau covers

Patented RigidCore™ foam-filled lid to maximize strength and prevent binding



Product Details

- 0.058" extra-thick, one-piece aluminum tub holds heavy tools and cargo
- Easy-to-operate, dual-locking twist handles for enhanced security
- Connecting rod allows for convenient operation from driver or passenger side
- Interior rod enclosure helps prevent bending and jamming of lock system
- MicroSeal™ gasket helps seal out moisture, dust and dirt
- Lid self-opens to 90 degrees for convenient operation and loading (may be limited by tonneau cover style)



SLC-48

SLC-48-MB

Finishes & Materials



Finish:
Bright aluminum
Material:
Aluminum alloy



Finish:
Matte black
Material:
Aluminum alloy

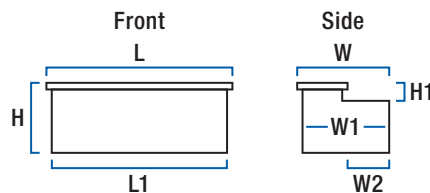

Secure Lock Under Tonneau Chest Boxes

Part#	Finish	Cubic Feet	Dimensions (inches)						
			L	L1	W	W1	W2	H	H1
SLC-48	Bright aluminum	8.85	47.8125	47	24.375	24	9.6875	16.3125	3.6875
SLC-48-MB	Matte black	8.85	47.8125	47	24.375	24	9.6875	16.3125	3.6875



NOTCHED CHEST BOXES



KEY FEATURES

Designed to optimize capacity while avoiding wheel wells and bed accessories

Offers highly secure storage for tools, equipment or personal items

Product Details

- 0.058" extra-thick, one-piece aluminum tub holds heavy tools and cargo
- Stainless steel lock handles for security and corrosion-resistant operation
- Connecting rod allows for convenient operation from driver or passenger side
- Interior rod enclosure helps prevent bending or jamming of lock system
- MicroSeal™ gasket helps seal out moisture, dust and dirt
- Lid self-opens to 90 degrees for convenient operation and loading

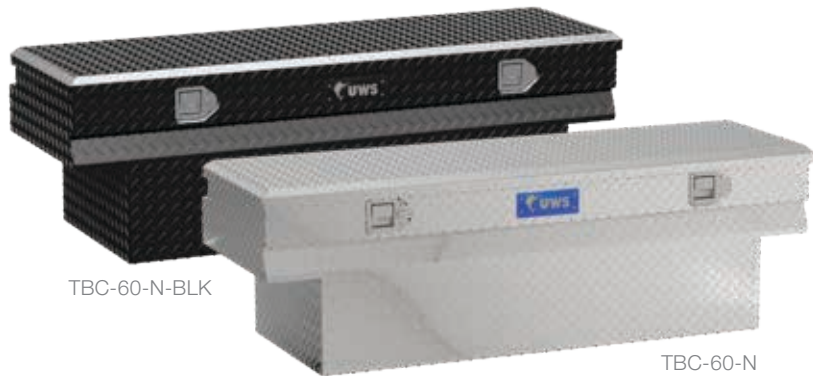

Finishes & Materials



Finish:
Bright aluminum

Material:
Aluminum alloy



Finish:
Gloss black

Material:
Aluminum alloy

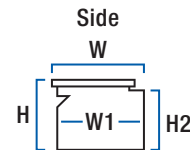
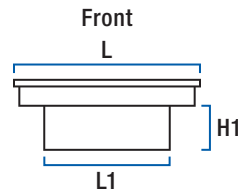

Notched Chest Boxes

Part#	Finish	Cubic Feet	Dimensions (inches)						
			L	L1	W	W1	H	H1	H2
TBC-60-N	Bright aluminum	10.3	59.8125	48	19.875	19.375	18.75	9.75	14.625
TBC-60-N-BLK	Gloss black	10.3	59.8125	48	19.875	19.375	18.75	9.75	14.625



WEDGED CHEST BOXES



KEY FEATURES

Wedge design optimizes capacity while avoiding wheel wells and bed accessories

Patented RigidCore™ foam-filled lid to maximize strength and prevent binding

Product Details

- 0.058" extra-thick, one-piece aluminum tub holds heavy tools and cargo
- Stainless steel lock handles for security and corrosion-resistant operation
- Connecting rod allows for convenient operation from driver or passenger side
- Interior rod enclosure helps prevent bending or jamming of lock system
- MicroSeal™ gasket helps seal out moisture, dust and dirt
- Lid self-opens to 90 degrees for convenient operation and loading
- Multiple box sizes available for a custom fit on each truck application
- [See page 44 for application information](#)



TBC-55-WN

TBC-36-W-BLK

Finishes & Materials



Finish:
Bright
aluminum

Material:
Aluminum
alloy



Finish:
Gloss
black

Material:
Aluminum
alloy

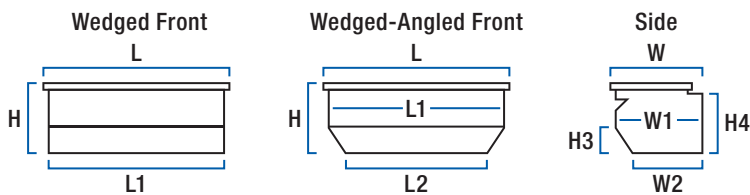
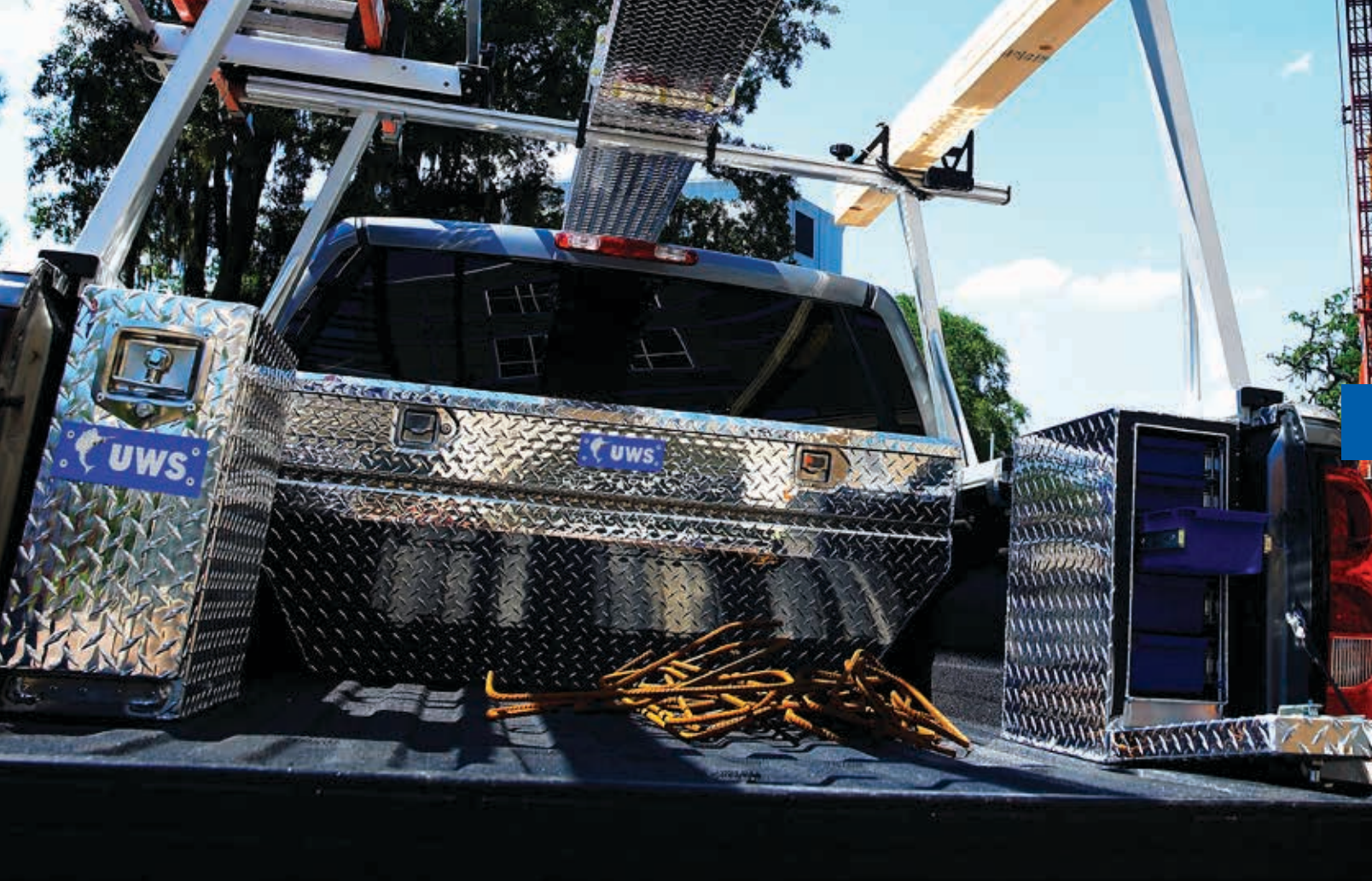

Wedged Chest Boxes

Part#	Finish	Angled	Cubic Feet	Dimensions (inches)								
				L	L1	L2	W	W1	W2	H	H3	H4
TBC-36-W	Bright aluminum	No	7.2	36.875	36	--	20.375	20	17.625	18.5	7.3125	14.3125
TBC-36-W-BLK	Gloss black	No	7.2	36.875	36	--	20.375	20	17.625	18.5	7.3125	14.3125
TBC-42-W	Bright aluminum	No	8.4	42.875	42	--	20.375	20	17.625	18.5	7.3125	14.3125
TBC-42-W-BLK	Gloss black	No	8.4	42.875	42	--	20.375	20	17.625	18.5	7.3125	14.3125
TBC-48-W	Bright aluminum	No	9.6	48.875	48	--	20.375	20	17.625	18.5	7.3125	14.3125
TBC-48-W-BLK	Gloss black	No	9.6	48.875	48	--	20.375	20	17.625	18.5	7.3125	14.3125
TBC-55-W	Bright aluminum	No	11	54.875	54	--	20.375	20	17.625	18.5	7.3125	14.3125
TBC-55-W-BLK	Gloss black	No	11	54.875	54	--	20.375	20	17.625	18.5	7.3125	14.3125
TBC-55-WN	Bright aluminum	Yes	10.4	55.875	55	41	22	21.4375	17.5	20.8125	10.5	15.1875
TBC-55-WN-BLK	Gloss black	Yes	10.4	55.875	55	41	22	21.4375	17.5	20.8125	10.5	15.1875
TBC-60-W	Bright aluminum	No	12	60.875	60	--	20.375	20	17.625	18.5	7.3125	14.3125
TBC-60-W-BLK	Gloss black	No	12	60.875	60	--	20.375	20	17.625	18.5	7.3125	14.3125
TBC-62-WN	Bright aluminum	Yes	10.8	62.875	62	53.875	21.375	21	15.5625	18.5	8.75	13
TBC-62-WN-BLK	Gloss black	Yes	10.8	62.875	62	53.875	21.375	21	15.5625	18.5	8.75	13

APPLICATION GUIDE

Wedge Chest Boxes						
Make / Model	Cab Length	Years	Bed Style	Bed Length	Bright Aluminum#	Gloss Black#
Cadillac						
Escalade EXT	Crew	07 - 12	Fleetside	5'	TBC-48-W	TBC-48-W-BLK
		02 - 06	Fleetside	5'	TBC-48-W	TBC-48-W-BLK
Chevrolet						
Avalanche	Crew	07 - 12	Fleetside	5'	TBC-48-W	TBC-48-W-BLK
Avalanche 1500	Crew	02 - 06	Fleetside	5'	TBC-48-W	TBC-48-W-BLK
Avalanche 2500	Crew	02 - 06	Fleetside	5'	TBC-48-W	TBC-48-W-BLK
Colorado	Crew	19 - 19	Fleetside	5'	TBC-42-W	TBC-42-W-BLK
		15 - 18	Fleetside	5' 6"	TBC-36-W	TBC-36-W-BLK
		15 - 18	Fleetside	6'	TBC-36-W	TBC-36-W-BLK
		04 - 12	Styleside	5' 5"	TBC-36-W	TBC-36-W-BLK
		04 - 12	Styleside	6'	TBC-36-W	TBC-36-W-BLK
	Extended	15 - 18	Fleetside	6'	TBC-36-W	TBC-36-W-BLK
	Standard	04 - 12	Styleside	6'	TBC-36-W	TBC-36-W-BLK
Silverado 1500	Crew	14 - 19	Fleetside	5' 8"	TBC-55-WN	TBC-55-WN-BLK
		14 - 19	Fleetside	6' 6"	TBC-62-WN	TBC-62-WN-BLK
		07 - 13	Fleetside	5' 8"	TBC-55-WN	TBC-55-WN-BLK
		04 - 06	Fleetside	8'	TBC-62-WN	TBC-62-WN-BLK
		99 - 06	Fleetside	5' 8.5"	TBC-55-WN	TBC-55-WN-BLK
	Extended	14 - 19	Fleetside	6' 6"	TBC-62-WN	TBC-62-WN-BLK
		07 - 13	Fleetside	6' 6"	TBC-62-WN	TBC-62-WN-BLK
		07 - 13	Fleetside	8'	TBC-62-WN	TBC-62-WN-BLK
		99 - 05	Stepside	6' 6"	TBC-48-W	TBC-48-W-BLK
		99 - 06	Fleetside	6' 6"	TBC-62-WN	TBC-62-WN-BLK
	Standard	99 - 06	Fleetside	8'	TBC-62-WN	TBC-62-WN-BLK
		14 - 19	Fleetside	6' 6"	TBC-62-WN	TBC-62-WN-BLK
		14 - 19	Fleetside	8'	TBC-62-WN	TBC-62-WN-BLK
		07 - 13	Fleetside	6' 6"	TBC-62-WN	TBC-62-WN-BLK
		07 - 13	Fleetside	8'	TBC-62-WN	TBC-62-WN-BLK
		99 - 05	Stepside	6' 6"	TBC-48-W	TBC-48-W-BLK
		99 - 06	Fleetside	6' 6"	TBC-62-WN	TBC-62-WN-BLK
Silverado 1500 Classic	Crew	07 - 07	Fleetside	5' 8.5"	TBC-55-WN	TBC-55-WN-BLK
		07 - 07	Fleetside	8'	TBC-62-WN	TBC-62-WN-BLK
	Extended	07 - 07	Fleetside	6' 6"	TBC-62-WN	TBC-62-WN-BLK
		07 - 07	Fleetside	8'	TBC-62-WN	TBC-62-WN-BLK
	Standard	07 - 07	Fleetside	6' 6"	TBC-62-WN	TBC-62-WN-BLK
Silverado 1500 Legacy	Extended	19 - 19	Fleetside	6' 6"	TBC-62-WN	TBC-62-WN-BLK
		07 - 07	Fleetside	8'	TBC-62-WN	TBC-62-WN-BLK
Silverado 2500	Crew	04 - 04	Fleetside	8'	TBC-62-WN	TBC-62-WN-BLK
		99 - 04	Fleetside	6' 6"	TBC-62-WN	TBC-62-WN-BLK
	Extended	99 - 04	Fleetside	8'	TBC-62-WN	TBC-62-WN-BLK
		99 - 04	Fleetside	8'	TBC-62-WN	TBC-62-WN-BLK
Silverado 2500 HD	Crew	99 - 04	Fleetside	6' 6"	TBC-62-WN	TBC-62-WN-BLK
		99 - 04	Fleetside	8'	TBC-62-WN	TBC-62-WN-BLK
		01 - 06	Fleetside	8'	TBC-62-WN	TBC-62-WN-BLK

Applications continued on the following page

Wedged Chest Boxes

Make / Model	Cab Length	Years	Bed Style	Bed Length	Bright Aluminum#	Gloss Black#
Chevrolet (continued)						
Silverado 2500 HD	Extended	01 - 19	Fleetside	6' 6"	TBC-62-WN	TBC-62-WN-BLK
		01 - 19	Fleetside	8'	TBC-62-WN	TBC-62-WN-BLK
	Standard	01 - 06	Fleetside	6' 6"	TBC-62-WN	TBC-62-WN-BLK
		01 - 19	Fleetside	8'	TBC-62-WN	TBC-62-WN-BLK
Silverado 2500 HD Classic	Crew	07 - 07	Fleetside	8'	TBC-62-WN	TBC-62-WN-BLK
	Extended	07 - 07	Fleetside	6' 6"	TBC-62-WN	TBC-62-WN-BLK
		07 - 07	Fleetside	8'	TBC-62-WN	TBC-62-WN-BLK
	Standard	07 - 07	Fleetside	6' 6"	TBC-62-WN	TBC-62-WN-BLK
07 - 07		Fleetside	8'	TBC-62-WN	TBC-62-WN-BLK	
Silverado 3500	Crew	01 - 06	Fleetside	8'	TBC-62-WN	TBC-62-WN-BLK
	Extended	01 - 06	Fleetside	8'	TBC-62-WN	TBC-62-WN-BLK
	Standard	01 - 06	Fleetside	8'	TBC-62-WN	TBC-62-WN-BLK
Silverado 3500 Classic	Crew	07 - 07	Fleetside	8'	TBC-62-WN	TBC-62-WN-BLK
	Extended	07 - 07	Fleetside	8'	TBC-62-WN	TBC-62-WN-BLK
	Standard	07 - 07	Fleetside	8'	TBC-62-WN	TBC-62-WN-BLK
Silverado 3500 HD	Crew	15 - 19	Fleetside	6' 6"	TBC-62-WN	TBC-62-WN-BLK
		15 - 19	Fleetside	8'	TBC-62-WN	TBC-62-WN-BLK
	Extended	11 - 19	Fleetside	6' 6"	TBC-62-WN	TBC-62-WN-BLK
		07 - 19	Fleetside	8'	TBC-62-WN	TBC-62-WN-BLK
	Standard	07 - 19	Fleetside	8'	TBC-62-WN	TBC-62-WN-BLK
Dodge						
Dakota	Extended	09 - 10	Fleetside	5' 6"	TBC-42-W	TBC-42-W-BLK
		00 - 04	Fleetside	5' 6"	TBC-42-W	TBC-42-W-BLK
	Standard	00 - 04	Fleetside	5' 6"	TBC-42-W	TBC-42-W-BLK
Ram 1500	Crew	09 - 10	Fleetside	5' 7"	TBC-55-WN	TBC-55-WN-BLK
		09 - 10	Fleetside	6' 4"	TBC-55-WN	TBC-55-WN-BLK
		09 - 10	Fleetside	8'	TBC-62-WN	TBC-62-WN-BLK
	Extended	09 - 10	Fleetside	5' 7"	TBC-55-WN	TBC-55-WN-BLK
		09 - 10	Fleetside	6' 4"	TBC-55-WN	TBC-55-WN-BLK
		09 - 10	Fleetside	8'	TBC-62-WN	TBC-62-WN-BLK
	Extended Crew	06 - 08	Fleetside	6' 6"	TBC-55-WN	TBC-55-WN-BLK
		06 - 08	Fleetside	8'	TBC-62-WN	TBC-62-WN-BLK
	Standard	09 - 10	Fleetside	5' 7"	TBC-55-WN	TBC-55-WN-BLK
		09 - 10	Fleetside	6' 4"	TBC-55-WN	TBC-55-WN-BLK
		09 - 10	Fleetside	8'	TBC-62-WN	TBC-62-WN-BLK
		02 - 08	Fleetside	6' 6"	TBC-55-WN	TBC-55-WN-BLK
02 - 08		Fleetside	8'	TBC-62-WN	TBC-62-WN-BLK	
Ram 2500	Crew	03 - 08	Fleetside	6' 6"	TBC-62-WN	TBC-62-WN-BLK
		03 - 08	Fleetside	8'	TBC-62-WN	TBC-62-WN-BLK
	Extended Crew	06 - 08	Fleetside	6' 6"	TBC-62-WN	TBC-62-WN-BLK
		06 - 08	Fleetside	8'	TBC-62-WN	TBC-62-WN-BLK
	Standard	03 - 08	Fleetside	6' 6"	TBC-62-WN	TBC-62-WN-BLK
03 - 08		Fleetside	8'	TBC-62-WN	TBC-62-WN-BLK	
Ram 3500	Crew	03 - 08	Fleetside	6' 6"	TBC-62-WN	TBC-62-WN-BLK
		03 - 08	Fleetside	8'	TBC-62-WN	TBC-62-WN-BLK
	Extended Crew	06 - 08	Fleetside	6' 6"	TBC-62-WN	TBC-62-WN-BLK
		06 - 08	Fleetside	8'	TBC-62-WN	TBC-62-WN-BLK
	Standard	03 - 08	Fleetside	6' 6"	TBC-62-WN	TBC-62-WN-BLK
03 - 08		Fleetside	8'	TBC-62-WN	TBC-62-WN-BLK	

Applications continued on the following page

Wedged Chest Boxes

Make / Model	Cab Length	Years	Bed Style	Bed Length	Bright Aluminum#	Gloss Black#	
Ford							
Explorer Sport Trac	--	07 - 10	Styleside	4' 6"	TBC-42-W	TBC-42-W-BLK	
		01 - 05	Styleside	4' 6"	TBC-36-W	TBC-36-W-BLK	
F-150	Crew	15 - 19	Styleside	5' 6"	TBC-55-WN	TBC-55-WN-BLK	
		15 - 19	Styleside	6' 6"	TBC-55-WN	TBC-55-WN-BLK	
		09 - 14	Styleside	5' 6"	TBC-55-WN	TBC-55-WN-BLK	
		09 - 14	Styleside	6' 6"	TBC-55-WN	TBC-55-WN-BLK	
		04 - 08	Styleside	5' 6"	TBC-55-WN	TBC-55-WN-BLK	
		01 - 03	Styleside	5'	TBC-55-WN	TBC-55-WN-BLK	
		01 - 03	Styleside	6' 6"	TBC-55-WN	TBC-55-WN-BLK	
		01 - 08	Styleside	8'	TBC-55-WN	TBC-55-WN-BLK	
	Extended	15 - 19	Styleside	6' 6"	TBC-55-WN	TBC-55-WN-BLK	
		15 - 19	Styleside	8'	TBC-55-WN	TBC-55-WN-BLK	
		09 - 14	Styleside	6' 6"	TBC-55-WN	TBC-55-WN-BLK	
		04 - 08	Styleside	6' 6"	TBC-55-WN	TBC-55-WN-BLK	
		04 - 08	Flareside	6' 6"	TBC-55-WN	TBC-55-WN-BLK	
		04 - 08	Styleside	8'	TBC-55-WN	TBC-55-WN-BLK	
		97 - 03	Styleside	6' 6"	TBC-55-WN	TBC-55-WN-BLK	
		97 - 03	Flareside	6' 6"	TBC-55-WN	TBC-55-WN-BLK	
		97 - 03	Styleside	8'	TBC-55-WN	TBC-55-WN-BLK	
		Standard	15 - 19	Styleside	6' 6"	TBC-55-WN	TBC-55-WN-BLK
			15 - 19	Styleside	8'	TBC-55-WN	TBC-55-WN-BLK
			09 - 14	Styleside	6' 6"	TBC-55-WN	TBC-55-WN-BLK
	09 - 14		Styleside	8'	TBC-55-WN	TBC-55-WN-BLK	
	04 - 08		Flareside	6' 6"	TBC-55-WN	TBC-55-WN-BLK	
	04 - 08		Styleside	5' 6"	TBC-48-W	TBC-48-W-BLK	
	04 - 08		Styleside	8'	TBC-55-WN	TBC-55-WN-BLK	
	97 - 03		Styleside	6' 6"	TBC-55-WN	TBC-55-WN-BLK	
	97 - 03		Flareside	6' 6"	TBC-55-WN	TBC-55-WN-BLK	
	97 - 03		Styleside	8'	TBC-55-WN	TBC-55-WN-BLK	
	F-150 Heritage	Extended	04 - 04	Styleside	6' 6"	TBC-55-WN	TBC-55-WN-BLK
			04 - 04	Styleside	8'	TBC-55-WN	TBC-55-WN-BLK
		Standard	04 - 04	Styleside	6' 6"	TBC-55-WN	TBC-55-WN-BLK
04 - 04			Flareside	6' 6"	TBC-55-WN	TBC-55-WN-BLK	
04 - 04			Styleside	8'	TBC-55-WN	TBC-55-WN-BLK	
F-250 Super Duty	Crew	17 - 19	Styleside	8'	TBC-62-WN	TBC-62-WN-BLK	
		17 - 19	Styleside	6' 9"	TBC-62-WN	TBC-62-WN-BLK	
		11 - 16	Styleside	6' 9"	TBC-62-WN	TBC-62-WN-BLK	
		11 - 16	Styleside	8'	TBC-62-WN	TBC-62-WN-BLK	
		99 - 10	Styleside	6' 9"	TBC-62-WN	TBC-62-WN-BLK	
		99 - 10	Styleside	8'	TBC-62-WN	TBC-62-WN-BLK	
	Extended	17 - 19	Styleside	6' 9"	TBC-62-WN	TBC-62-WN-BLK	
		17 - 19	Styleside	8'	TBC-62-WN	TBC-62-WN-BLK	
		11 - 16	Styleside	6' 9"	TBC-62-WN	TBC-62-WN-BLK	
		11 - 16	Styleside	8'	TBC-62-WN	TBC-62-WN-BLK	
		99 - 10	Styleside	6' 9"	TBC-62-WN	TBC-62-WN-BLK	
		99 - 10	Styleside	8'	TBC-62-WN	TBC-62-WN-BLK	
	Standard	17 - 19	Styleside	8'	TBC-62-WN	TBC-62-WN-BLK	
		11 - 16	Styleside	6' 9"	TBC-62-WN	TBC-62-WN-BLK	
		11 - 16	Styleside	8'	TBC-62-WN	TBC-62-WN-BLK	
		99 - 10	Styleside	6' 9"	TBC-62-WN	TBC-62-WN-BLK	
		99 - 10	Styleside	8'	TBC-62-WN	TBC-62-WN-BLK	

Applications continued on the following page

Wedged Chest Boxes

Make / Model	Cab Length	Years	Bed Style	Bed Length	Bright Aluminum#	Gloss Black#
Ford (continued)						
F-350 Super Duty	Crew	17 - 19	Styleside	6' 9"	TBC-62-WN	TBC-62-WN-BLK
		17 - 19	Styleside	8'	TBC-62-WN	TBC-62-WN-BLK
		11 - 16	Styleside	6' 9"	TBC-62-WN	TBC-62-WN-BLK
		11 - 16	Styleside	8'	TBC-62-WN	TBC-62-WN-BLK
		99 - 10	Styleside	6' 9"	TBC-62-WN	TBC-62-WN-BLK
		99 - 10	Styleside	8'	TBC-62-WN	TBC-62-WN-BLK
	Extended	17 - 19	Styleside	6' 9"	TBC-62-WN	TBC-62-WN-BLK
		17 - 19	Styleside	8'	TBC-62-WN	TBC-62-WN-BLK
		11 - 16	Styleside	6' 9"	TBC-62-WN	TBC-62-WN-BLK
		11 - 16	Styleside	8'	TBC-62-WN	TBC-62-WN-BLK
		99 - 10	Styleside	8'	TBC-62-WN	TBC-62-WN-BLK
		99 - 10	Styleside	6' 9"	TBC-62-WN	TBC-62-WN-BLK
	Standard	17 - 19	Styleside	8'	TBC-62-WN	TBC-62-WN-BLK
		11 - 16	Styleside	6' 9"	TBC-62-WN	TBC-62-WN-BLK
		11 - 16	Styleside	8'	TBC-62-WN	TBC-62-WN-BLK
		99 - 10	Styleside	6' 9"	TBC-62-WN	TBC-62-WN-BLK
99 - 10		Styleside	8'	TBC-62-WN	TBC-62-WN-BLK	
F-450 Super Duty	Crew	17 - 19	Styleside	8'	TBC-62-WN	TBC-62-WN-BLK
		11 - 16	Styleside	8'	TBC-62-WN	TBC-62-WN-BLK
		08 - 10	Styleside	8'	TBC-62-WN	TBC-62-WN-BLK
GMC						
Canyon	Crew	19 - 19	Fleetside	5'	TBC-42-W	TBC-42-W-BLK
		15 - 18	Fleetside	5' 6"	TBC-36-W	TBC-36-W-BLK
		15 - 18	Fleetside	6'	TBC-36-W	TBC-36-W-BLK
		04 - 12	Fleetside	5' 5"	TBC-36-W	TBC-36-W-BLK
	Extended	15 - 18	Fleetside	6'	TBC-36-W	TBC-36-W-BLK
		04 - 12	Fleetside	6'	TBC-36-W	TBC-36-W-BLK
Standard	04 - 12	Fleetside	6'	TBC-36-W	TBC-36-W-BLK	
Sierra 1500	Crew	14 - 19	Fleetside	5' 8"	TBC-55-WN	TBC-55-WN-BLK
		14 - 19	Fleetside	6' 6"	TBC-62-WN	TBC-62-WN-BLK
		07 - 13	Fleetside	5' 8"	TBC-55-WN	TBC-55-WN-BLK
		04 - 06	Fleetside	8'	TBC-62-WN	TBC-62-WN-BLK
		99 - 06	Fleetside	5' 8.5"	TBC-55-WN	TBC-55-WN-BLK
	Extended	14 - 19	Fleetside	6' 6"	TBC-62-WN	TBC-62-WN-BLK
		07 - 13	Fleetside	6' 6"	TBC-62-WN	TBC-62-WN-BLK
		07 - 13	Fleetside	8'	TBC-62-WN	TBC-62-WN-BLK
		99 - 05	Stepside	6' 6"	TBC-48-W	TBC-48-W-BLK
		99 - 06	Fleetside	6' 6"	TBC-62-WN	TBC-62-WN-BLK
		99 - 06	Fleetside	8'	TBC-62-WN	TBC-62-WN-BLK
	Standard	14 - 19	Fleetside	6' 6"	TBC-62-WN	TBC-62-WN-BLK
		14 - 19	Fleetside	8'	TBC-62-WN	TBC-62-WN-BLK
		07 - 13	Fleetside	6' 6"	TBC-62-WN	TBC-62-WN-BLK
07 - 13		Fleetside	8'	TBC-62-WN	TBC-62-WN-BLK	
99 - 05		Stepside	6' 6"	TBC-48-W	TBC-48-W-BLK	
99 - 06	Fleetside	6' 6"	TBC-62-WN	TBC-62-WN-BLK		
99 - 06	Fleetside	8'	TBC-62-WN	TBC-62-WN-BLK		

Applications continued on the following page

Wedged Chest Boxes

Make / Model	Cab Length	Years	Bed Style	Bed Length	Bright Aluminum#	Gloss Black#
GMC (continued)						
Sierra 1500 Classic	Crew	07 - 07	Fleetside	5' 8.5"	TBC-55-WN	TBC-55-WN-BLK
		07 - 07	Fleetside	8'	TBC-62-WN	TBC-62-WN-BLK
	Extended	07 - 07	Fleetside	6' 6"	TBC-62-WN	TBC-62-WN-BLK
		07 - 07	Fleetside	8'	TBC-62-WN	TBC-62-WN-BLK
	Standard	07 - 07	Fleetside	6' 6"	TBC-62-WN	TBC-62-WN-BLK
07 - 07		Fleetside	8'	TBC-62-WN	TBC-62-WN-BLK	
Sierra 1500 Limited	Extended	19 - 19	Fleetside	6' 6"	TBC-62-WN	TBC-62-WN-BLK
Sierra 2500	Crew	04 - 04	Fleetside	8'	TBC-62-WN	TBC-62-WN-BLK
	Extended	99 - 04	Fleetside	6' 6"	TBC-62-WN	TBC-62-WN-BLK
		99 - 04	Fleetside	8'	TBC-62-WN	TBC-62-WN-BLK
	Standard	99 - 04	Fleetside	6' 6"	TBC-62-WN	TBC-62-WN-BLK
99 - 04		Fleetside	8'	TBC-62-WN	TBC-62-WN-BLK	
Sierra 2500 HD	Crew	15 - 19	Fleetside	6' 6"	TBC-62-WN	TBC-62-WN-BLK
		15 - 19	Fleetside	8'	TBC-62-WN	TBC-62-WN-BLK
		01 - 06	Fleetside	8'	TBC-62-WN	TBC-62-WN-BLK
	Extended	01 - 19	Fleetside	6' 6"	TBC-62-WN	TBC-62-WN-BLK
		01 - 19	Fleetside	8'	TBC-62-WN	TBC-62-WN-BLK
	Standard	01 - 19	Fleetside	8'	TBC-62-WN	TBC-62-WN-BLK
01 - 06		Fleetside	6' 6"	TBC-62-WN	TBC-62-WN-BLK	
Sierra 2500 HD Classic	Crew	07 - 07	Fleetside	8'	TBC-62-WN	TBC-62-WN-BLK
	Extended	07 - 07	Fleetside	6' 6"	TBC-62-WN	TBC-62-WN-BLK
		07 - 07	Fleetside	8'	TBC-62-WN	TBC-62-WN-BLK
	Standard	07 - 07	Fleetside	6' 6"	TBC-62-WN	TBC-62-WN-BLK
07 - 07		Fleetside	8'	TBC-62-WN	TBC-62-WN-BLK	
Sierra 3500	Crew	01 - 06	Fleetside	8'	TBC-62-WN	TBC-62-WN-BLK
	Extended	01 - 06	Fleetside	8'	TBC-62-WN	TBC-62-WN-BLK
	Standard	01 - 06	Fleetside	8'	TBC-62-WN	TBC-62-WN-BLK
Sierra 3500 Classic	Crew	07 - 07	Fleetside	8'	TBC-62-WN	TBC-62-WN-BLK
	Extended	07 - 07	Fleetside	8'	TBC-62-WN	TBC-62-WN-BLK
	Standard	07 - 07	Fleetside	8'	TBC-62-WN	TBC-62-WN-BLK
Sierra 3500 HD	Crew	15 - 19	Fleetside	6' 6"	TBC-62-WN	TBC-62-WN-BLK
		15 - 19	Fleetside	8'	TBC-62-WN	TBC-62-WN-BLK
	Extended	11 - 19	Fleetside	6' 6"	TBC-62-WN	TBC-62-WN-BLK
		07 - 19	Fleetside	8'	TBC-62-WN	TBC-62-WN-BLK
	Standard	07 - 19	Fleetside	8'	TBC-62-WN	TBC-62-WN-BLK
Honda						
Ridgeline	Crew	12 - 14	Fleetside	5'	TBC-48-W	TBC-48-W-BLK
		06 - 14	Fleetside	5'	TBC-48-W	TBC-48-W-BLK
Hummer						
H3T	Crew	09 - 10	Styleside	5' 5"	TBC-42-W	TBC-42-W-BLK
Isuzu						
i-280	Extended	06 - 06	Styleside	6'	TBC-36-W	TBC-36-W-BLK
i-290	Extended	07 - 08	Styleside	6'	TBC-36-W	TBC-36-W-BLK
i-350	Crew	06 - 06	Styleside	5' 5"	TBC-36-W	TBC-36-W-BLK
i-370	Crew	07 - 08	Styleside	5' 5"	TBC-36-W	TBC-36-W-BLK
Lincoln						
Mark LT	Crew	06 - 08	Styleside	5' 6"	TBC-55-WN	TBC-55-WN-BLK
Mitsubishi						
Raider	Extended	06 - 09	Styleside	5' 6"	TBC-42-W	TBC-42-W-BLK

Applications continued on the following page

Wedged Chest Boxes

Make / Model	Cab Length	Years	Bed Style	Bed Length	Bright Aluminum#	Gloss Black#
Nissan						
Frontier	Crew	05 - 19	Styleside	5'	TBC-42-W	TBC-42-W-BLK
		05 - 19	Styleside	6'	TBC-42-W	TBC-42-W-BLK
	Extended	05 - 19	Styleside	6'	TBC-42-W	TBC-42-W-BLK
Titan	Crew	17 - 19	Styleside	6' 6"	TBC-60-W	TBC-60-W-BLK
		04 - 15	Styleside	5' 6"	TBC-55-WN	TBC-55-WN-BLK
	Extended	04 - 15	Styleside	6' 6"	TBC-60-W	TBC-60-W-BLK
		08 - 14	Styleside	7'	TBC-60-W	TBC-60-W-BLK
		08 - 09	Styleside	8'	TBC-60-W	TBC-60-W-BLK
Titan XD	Crew	16 - 19	Styleside	6' 6"	TBC-60-W	TBC-60-W-BLK
Ram						
1500	Crew	19 - 19	Fleetside	5' 7"	TBC-55-WN	TBC-55-WN-BLK
		Extended	19 - 19	Fleetside	5' 7"	TBC-55-WN
	Standard	11 - 18	Fleetside	5' 7"	TBC-55-WN	TBC-55-WN-BLK
		11 - 18	Fleetside	6' 4"	TBC-55-WN	TBC-55-WN-BLK
		11 - 18	Fleetside	6' 4"	TBC-55-WN	TBC-55-WN-BLK
		11 - 18	Fleetside	8'	TBC-62-WN	TBC-62-WN-BLK
1500 Classic	Extended	19 - 19	Fleetside	5' 7"	TBC-55-WN	TBC-55-WN-BLK
		19 - 19	Fleetside	6' 4"	TBC-55-WN	TBC-55-WN-BLK
	Standard	19 - 19	Fleetside	6' 4"	TBC-55-WN	TBC-55-WN-BLK
		19 - 19	Fleetside	8'	TBC-62-WN	TBC-62-WN-BLK
2500	Crew	11 - 19	Fleetside	6' 4"	TBC-55-WN	TBC-55-WN-BLK
		11 - 19	Fleetside	8'	TBC-62-WN	TBC-62-WN-BLK
	Extended Crew	11 - 19	Fleetside	6' 4"	TBC-55-WN	TBC-55-WN-BLK
		11 - 19	Fleetside	8'	TBC-62-WN	TBC-62-WN-BLK
	Standard	11 - 19	Fleetside	6' 4"	TBC-55-WN	TBC-55-WN-BLK
		11 - 19	Fleetside	8'	TBC-62-WN	TBC-62-WN-BLK
3500	Crew	11 - 19	Fleetside	6' 4"	TBC-55-WN	TBC-55-WN-BLK
		11 - 19	Fleetside	8'	TBC-62-WN	TBC-62-WN-BLK
	Extended Crew	11 - 19	Fleetside	6' 4"	TBC-55-WN	TBC-55-WN-BLK
		11 - 19	Fleetside	8'	TBC-62-WN	TBC-62-WN-BLK
	Standard	11 - 19	Fleetside	6' 4"	TBC-55-WN	TBC-55-WN-BLK
		11 - 19	Fleetside	8'	TBC-62-WN	TBC-62-WN-BLK
Dakota	Extended	11 - 11	Fleetside	5' 6"	TBC-42-W	TBC-42-W-BLK
Suzuki						
Equator	Crew	09 - 12	Styleside	5'	TBC-42-W	TBC-42-W-BLK
		09 - 12	Styleside	6'	TBC-42-W	TBC-42-W-BLK
Toyota						
Tacoma	Crew	19 - 19	Fleetside	5'	TBC-36-W	TBC-36-W-BLK
		05 - 15	Fleetside	5'	TBC-42-W	TBC-42-W-BLK
		05 - 15	Fleetside	6'	TBC-42-W	TBC-42-W-BLK
	Extended	05 - 15	Fleetside	6'	TBC-42-W	TBC-42-W-BLK
Standard	05 - 14	Fleetside	6'	TBC-42-W	TBC-42-W-BLK	
Tundra	Crew	07 - 19	Fleetside	6' 6"	TBC-55-WN	TBC-55-WN-BLK
		07 - 19	Fleetside	8'	TBC-62-WN	TBC-62-WN-BLK
	Extended	00 - 06	Fleetside	6' 5"	TBC-55-WN	TBC-55-WN-BLK
	Extended Crew	07 - 19	Fleetside	5' 5"	TBC-55-WN	TBC-55-WN-BLK
	Standard	07 - 17	Fleetside	6' 6"	TBC-55-WN	TBC-55-WN-BLK
		07 - 17	Fleetside	8'	TBC-62-WN	TBC-62-WN-BLK
		00 - 04	Fleetside	6' 5"	TBC-55-WN	TBC-55-WN-BLK
00 - 06		Fleetside	8'	TBC-60-W	TBC-60-W-BLK	

5TH WHEEL CHEST BOXES



KEY FEATURES

Low-profile design provides plenty of clearance when towing a 5th wheel trailer

Patented RigidCore™ foam-filled lid to maximize strength and prevent binding

Product Details

- Designed to mount inside the truck bed, leaving bed rails free for other use
- 0.058" extra-thick, one-piece aluminum tub holds heavy tools and cargo
- Stainless steel lock handles for security and corrosion-resistant operation
- Connecting rod allows for convenient operation from driver or passenger side
- Interior rod enclosure helps prevent bending or jamming of lock system
- MicroSeal™ gasket helps seal out moisture, dust and dirt
- Lid self-opens to 90 degrees for convenient operation and loading



FWB-58-BLK

FW-58

Finishes & Materials



Finish:
Bright aluminum

Material:
Aluminum alloy



Finish:
Gloss black

Material:
Aluminum alloy

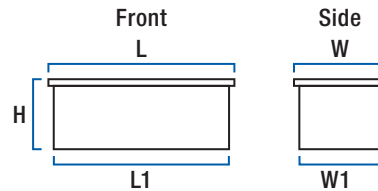

5th Wheel Chest Boxes

Part#	Finish	Cubic Feet	Dimensions (inches)				
			L	L1	W	W1	H
FWB-58	Bright aluminum	6.1	58.8125	58	18.75	18	11.125
FWB-58-BLK	Gloss black	6.1	58.8125	58	18.75	18	11.125

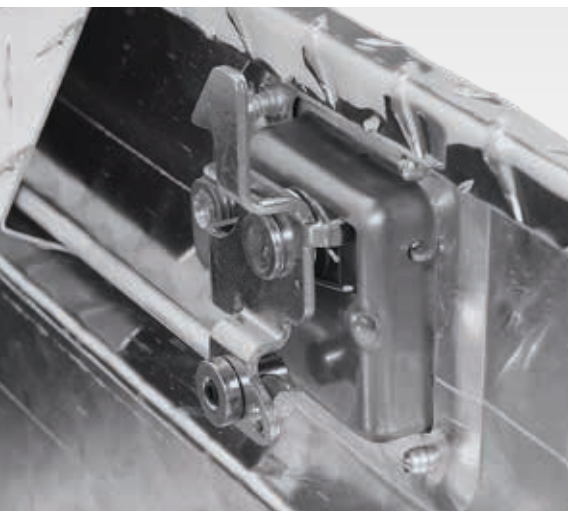

STANDARD CHEST BOXES



KEY FEATURES

- Offers highly secure storage for tools, equipment or personal items
- Patented RigidCore™ foam-filled lid to maximize strength and prevent binding

Product Details

- 0.058" extra-thick, one-piece aluminum tub holds heavy tools and cargo
- Stainless steel lock handles for security and corrosion-resistant operation
- MicroSeal™ gasket helps seal out moisture, dust and dirt
- Lid self-opens to 90 degrees for convenient operation and loading

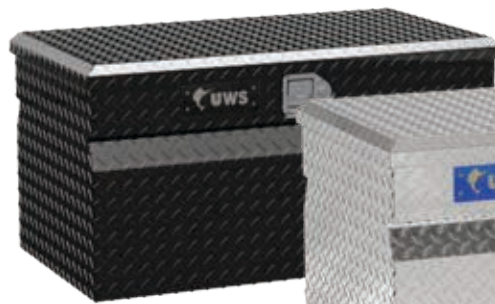

TBC-30-BLK



TBC-30

Finishes & Materials



Finish:
Bright aluminum

Material:
Aluminum alloy



Finish:
Gloss black

Material:
Aluminum alloy

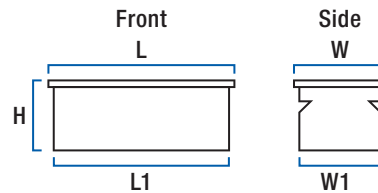

Standard Chest Boxes

Part#	Finish	Cubic Feet	Dimensions (inches)				
			L	L1	W	W1	H
TBC-30	Bright aluminum	5.3	30.875	30	20	19.25	17.125
TBC-30-BLK	Gloss black	5.3	30.875	30	20	19.25	17.125
TBC-36	Bright aluminum	7.2	36.875	36	20	19.25	19
TBC-36-BLK	Gloss black	7.2	36.875	36	20	19.25	19
TBC-42	Bright aluminum	8.4	42.875	42	20	19.25	19
TBC-42-BLK	Gloss black	8.4	42.875	42	20	19.25	19
TBC-48	Bright aluminum	12.8	47.875	47	24.75	24	21.25
TBC-48-BLK	Gloss black	12.8	47.875	47	24.75	24	21.25
TBC-48-DD*	Bright aluminum	11.1	47.875	47	20.6875	20	21.125
TBC-60	Bright aluminum	16.7	30.875	30	20	19.25	17.125
TBC-60-BLK	Gloss black	16.7	30.875	30	20	19.25	17.125

* Designed to be used with cargo carrier #UWS-CARRIER



TRAILER TONGUE BOXES



KEY FEATURES

Available for A-frame and straight-tongue trailers

Patented RigidCore™ foam-filled lid to maximize strength and prevent binding

Product Details

- 0.058" extra-thick, one-piece aluminum tub holds heavy tools and cargo
- Stainless steel lock handle for security and corrosion-resistant operation
- MicroSeal™ gasket helps seal out moisture, dust and dirt
- Lid self-opens to 90 degrees for convenient operation and loading
- Low-profile option provides added clearance for a hand winch or other obstructions



TBV-34



TBV-34-LP-BLK

Finishes & Materials



Finish:
Bright aluminum
Material:
Aluminum alloy



Finish:
Gloss black
Material:
Aluminum alloy

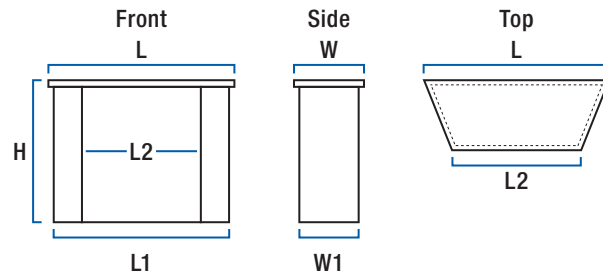

Trailer Tongue Boxes								
Part#	Finish	Cubic Feet	Dimensions (inches)					
			L	L1	L2	W	W1	H
TBV-34	Bright aluminum	4.1	34.625	33	19.88	17	16	22
TBV-34-BLK	Gloss black	4.1	34.625	33	19.88	17	16	22
TBV-34-LP	Bright aluminum	2.9	34.625	33	19.88	17	16	13
TBV-34-LP-BLK	Gloss black	2.9	34.625	33	19.88	17	16	13
TBV-49	Bright aluminum	6.3	49.875	48	23.88	18.875	18	22
TBV-49-BLK	Gloss black	6.3	49.875	48	23.88	18.875	18	22



TOTE BOXES & FOOT LOCKERS



Tote Boxes

- Transportable and lockable to protect valuables at home, work or in your vehicle
- 0.058" extra-thick, one-piece aluminum tub holds heavy tools and cargo
- Twist latch can accept a padlock to help secure box and its contents
- Carrying handle on top for easier portability



Foot Lockers

- Offers highly secure storage of tools, equipment or personal items
- Patented RigidCore™ foam-filled lid to maximize strength and prevent binding
- 0.058" extra-thick, one-piece aluminum tub holds heavy tools and cargo
- Stainless steel lock handles for security and corrosion-resistant operation
- MicroSeal™ gasket helps seal out moisture, dust and dirt
- Lid self-opens to 90 degrees for convenient operation and loading
- Carrying handles on the sides for easier portability



Finishes & Materials



Finish:
Bright aluminum
Material:
Aluminum alloy



Finish:
Gloss black
Material:
Aluminum alloy

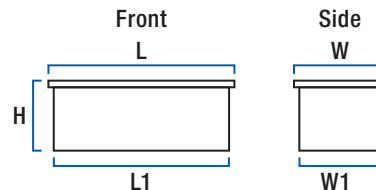

Tote Boxes & Foot Lockers							
Part#	Finish	Cubic Feet	Dimensions (inches)				
			L	L1	W	W1	H
Tote Boxes							
TB-1	Bright aluminum	0.8	20.875	20	12.25	11.41	7
TB-2	Bright aluminum	1.3	20.875	20	12.25	11.41	11.125
Foot Lockers							
FOOT-LOCKER	Bright aluminum	4.8	35.875	35	20	19.25	13.25
FOOT-LOCKER-BLK	Gloss black	4.8	35.875	35	20	19.25	13.25





UTV & ATV TOOL BOXES

TAKE IT TO THE FIELD

An ATV or UTV tool box from UWS makes it easy for your customers to bring their tools and equipment along for the adventure – in the field, on the trail or on the job. Our UTV boxes install with vehicle-specific hardware, offering a custom fit on several popular UTV models. We also offer our ATV tool boxes, featuring a universal fit. Both are equipped with our patented RigidCore™ foam-filled lid and extra-thick aluminum build for strength, security and reliability.



FEATURED PRODUCTS



UTV crossover boxes

These crossover-style tool boxes add secure storage to a UTV and install with vehicle-specific brackets on popular models.



UTV side mount boxes

This new tool box mounts onto the bed wall of the UTV using vehicle-specific brackets, maximizing storage, security and organization.



ATV boxes

With a universal design, ATV boxes can be mounted on virtually any ATV cargo rack, and they feature side handles for easy mobility.

PRODUCT INDEX



60

UTV Crossover
Tool Boxes

Made in USA



60

UTV Side Mount
Tool Boxes

Made in USA



62

ATV
Tool Boxes

Made in USA

UTV TOOL BOXES



KEY FEATURES

Mounts with vehicle-specific brackets for a custom fit

Allows a UTV to transport cargo and keep tools on hand in the field

NEW



UTV-SM33-MB

Product Details

- Patented RigidCore™ foam-filled lid to maximize strength and prevent binding
- 0.058" extra-thick, one-piece aluminum tub holds heavy tools and cargo
- Stainless steel lock handles for security and corrosion-resistant operation
- MicroSeal™ gasket helps seal out moisture, dust and dirt
- Lid self-opens to nearly 90 degrees for convenient operation and loading
- Available in crossover and side-mount styles



UTV-59-MB

Finish & Material



Finish:
Matte black

Material:
Aluminum alloy

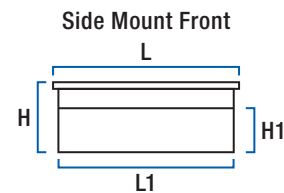
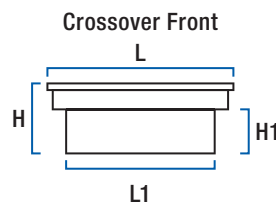

UTV Tool Boxes

Make	Model	Style	Years	Kit (Box and Hardware)	Box Only	Hardware Only	Cu. Ft.	Dimensions (inches)					
				Black#	Box#	Hardware#		L	L1	W	W1	H	H1
Crossover													
Can-Am	Defender	Full-size	16-18	8500002	UTV-59-MB	UTV-59CA	3.2	59.75	52	12.25	11.5	10.25	4.5
Honda	Pioneer	1000	17-18	8500004	UTV-59-MB	UTV-59HP	3.2	59.75	52	12.25	11.5	10.25	4.5
Kawasaki	Mule	Pro FXT	12-18	8500003	UTV-59-MB	UTV-59KM	3.2	59.75	52	12.25	11.5	10.25	4.5
Polaris	Ranger	Full-size	08-18	8500000	UTV-59-MB	UTV-59PR	3.2	59.75	52	12.25	11.5	10.25	4.5
	Ranger 1000	Full-size	08-18	8500005	UTV-59PR-MB	UTV-59PR	3.2	59.75	52	12.25	11.5	10.25	4.5
Yamaha	Viking	Full-size	13-18	8500001	UTV-59-MB	UTV-59YV	3.2	59.75	52	12.25	11.5	10.25	4.5
Side Mount													
Polaris	Ranger	Full-size	08-18	UTV-SM33-MB	--	Incl. in kit	2.45	33.8125	33	12	8.5	15.1875	9.5



ATV TOOL BOXES



KEY FEATURES

Designed to mount on an ATV to transport cargo and keep tools on hand in the field

Patented RigidCore™ foam-filled lid to maximize strength and prevent binding

Product Details

- 0.058" extra-thick, one-piece aluminum tub holds heavy tools and cargo
- Stainless steel lock handles for security and corrosion-resistant operation
- MicroSeal™ gasket helps seal out moisture, dust and dirt
- Lid self-opens to 90 degrees for convenient operation and loading
- Carrying handle on the sides for easier portability



Finishes & Materials



Finish:
Bright aluminum
Material:
Aluminum alloy



Finish:
Gloss black
Material:
Aluminum alloy

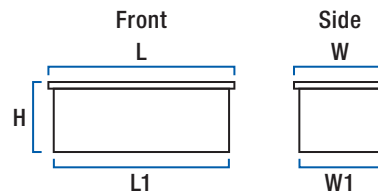

ATV Tool Boxes					
Part#	Finish	Cubic Feet	Dimensions (inches)		
			A	B	C
ATV	Bright aluminum	2.7	32.875	12.875	13.125
ATV-BLK	Gloss black	2.7	32.875	12.875	13.125





SIDE MOUNT BOXES

MAXIMUM STORAGE FOR THE JOB

A side mount tool box from UWS allows your customers to maximize storage space on their truck. They are particularly suited for commercial trucks. We offer truck side, topside, underbody and fender tool boxes. New for 2019, we've added a line of low-profile truck side boxes. These offer a sleeker, more streamlined look in the truck bed, integrating with our low-profile crossover boxes. All UWS side mount boxes feature extra-thick aluminum construction and are made right here in the USA.



FEATURED PRODUCTS

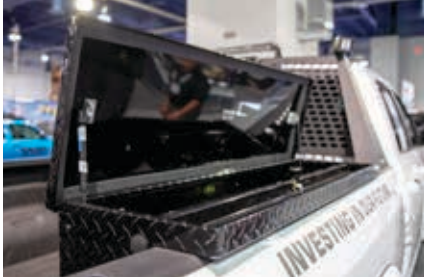

Low-profile side boxes

These new truck side boxes have a low profile to better integrate with our low-profile crossover boxes and provide a more streamlined look.



Fender boxes

Made for the driver and passenger sides, truck fender boxes provide a secure storage space, as well as three integrated sliding drawers.



Topside boxes

Ideal for maximizing storage space while retaining use of the truck bed. These boxes are available in single-door and double-door models.

PRODUCT INDEX



66

Topside
Tool Boxes

Made in USA



68

Truck Side
Tool Boxes

Made in USA



70

Truck Fender
Tool Boxes

Made in USA



72

Underbody
Tool Boxes

Made in USA

TOPSIDE TOOL BOXES



KEY FEATURES

Mounts on top of truck bed rail for easy cargo and tool access

Stainless steel aircraft cables for strong door support

Product Details

- 0.058" extra-thick, one-piece aluminum tub holds heavy tools and cargo
- Door opens 90 degrees for easy loading and unloading of tools and equipment
- Stainless steel T-handles for security and corrosion resistance
- MicroSeal™ gasket helps seal out moisture, dust and dirt
- Multiple box sizes available for a custom fit on each truck application
- Available with single door and double doors



Finishes & Materials



Finish:
Bright aluminum

Material:
Aluminum alloy



Finish:
Gloss black

Material:
Aluminum alloy

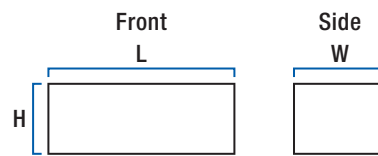

Topside Tool Boxes								
Part#	Finish	Cubic Feet	# of Doors	Door Opening Dims (in.)		Box Dimensions (inches)		
				L	H	L	W	H
TBTS-48	Bright aluminum	6.3	1	42.5	12	48	13.685	17
TBTS-48-BLK	Gloss black	6.3	1	42.5	12	48	13.685	17
TBTS-60	Bright aluminum	7.8	1	55.5	12	60	13.685	17
TBTS-60-BLK	Gloss black	7.8	1	55.5	12	60	13.685	17
TBTS-72	Bright aluminum	9.4	2	30.5	12	72	13.685	17
TBTS-72-BLK	Gloss black	9.4	2	30.5	12	72	13.685	17
TBTS-90	Bright aluminum	11.7	2	39.5	12	90	13.685	17
TBTS-90-BLK	Gloss black	11.7	2	39.5	12	90	13.685	17
TBTS-96	Bright aluminum	12.5	2	42.5	12	96	13.685	17
TBTS-96-BLK	Gloss black	12.5	2	42.5	12	96	13.685	17



TRUCK SIDE TOOL BOXES



KEY FEATURES

Mounts on the inside of the truck bed rails to provide additional storage space

Patented RigidCore™ foam-filled lid to maximize strength and prevent binding

Product Details

- 0.058" extra-thick, one-piece aluminum tub holds heavy tools and cargo
- Low-profile option available to match low-profile crossover boxes
- Standard profile models use stainless steel lock handles for security and corrosion-resistant operation
- Low-profile models feature lockable, push-button operation with non-corrosive stainless steel construction



TBSM-36

TBSM-36-LP-BLK

Finishes & Materials



Finish:
Bright aluminum

Material:
Aluminum alloy



Finish:
Gloss black

Material:
Aluminum alloy

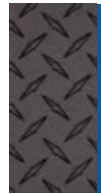

Finish:
Matte black

Material:
Aluminum alloy

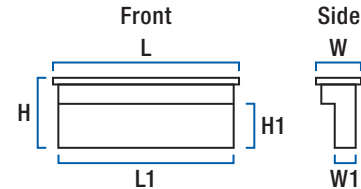

Truck Side Tool Boxes

Part#	Profile	Finish	Cubic Feet	Dimensions (inches)					
				L	L1	W	W1	H	H1
TBSM-36	Standard	Bright aluminum	2.2	36.875	36	12	7	12	6.5
TBSM-36-LP	Low	Bright aluminum	2.3	36.75	36	14.375	9.25	11.75	8.75
TBSM-36-LP-BLK	Low	Gloss black	2.3	36.75	36	14.375	9.25	11.75	8.75
TBSM-36-LP-MB	Low	Matte black	2.3	36.75	36	14.375	9.25	11.75	8.75
TBSM-48	Standard	Bright aluminum	3	48.875	48	12	7	12	6.5
TBSM-48-BLK	Standard	Gloss black	3	48.875	48	12	7	12	6.5
TBSM-48-LP	Low	Bright aluminum	3	48.75	48	14.375	9.25	11.75	8.75
TBSM-48-LP-BLK	Low	Gloss black	3	48.75	48	14.375	9.25	11.75	8.75
TBSM-48-LP-MB	Low	Matte black	3	48.75	48	14.375	9.25	11.75	8.75
TBSM-60	Standard	Bright aluminum	3.7	60.875	60	12	7	12	6.5
TBSM-60-BLK	Standard	Gloss black	3.7	60.875	60	12	7	12	6.5
TBSM-72	Standard	Bright aluminum	4.2	72.875	72	12	7	12	6.5
TBSM-72-BLK	Standard	Gloss black	4.2	72.875	72	12	7	12	6.5
TBSM-96	Standard	Bright aluminum	5.7	96.875	96	12	7	12	6.5



TRUCK FENDER TOOL BOXES



KEY FEATURES

Integrates with the wheel well fender to provide convenient storage space

Single-lid storage box opens from the side of the truck for easy access

Product Details

- Patented RigidCore™ foam-filled lid to maximize strength and prevent binding
- 0.058" extra-thick, one-piece aluminum tub holds heavy tools and cargo
- Three sliding drawers open toward the rear for storage of tools and equipment
- Corrosion-resistant zinc-plated metal sliders ensure long life
- Stainless steel ball bearings for smooth operation
- Stainless steel lock handle for security and corrosion-resistant operation
- MicroSeal™ gasket helps seal out moisture, dust and dirt
- Lid self-opens to 90 degrees for convenient operation and loading
- Available for driver and passenger side



FW-55-DS-D

FW-55-DS-D-BLK

Finishes & Materials



Finish:
Bright
aluminum

Material:
Aluminum
alloy



Finish:
Gloss
black

Material:
Aluminum
alloy

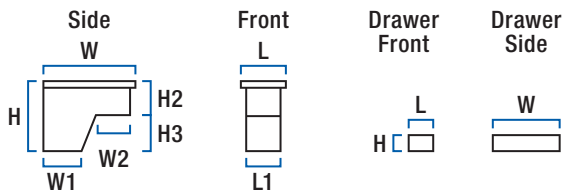

Truck Fender Tool Boxes

Part#	Finish	Vehicle Side	Cu. Ft.	# of Drawers	Drawer Dims (in.)			Box Dimensions (inches)							
					L	W	H	L	L1	W	W1	W2	H	H2	H3
FW-48-DS-P	Bright alum.	Pass.	3.9	1	4.375	15	3	8.75	8	47.875	18	20.25	24.625	12.8125	11.75
				2	4.375	15	2								
FW-48-DS-P-BLK	Gloss black	Pass.	3.9	1	4.375	15	3	8.75	8	47.875	18	20.25	24.625	12.8125	11.75
				2	4.375	15	2								
FW-48-DS-D	Bright alum.	Driver	3.9	1	4.375	15	3	8.75	8	47.875	18	20.25	24.625	12.8125	11.75
				2	4.375	15	2								
FW-48-DS-D-BLK	Gloss black	Driver	3.9	1	4.375	15	3	8.75	8	47.875	18	20.25	24.625	12.8125	11.75
				2	4.375	15	2								
FW-55-DS-P	Bright alum.	Pass.	4.4	1	4.375	19	3	8.75	8	55.875	20	26	24.625	12.8125	11.75
				2	4.375	19	2								
FW-55-DS-D	Bright alum.	Driver	4.4	1	4.375	19	3	8.75	8	55.875	20	26	24.625	12.8125	11.75
				2	4.375	19	2								

UNDERBODY TOOL BOXES



KEY FEATURES

Mounts above or below flatbeds, dump trucks and trailer bodies

Stainless steel aircraft cables for strong door support

Product Details

- 0.075" extra-thick, one-piece aluminum tub holds heavy tools and cargo
- Door opens 90 degrees for easy loading and unloading of tools and equipment
- Stainless steel T-handles for security and corrosion resistance
- MicroSeal™ gasket helps seal out moisture, dust and dirt
- Multiple box sizes available for a custom fit on each truck application
- Available with single and double doors



TBUB-72

TBUB-36-BLK

Finishes & Materials



Finish:
Bright aluminum

Material:
Aluminum alloy



Finish:
Gloss black

Material:
Aluminum alloy

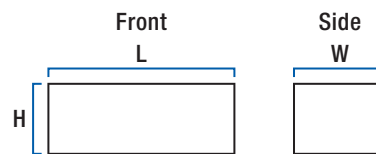

Underbody Tool Boxes

Part#	Finish	Cubic Feet	# of Doors	Door Opening Dims (in.)		Box Dimensions (inches)		
				L	H	L	W	H
TBUB-24	Bright aluminum	4.6	1	19.5	13	24	19	18
TBUB-30	Bright aluminum	5.7	1	25.5	13	30	19	18
TBUB-36	Bright aluminum	6.9	1	31.5	13	36	19	18
TBUB-36-BLK	Gloss black	6.9	1	31.5	13	36	19	18
TBUB-48	Bright aluminum	9.2	1	43.5	13	48	19	18
TBUB-60	Bright aluminum	11	1	55.5	13	60	19	18
TBUB-72	Bright aluminum	12.9	2	30.5	13	72	19	18
TBUB-96	Bright aluminum	17.2	2	42.5	13	96	19	18





DRAWER BOXES

INTEGRATED ORGANIZATION

A UWS drawer box gives your customers the perfect combination of security and organization for small items and tools. We offer drawer boxes with five integrated drawers, as well as a utility chest box with ten drawers and an integrated storage compartment. Both feature precision-injected, commercial-grade drawers and stainless steel ball-bearing drawer slides. They're perfect for the truck bed or in the garage, shop or at the office. We also offer fender boxes with three integrated drawers.



FEATURED PRODUCTS



Utility chest with drawers

This enhanced utility chest provides the ultimate secure storage and organization, featuring a large center compartment and built-in drawers.



Drawer boxes

Great for a variety of applications, these boxes have five integrated sliding drawers with stainless steel sliders for long-lasting operation.



Fender boxes

Available for driver and passenger sides, truck fender boxes provide a secure storage compartment, and three integrated sliding drawers.

PRODUCT INDEX



76

Utility Chest Box with Drawers

Made in USA



78

Drawer Truck Tool Boxes

Made in USA



80

Truck Fender Tool Boxes

Made in USA

UTILITY CHEST BOXES WITH DRAWERS



KEY FEATURES

Two drawer boxes with ten precision-injected drawers for storage of small tools

Four-cubic-foot center storage area for oversized tools and equipment

Product Details

- Provides greater access to and organization of small tools and equipment
- Integrated drawer design provides maximum security and organization
- Stainless steel, ball bearing drawer slides for smooth operation
- Patented RigidCore™ foam-filled lid to maximize strength and prevent binding
- 0.058" extra-thick, one-piece aluminum tub holds heavy tools and cargo
- Stainless steel lock handle for security and corrosion-resistant operation
- Front and top opening lids for easy access to tools and equipment
- Lid self-opens to 90 degrees for convenient operation and loading
- Three-compartment sliding tray for convenient small item storage and retrieval
- Carrying handles on the sides for easier portability



TBC-38-DS



TBC-38-DS-BLK

Finishes & Materials



Finish:
Bright aluminum
Material:
Aluminum alloy



Finish:
Gloss black
Material:
Aluminum alloy

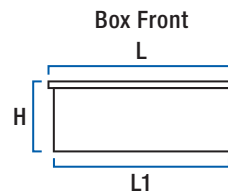

Utility Chest Boxes with Drawers

Part#	Finish	Cubic Feet	# of Drawers	Drawer Dimensions (in.)			Chest Dimensions (inches)				
				L	W	H	L	L1	W	W1	H
TBC-38-DS	Bright aluminum	10.1	4	4.375	19	2	38	37	23	21.875	20
			6	4.375	19	3					
TBC-38-DS-BLK	Gloss black	10.1	4	4.375	19	2	38	37	23	21.875	20
			6	4.375	19	3					



DRAWER TRUCK TOOL BOXES



KEY FEATURES

Five precision-injected, commercial-grade drawers for secure storage

Stainless steel T-handle lock for security and corrosion resistance

Product Details

- Provides greater access to and organization of small tools and equipment
- Integrated drawer design provides maximum security and organization
- Stainless steel, ball bearing drawer slides for smooth operation
- MicroSeal™ gasket helps seal out moisture, dust and dirt
- Hardware included for easy mounting on trucks, vans, trailers or workbenches



DS-18

DS-18-BLK

Finishes & Materials



Finish:
Bright aluminum
Material:
Aluminum alloy



Finish:
Gloss black
Material:
Aluminum alloy

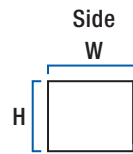

Drawer Truck Tool Boxes

Part#	Finish	Cubic Feet	# of Drawers	Drawer Dimensions (in.)			Box Dimensions (inches)		
				W	L	H	W	L	H
DS-18	Bright aluminum	1.5	2	15	4.375	2	18	7.75	18.75
			3	15	4.375	3			
DS-18-BLK	Gloss black	1.5	2	15	4.375	2	18	7.75	18.75
			3	15	4.375	3			
DS-22	Bright aluminum	1.9	2	19	4.375	2	22	7.75	18.75
			3	19	4.375	3			
DS-22-BLK	Gloss black	1.9	2	19	4.375	2	22	7.75	18.75
			3	19	4.375	3			



TRUCK FENDER TOOL BOXES



KEY FEATURES

Integrates with the wheel well fender to provide convenient storage space

Single-lid storage box opens from the side of the truck for easy access

Product Details

- Patented RigidCore™ foam-filled lid to maximize strength and prevent binding
- 0.058" extra-thick, one-piece aluminum tub holds heavy tools and cargo
- Three sliding drawers open toward the rear for storage of tools and equipment
- Corrosion-resistant zinc-plated metal sliders ensure long life
- Stainless steel ball bearings for smooth operation
- Stainless steel lock handle for security and corrosion-resistant operation
- MicroSeal™ gasket helps seal out moisture, dust and dirt
- Lid self-opens to 90 degrees for convenient operation and loading
- Available for driver and passenger side



FW-55-DS-D

FW-55-DS-D-BLK

Finishes & Materials



Finish:
Bright
aluminum

Material:
Aluminum
alloy



Finish:
Gloss
black

Material:
Aluminum
alloy

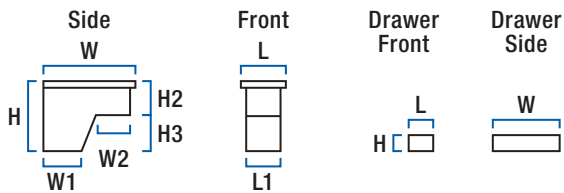

Truck Fender Tool Boxes

Part#	Finish	Vehicle Side	Cu. Ft.	# of Drawers	Drawer Dims (in.)			Box Dimensions (inches)							
					L	W	H	L	L1	W	W1	W2	H	H2	H3
FW-48-DS-P	Bright alum.	Pass.	3.9	1	4.375	15	3	8.75	8	47.875	18	20.25	24.625	12.8125	11.75
				2	4.375	15	2								
FW-48-DS-P-BLK	Gloss black	Pass.	3.9	1	4.375	15	3	8.75	8	47.875	18	20.25	24.625	12.8125	11.75
				2	4.375	15	2								
FW-48-DS-D	Bright alum.	Driver	3.9	1	4.375	15	3	8.75	8	47.875	18	20.25	24.625	12.8125	11.75
				2	4.375	15	2								
FW-48-DS-D-BLK	Gloss black	Driver	3.9	1	4.375	15	3	8.75	8	47.875	18	20.25	24.625	12.8125	11.75
				2	4.375	15	2								
FW-55-DS-P	Bright alum.	Pass.	4.4	1	4.375	19	3	8.75	8	55.875	20	26	24.625	12.8125	11.75
				2	4.375	19	2								
FW-55-DS-D	Bright alum.	Driver	4.4	1	4.375	19	3	8.75	8	55.875	20	26	24.625	12.8125	11.75
				2	4.375	19	2								



TRANSFER TANKS

TESTED FOR TOUGH JOBS

A transfer tank from UWS is the ideal solution for transporting non-flammable liquids, including diesel, to the jobsite. We offer several different sizes and styles. For 2019, we are introducing an all-new line of steel transfer tanks, including combo, L-shaped and rectangular configurations. The steel combo tanks are an industry-first, featuring a heavy-duty steel tank with an aluminum tool box. These unique combo tanks weigh less than full-steel models and have a sleek, smooth finish.



FEATURED PRODUCTS



Steel-aluminum combo

These combo tanks are an industry first, featuring a dual construction of steel and aluminum to weigh less than competitive, full-steel models.



Steel L-shape & rectangular

Our new steel transfer tank line also includes L-shaped and rectangular models. All feature a smooth finish in black or white powder coat.



Aluminum tanks

Our aluminum tanks are built with heavy-duty aluminum alloy and feature a commercial-grade vented cap and an integrated drain plug.

PRODUCT INDEX



84

Steel-Aluminum
Combo
Tanks

Made in USA



86

Steel
L-Shaped
Tanks

Made in USA



86

Steel
Rectangular
Tanks

Made in USA



88

Aluminum
Combo
Tanks

Made in USA



90

Aluminum
L-Shaped
Tanks

Made in USA



90

Aluminum
Rectangular
Tanks

Made in USA

STEEL-ALUMINUM COMBO TANKS

NEW



KEY FEATURES



Industry-first steel-aluminum combo weighs less than full-steel



Unique, smooth finish for a sleek look compared to diamond plate



Heavy-duty 14-gauge steel tank is 100% pressure-tested for safety



.080" thick aluminum tool box is lightweight and non-corrosive

Product Details

- Transfers diesel or other non-flammable liquids to on-site vehicles or equipment
- Built-in tool box provides added storage without reducing truck bed space
- Patented RigidCore™ foam-filled lid to maximize strength and prevent binding
- Stainless steel lock handles with connecting rod for operation from either side
- MicroSeal™ gasket helps seal out moisture, dust and dirt
- Lid self-opens to 90 degrees and self-closes for convenient operation
- 5/16" nylock machine screws mount the box to the tank (no isolators needed)
- Lockable, commercial-grade vented cap with reinforced collar for added security (replacement cap #UWS-CAPS)
- Built-in drain plug for easy and complete emptying as needed
- 1/8" steel tabs for solid installation and built-in lifting hooks for easy relocation
- Internal baffles for extra strength and an even flow of liquid
- [See page 92 for application information](#)



ST-100-COMBO-MB



ST-75-COMBO-W

Finishes & Materials

Finish:
Matte black

Tank material:
Carbon steel

Tool box material:
Aluminum alloy

Finish:
Semi-gloss white

Tank material:
Carbon steel

Tool box material:
Aluminum alloy

WARNING: Transfer tanks are not intended to be used as an auxiliary tank and may not meet certain states' specifications. Inspect system at least monthly.

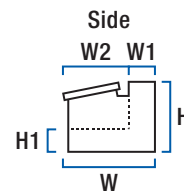
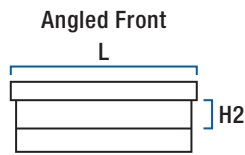
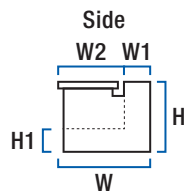
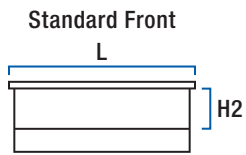

Steel-Aluminum Combo Transfer Tanks

Part#	Finish	Gallons	Angled Lid	Cubic Feet	Dimensions (inches)						
					L*	W	W1	W2	H**	H1	H2
ST-75-COMBO-W	Semi-gloss white	75	Yes	6.5	48.5	27	9	18	24	9	15
ST-75-COMBO-MB	Matte Black	75	Yes	6.5	48.5	27	9	18	24	9	15
ST-85-COMBO-W	Semi-gloss white	85	No	12	48.25	34	10	24	26	8	18
ST-85-COMBO-MB	Matte Black	85	No	12	48.25	34	10	24	26	8	18
ST-100-COMBO-W	Semi-gloss white	100	No	11.4	60	31	9	22	24	9	15
ST-100-COMBO-MB	Matte Black	100	No	11.4	60	31	9	22	24	9	15

* Add 3" to dimension (L) for mounting bracket clearance

** Add 2-3/4" to dimension (H) for vent cap clearance

STEEL L-SHAPED & RECTANGULAR TANKS

NEW

KEY FEATURES

Transfers diesel or other non-flammable liquids to on-site vehicles or equipment

Heavy-duty 14-gauge steel tank for maximum strength and durability



Product Details

- 5/16" nylock machine screws mount the box to the tank (no isolators needed)
- Unique, smooth finish for a sleek look compared to diamond plate
- Lockable, commercial-grade vented cap with reinforced collar for added security (replacement cap #UWS-CAPS)
- Drain plug allows for easy emptying whenever necessary
- Two built-in lifting hooks for easier relocation in and out of the truck
- Heavy-duty 1/8" thick mounting tabs for solid installation in the truck bed
- Internal baffles for extra strength and an even flow of liquid
- 100% pressure-tested for safety
- [See page 92 for application information](#)



ST-100-L-MB

Finishes & Materials



Finish:
Matte
black

Material:
Carbon
steel



Finish:
Semi-gloss
white

Material:
Carbon
steel



ST-100-R-W



WARNING: Transfer tanks are not intended to be used as an auxiliary tank and may not meet certain states' specifications. Inspect system at least monthly.

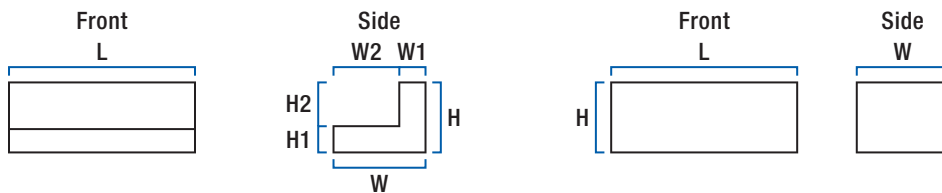

Steel L-Shaped & Rectangular Transfer Tanks

Part#	Finish	Gallons	Dimensions (inches)						
			L*	W	W1	W2	H**	H1	H2
L-Shaped									
ST-75-L-W	Semi-gloss white	75	48	27	9	18	24	9	15
ST-75-L-MB	Matte black	75	48	27	9	18	24	9	15
ST-85-L-W	Semi-gloss white	85	48	34	10	24	26	8	18
ST-85-L-MB	Matte black	85	48	34	10	24	26	8	18
ST-100-L-W	Semi-gloss white	100	59.5	31	9	22	24	9	15
ST-100-L-MB	Matte black	100	59.5	31	9	22	24	9	15
Rectangular									
ST-45-R-W	Semi-gloss white	45	54	10.5	--	--	19.5	--	--
ST-45-R-MB	Matte black	45	54	10.5	--	--	19.5	--	--
ST-100-R-W	Semi-gloss white	100	59.5	21	--	--	21	--	--
ST-100-R-MB	Matte black	100	59.5	21	--	--	21	--	--

* Add 3" to dimension (L) for mounting bracket clearance

** Add 2-3/4" to dimension (H) for vent cap clearance

ALUMINUM COMBO TANKS



KEY FEATURES

Transfers diesel or other non-flammable liquids to on-site vehicles or equipment

Built-in tool box provides added storage without reducing truck bed space

Product Details

- Heavy-duty aluminum alloy provides maximum protection and durability
- Lockable, commercial-grade vented cap with reinforced collar for added security (replacement cap #UWS-CAPS)
- Internal baffles for added extra strength and an even flow of liquid
- Drain plug allows for easy emptying whenever necessary
- Patented RigidCore™ foam-filled lid to maximize strength and prevent binding
- Stainless steel lock handles for security and corrosion-resistant operation
- Connecting rod allows for convenient operation from driver or passenger side
- Interior rod enclosure helps prevent bending or jamming of lock system
- MicroSeal™ gasket helps seal out moisture, dust and dirt
- Lid self-opens to 90 degrees for convenient operation and loading
- [See page 92 for application information](#)



TT-100-COMBO



TT-100-CB-B

Finishes & Materials



Finish:
Bright
aluminum

Material:
Aluminum
alloy



Finish:
Gloss
black

Material:
Aluminum
alloy



WARNING: Transfer tanks are not intended to be used as an auxiliary tank and may not meet certain states' specifications. Inspect system at least monthly.

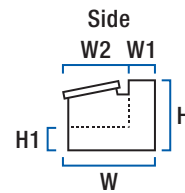
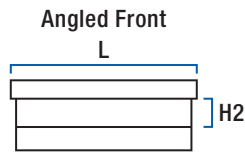
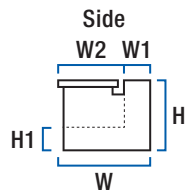
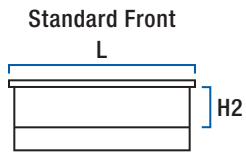
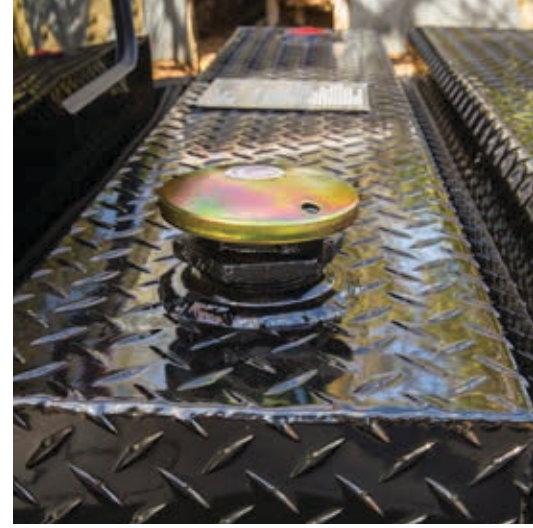

Aluminum Combo Transfer Tanks

Part#	Finish	Gallons	Angled Lid	Cubic Feet	Dimensions (inches)						
					L*	W	W1	W2	H**	H1	H2
TT-45-COMBO	Bright aluminum	45	Yes	3.4	54.875	18.5	6	12	20.125	8	9
TT-45-COMBO-BLK	Gloss black	45	Yes	3.4	54.875	18.5	6	12	20.125	8	9
TT-50-COMBO	Bright aluminum	50	No	7	36.875	32.375	8	24	22.5	8	14.25
TT-50-COMBO-BLK	Gloss black	50	No	7	36.875	32.375	8	24	22.5	8	14.25
TT-75-COMBO	Bright aluminum	75	Yes	6.5	48.875	27.375	9	18	24	9	13
TT-75-COMBO-BLK	Gloss black	75	Yes	6.5	48.875	27.375	9	18	24	9	13
TT-85-COMBO	Bright aluminum	85	No	12	48.375	34.25	10	24	26.5	8	18
TT-85-COMBO-BLK	Gloss black	85	No	12	48.375	34.25	10	24	26.5	8	18
TT-100-COMBO	Bright aluminum	100	No	11.4	60.25	31.25	9	22	24.5	9	15
TT-100-CB-B	Gloss black	100	No	11.4	60.25	31.25	9	22	24.5	9	15
TT-101-COMBO	Bright aluminum	101	No	11.4	53.75	32.375	10	22	25.625	10	15
TT-101-CB-B	Gloss black	101	No	11.4	53.75	32.375	10	22	25.625	10	15

* Add 3" to dimension (L) for mounting bracket clearance

** Add 2-3/4" to dimension (H) for vent cap clearance

ALUMINUM L-SHAPED & RECTANGULAR TANKS



KEY FEATURES

Transfers diesel or other non-flammable liquids to on-site vehicles or equipment

Lockable, commercial-grade vented cap with reinforced collar for added security (replacement cap #UWS-CAPS)

Product Details

- Heavy-duty aluminum alloy provides maximum protection and durability
- Internal baffles for added extra strength and an even flow of liquid
- Drain plug allows for easy emptying whenever necessary
- Rectangular tanks available in bright aluminum only
- See page 92 for application information



TT-50-L-T-P-BLK

Finishes & Materials



Finish:
Bright
aluminum

Material:
Aluminum
alloy



Finish:
Gloss
black

Material:
Aluminum
alloy



TT-50-R-T-P



WARNING: Transfer tanks are not intended to be used as an auxiliary tank and may not meet certain states' specifications. Inspect system at least monthly.

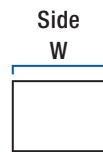
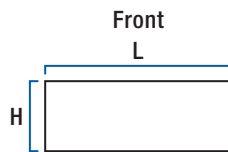
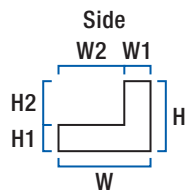
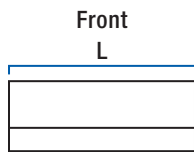

Aluminum L-Shaped & Rectangular Transfer Tanks

Part#	Finish	Gallons	Dimensions (inches)						
			L*	W	W1	W2	H**	H1	H2
L-Shaped									
TT-50-L-T-P	Bright aluminum	50	36.25	32	8	24	22	8	14
TT-50-L-T-P-BLK	Gloss black	50	36.25	32	8	24	22	8	14
TT-75-L-T-P	Bright aluminum	75	48	27	9	18	24	9	15
TT-75-L-T-P-BLK	Gloss black	75	48	27	9	18	24	9	15
TT-85-L-T-P	Bright aluminum	85	48	34	10	24	26	8	18
TT-85-L-T-P-BLK	Gloss black	85	48	34	10	24	26	8	18
TT-100-L-T-P	Bright aluminum	100	59.5	31	9	22	24	9	15
TT-100-L-T-P-BLK	Gloss black	100	59.5	31	9	22	24	9	15
TT-101-L-T-P	Bright aluminum	101	53	32	10	22	25	10	15
TT-101-L-T-P-BLK	Gloss black	101	53	32	10	22	25	10	15
Rectangular									
TT-45-R-T-P	Bright aluminum	45	54	10.5	--	--	19.5	--	--
TT-50-R-T-P	Bright aluminum	50	36	19	--	--	19	--	--
TT-100-R-T-P	Bright aluminum	100	59.5	21	--	--	21	--	--

* Add 3" to dimension (L) for mounting bracket clearance

** Add 2-3/4" to dimension (H) for vent cap clearance



Available ordering options

Steel part#s are Semi-Gloss White. To select Matte Black, change '-W' of part# to '-MB'
 Aluminum part#s are Bright Aluminum. To select Gloss Black, add '-BLK' to end of part#. Rectangular part#s not available in Gloss Black.

Steel-Aluminum		Steel		Aluminum																			
Combo		L-shaped	Rect.	Combo					L-shaped			Rect.											
ST-75-COMBO-W	ST-85-COMBO-W	ST-100-COMBO-W	ST-75-L-W	ST-85-L-W	ST-100-L-W	ST-45-R-W	ST-100-R-W	TT-45-COMBO	TT-50-COMBO	TT-75-COMBO	TT-85-COMBO	TT-100-COMBO	TT-100-CB-B (black)	TT-101-COMBO	TT-101-CB-B (black)	TT-50-L-T-P	TT-75-L-T-P	TT-85-L-T-P	TT-100-L-T-P	TT-101-L-T-P	TT-45-R-T-P	TT-50-R-T-P	TT-100-R-T-P

Make / Model	Cab Length	Years	Bed Style	Bed Length	ST-75-COMBO-W	ST-85-COMBO-W	ST-100-COMBO-W	ST-75-L-W	ST-85-L-W	ST-100-L-W	ST-45-R-W	ST-100-R-W	TT-45-COMBO	TT-50-COMBO	TT-75-COMBO	TT-85-COMBO	TT-100-COMBO	TT-100-CB-B (black)	TT-101-COMBO	TT-101-CB-B (black)	TT-50-L-T-P	TT-75-L-T-P	TT-85-L-T-P	TT-100-L-T-P	TT-101-L-T-P	TT-45-R-T-P	TT-50-R-T-P	TT-100-R-T-P		
Chevrolet (continued)																														
Silverado 2500 HD Classic	Crew	07 - 07	Fleetside	8'	--	--	●	--	--	●	--	●	--	--	--	--	●	●	--	--	--	--	●	--	--	--	●	--	●	
	Extended	07 - 07	Fleetside	6' 6"	●	●	--	●	●	--	●	--	--	--	--	●	●	--	--	--	--	--	●	●	--	--	●	--	--	
		07 - 07	Fleetside	8'	--	--	●	--	--	●	--	●	--	--	--	--	●	●	--	--	--	--	--	●	●	--	--	●	--	●
Silverado 3500	Standard	07 - 07	Fleetside	6' 6"	●	●	--	●	●	--	●	--	--	--	●	●	--	--	--	--	--	●	●	--	--	●	--	--	●	
	Crew	07 - 07	Fleetside	8'	--	--	●	--	--	●	--	●	--	--	--	--	●	●	--	--	--	--	--	●	●	--	--	●	--	●
		01 - 06	Fleetside	8'	--	--	●	--	--	●	--	●	--	--	--	--	●	●	--	--	--	--	--	●	●	--	--	●	--	●
Silverado 3500 Classic	Extended	01 - 06	Fleetside	8'	--	--	●	--	--	●	--	●	--	--	--	--	●	●	--	--	--	--	●	●	--	--	●	--	●	
	Crew	07 - 07	Fleetside	8'	--	--	●	--	--	●	--	●	--	--	--	--	●	●	--	--	--	--	--	●	●	--	--	●	--	●
		07 - 07	Fleetside	8'	--	--	●	--	--	●	--	●	--	--	--	--	●	●	--	--	--	--	--	●	●	--	--	●	--	●
Silverado 3500 HD	Standard	07 - 07	Fleetside	8'	--	--	●	--	--	●	--	●	--	--	--	--	●	●	--	--	--	--	●	●	--	--	●	--	●	
	Crew	15 - 19	Fleetside	6' 6"	●	●	--	●	●	--	●	--	--	--	●	●	--	--	--	--	--	--	●	●	--	--	●	--	●	
		15 - 19	Fleetside	8'	--	--	●	--	--	●	--	●	--	--	--	--	●	●	--	--	--	--	--	●	●	--	--	●	--	●
	Extended	11 - 19	Fleetside	6' 6"	●	●	--	●	●	--	●	--	--	--	●	●	--	--	--	--	--	--	●	●	--	--	●	--	●	--
07 - 19		Fleetside	8'	--	--	●	--	--	●	--	●	--	--	--	--	●	●	--	--	--	--	--	●	●	--	--	●	--	●	
Standard	07 - 19	Fleetside	8'	--	--	●	--	--	●	--	●	--	--	--	--	●	●	--	--	--	--	--	●	●	--	--	●	--	●	
Dodge																														
Dakota	Extended	09 - 10	Fleetside	5' 6"	--	--	--	--	--	--	--	--	--	●	--	--	--	--	--	--	--	●	--	--	--	--	●	--	--	
		00 - 04	Fleetside	5' 6"	--	--	--	--	--	--	--	--	--	--	●	--	--	--	--	--	--	--	●	--	--	--	--	●	--	--
		97 - 04	Fleetside	6' 6"	--	--	--	--	--	--	--	--	--	--	●	--	--	--	--	--	--	--	●	--	--	--	--	●	--	--
	Standard	00 - 04	Fleetside	5' 6"	--	--	--	--	--	--	--	--	--	--	●	--	--	--	--	--	--	--	●	--	--	--	--	●	--	--
		87 - 04	Fleetside	6' 6"	--	--	--	--	--	--	--	--	--	--	●	--	--	--	--	--	--	--	●	--	--	--	--	●	--	--
Ram 1500	Crew	09 - 10	Fleetside	5' 7"	--	--	--	--	--	--	--	--	--	●	--	--	--	--	--	--	--	●	--	--	--	--	●	--	--	
		09 - 10	Fleetside	6' 4"	--	--	--	--	--	--	--	--	--	--	●	--	--	--	--	--	--	--	●	--	--	--	--	●	--	--
		09 - 10	Fleetside	8'	--	--	●	--	--	●	--	●	--	--	--	--	●	●	--	--	--	--	--	●	●	--	--	●	--	●
	Extended	09 - 10	Fleetside	5' 7"	--	--	--	--	--	--	--	--	--	--	●	--	--	--	--	--	--	--	●	--	--	--	--	●	--	--
		09 - 10	Fleetside	6' 4"	--	--	--	--	--	--	--	--	--	--	●	--	--	--	--	--	--	--	●	--	--	--	--	●	--	--
		09 - 10	Fleetside	8'	--	--	●	--	--	●	--	●	--	--	--	--	●	●	--	--	--	--	--	●	●	--	--	●	--	●
	Ext. Crew	06 - 08	Fleetside	6' 6"	--	--	--	--	--	--	--	--	--	--	●	--	--	--	--	--	--	--	●	--	--	--	--	●	--	--
		06 - 08	Fleetside	8'	--	--	●	--	--	●	--	●	--	--	--	--	●	●	--	--	--	--	--	●	●	--	--	●	--	●
	Standard	09 - 10	Fleetside	5' 7"	--	--	--	--	--	--	--	--	--	--	●	--	--	--	--	--	--	--	●	--	--	--	--	●	--	--
		09 - 10	Fleetside	6' 4"	--	--	--	--	--	--	--	--	--	--	●	--	--	--	--	--	--	--	●	--	--	--	--	●	--	--
09 - 10		Fleetside	8'	--	--	●	--	--	●	--	●	--	--	--	--	●	●	--	--	--	--	--	●	●	--	--	●	--	●	
02 - 08		Fleetside	6' 6"	--	--	--	--	--	--	--	--	--	--	●	--	--	--	--	--	--	--	●	--	--	--	--	●	--	--	
02 - 08		Fleetside	8'	--	--	●	--	--	●	--	●	--	--	--	--	●	●	--	--	--	--	--	●	●	--	--	●	--	●	
Ram 2500	Crew	03 - 08	Fleetside	6' 6"	--	--	--	--	--	--	--	--	--	--	--	--	--	--	--	--	--	●	●	--	--	●	--	--	●	
		03 - 08	Fleetside	8'	--	--	●	--	--	●	--	●	--	--	--	--	●	●	--	--	--	--	--	●	●	--	--	●	--	●
	Ext. Crew	06 - 08	Fleetside	6' 6"	--	--	--	--	--	--	--	--	--	--	--	--	--	--	--	--	--	●	●	--	--	●	--	--	●	
		06 - 08	Fleetside	8'	--	--	●	--	--	●	--	●	--	--	--	--	●	●	--	--	--	--	--	●	●	--	--	●	--	●
Standard	03 - 08	Fleetside	6' 6"	--	--	--	--	--	--	--	--	--	--	--	--	--	--	--	--	--	●	●	--	--	●	--	--	●	--	●
	03 - 08	Fleetside	8'	--	--	●	--	--	●	--	●	--	--	--	--	●	●	--	--	--	--	--	●	●	--	--	●	--	●	
	03 - 08	Fleetside	8'	--	--	●	--	--	●	--	●	--	--	--	--	●	●	--	--	--	--	--	●	●	--	--	●	--	●	
Ram 3500	Crew	03 - 08	Fleetside	6' 6"	--	--	--	--	--	--	--	--	--	--	--	--	--	--	--	--	--	●	●	--	--	●	--	--	●	
		03 - 08	Fleetside	8'	--	--	●	--	--	●	--	●	--	--	--	--	●	●	--	--	--	--	--	●	●	--	--	●	--	●
	Ext. Crew	06 - 08	Fleetside	6' 6"	--	--	--	--	--	--	--	--	--	--	--	--	--	--	--	--	--	●	●	--	--	●	--	--	●	
		06 - 08	Fleetside	8'	--	--	●	--	--	●	--	●	--	--	--	--	●	●	--	--	--	--	--	●	●	--	--	●	--	●
	Standard	03 - 08	Fleetside	6' 6"	--	--	--	--	--	--	--	--	--	--	--	--	--	--	--	--	--	●	●	--	--	●	--	--	●	--
03 - 08	Fleetside	8'	--	--	●	--	--	●	--	●	--	--	--	--	●	●	--	--	--	--	--	●	●	--	--	●	--	●		

Applications continued on the following page



Available ordering options
 Steel part#s are Semi-Gloss White. To select Matte Black, change '-W' of part# to '-MB'
 Aluminum part#s are Bright Aluminum. To select Gloss Black, add '-BLK' to end of part#. Rectangular part#s not available in Gloss Black.

Steel-Aluminum		Steel			Aluminum																		
Combo		L-shaped	Rect.		Combo					L-shaped			Rect.										
ST-75-COMBO-W	ST-85-COMBO-W	ST-100-COMBO-W	ST-75-L-W	ST-85-L-W	ST-100-L-W	ST-45-R-W	ST-100-R-W	TT-45-COMBO	TT-50-COMBO	TT-75-COMBO	TT-85-COMBO	TT-100-COMBO	TT-100-CB-B (black)	TT-101-COMBO	TT-101-CB-B (black)	TT-50-L-T-P	TT-75-L-T-P	TT-85-L-T-P	TT-100-L-T-P	TT-101-L-T-P	TT-45-R-T-P	TT-50-R-T-P	TT-100-R-T-P

Make / Model	Cab Length	Years	Bed Style	Bed Length	ST-75-COMBO-W	ST-85-COMBO-W	ST-100-COMBO-W	ST-75-L-W	ST-85-L-W	ST-100-L-W	ST-45-R-W	ST-100-R-W	TT-45-COMBO	TT-50-COMBO	TT-75-COMBO	TT-85-COMBO	TT-100-COMBO	TT-100-CB-B (black)	TT-101-COMBO	TT-101-CB-B (black)	TT-50-L-T-P	TT-75-L-T-P	TT-85-L-T-P	TT-100-L-T-P	TT-101-L-T-P	TT-45-R-T-P	TT-50-R-T-P	TT-100-R-T-P	
Ford																													
Explorer Sport Trac	--	07 - 10	Styleside	4' 6"	--	--	--	--	--	--	--	--	--	●	--	--	--	--	--	--	●	--	--	--	--	--	--	●	--
		01 - 05	Styleside	4' 6"	--	--	--	--	--	--	--	--	--	●	--	--	--	--	--	--	●	--	--	--	--	--	--	●	--
F-150	Crew	15 - 19	Styleside	5' 6"	●	●	--	●	●	--	--	--	--	--	●	●	--	--	--	--	--	●	●	--	--	--	--	--	--
		15 - 19	Styleside	6' 6"	●	●	--	●	●	--	--	--	--	--	●	●	--	--	--	--	--	●	●	--	--	--	--	--	--
		09 - 14	Styleside	5' 6"	●	●	--	●	●	--	--	--	--	--	●	●	--	--	--	--	--	●	●	--	--	--	--	--	--
		09 - 14	Styleside	6' 6"	●	●	--	●	●	--	--	--	--	--	●	●	--	--	--	--	--	●	●	--	--	--	--	--	--
		04 - 08	Styleside	5' 6"	●	●	--	●	●	--	--	--	--	--	●	●	--	--	--	--	--	●	●	--	--	--	--	--	--
		01 - 03	Styleside	5'	●	●	--	●	●	--	--	--	--	--	●	●	--	--	--	--	--	●	●	--	--	--	--	--	--
		01 - 03	Styleside	6' 6"	●	●	--	●	●	--	--	--	--	--	●	●	--	--	--	--	--	●	●	--	--	--	--	--	--
		01 - 08	Styleside	8'	●	●	--	●	●	--	--	--	--	--	●	●	--	--	--	--	--	●	●	--	--	--	--	--	--
	Extended	15 - 19	Styleside	6' 6"	●	●	--	●	●	--	--	--	--	--	●	●	--	--	--	--	--	●	●	--	--	--	--	--	--
		15 - 19	Styleside	8'	●	●	--	●	●	--	--	--	--	--	●	●	--	--	--	--	--	●	●	--	--	--	--	--	--
		09 - 14	Styleside	6' 6"	●	●	--	●	●	--	--	--	--	--	●	●	--	--	--	--	--	●	●	--	--	--	--	--	--
		04 - 08	Styleside	6' 6"	●	●	--	●	●	--	--	--	--	--	●	●	--	--	--	--	--	●	●	--	--	--	--	--	--
		04 - 08	Flareside	6' 6"	●	●	--	●	●	--	--	--	--	--	●	●	--	--	--	--	--	●	●	--	--	--	--	--	--
		04 - 08	Styleside	8'	●	●	--	●	●	--	--	--	--	--	●	●	--	--	--	--	--	●	●	--	--	--	--	--	--
		97 - 03	Styleside	6' 6"	●	●	--	●	●	--	--	--	--	--	●	●	--	--	--	--	--	●	●	--	--	--	--	--	--
		97 - 03	Flareside	6' 6"	●	●	--	●	●	--	--	--	--	--	●	●	--	--	--	--	--	●	●	--	--	--	--	--	--
		97 - 03	Styleside	8'	●	●	--	●	●	--	--	--	--	--	●	●	--	--	--	--	--	●	●	--	--	--	--	--	--
	Standard	15 - 19	Styleside	6' 6"	●	●	--	●	●	--	--	--	--	--	●	●	--	--	--	--	--	●	●	--	--	--	--	--	--
		15 - 19	Styleside	8'	●	●	--	●	●	--	--	--	--	--	●	●	--	--	--	--	--	●	●	--	--	--	--	--	--
		09 - 14	Styleside	6' 6"	●	●	--	●	●	--	--	--	--	--	●	●	--	--	--	--	--	●	●	--	--	--	--	--	--
		09 - 14	Styleside	8'	●	●	--	●	●	--	--	--	--	--	●	●	--	--	--	--	--	●	●	--	--	--	--	--	--
		04 - 08	Flareside	6' 6"	●	●	--	●	●	--	--	--	--	--	●	●	--	--	--	--	--	●	●	--	--	--	--	--	--
		04 - 08	Styleside	5' 6"	●	●	--	●	●	--	--	--	--	--	●	●	--	--	--	--	--	●	●	--	--	--	--	--	--
		04 - 08	Styleside	8'	●	●	--	●	●	--	--	--	--	--	●	●	--	--	--	--	--	●	●	--	--	--	--	--	--
		97 - 03	Styleside	6' 6"	●	●	--	●	●	--	--	--	--	--	●	●	--	--	--	--	--	●	●	--	--	--	--	--	--
		97 - 03	Flareside	6' 6"	●	●	--	●	●	--	--	--	--	--	●	●	--	--	--	--	--	●	●	--	--	--	--	--	--
		97 - 03	Styleside	8'	●	●	--	●	●	--	--	--	--	--	●	●	--	--	--	--	--	●	●	--	--	--	--	--	--
F-150 Heritage	Extended	04 - 04	Styleside	6' 6"	●	●	--	●	●	--	--	--	--	--	●	●	--	--	--	--	--	●	●	--	--	--	--	--	--
		04 - 04	Styleside	8'	●	●	--	●	●	--	--	--	--	--	●	●	--	--	--	--	--	●	●	--	--	--	--	--	--
	Standard	04 - 04	Styleside	6' 6"	●	●	--	●	●	--	--	--	--	--	●	●	--	--	--	--	--	●	●	--	--	--	--	--	--
		04 - 04	Flareside	6' 6"	●	●	--	●	●	--	--	--	--	--	●	●	--	--	--	--	--	●	●	--	--	--	--	--	--
		04 - 04	Styleside	8'	●	●	--	●	●	--	--	--	--	--	●	●	--	--	--	--	--	●	●	--	--	--	--	--	--
F-250 Super Duty	Crew	17 - 19	Styleside	8'	--	--	--	--	--	--	--	--	--	--	--	--	--	--	--	--	●	●	--	--	●	--	--	--	--
		17 - 19	Styleside	6' 9"	--	--	--	--	--	--	--	--	--	--	--	--	--	--	--	--	--	●	●	--	--	●	--	--	--
		11 - 16	Styleside	6' 9"	--	--	--	--	--	--	--	--	--	--	--	--	--	--	--	--	--	●	●	--	--	●	--	--	--
		11 - 16	Styleside	8'	--	--	--	--	--	--	--	--	--	--	--	--	--	--	--	--	--	●	●	--	--	●	--	--	--
		99 - 10	Styleside	6' 9"	--	--	--	--	--	--	--	--	--	--	--	--	--	--	--	--	--	●	●	--	--	●	--	--	--
		99 - 10	Styleside	8'	--	--	--	--	--	--	--	--	--	--	--	--	--	--	--	--	--	●	●	--	--	●	--	--	--
	Extended	17 - 19	Styleside	6' 9"	--	--	--	--	--	--	--	--	--	--	--	--	--	--	--	--	--	●	●	--	--	●	--	--	--
		17 - 19	Styleside	8'	--	--	--	--	--	--	--	--	--	--	--	--	--	--	--	--	--	●	●	--	--	●	--	--	--
		11 - 16	Styleside	6' 9"	--	--	--	--	--	--	--	--	--	--	--	--	--	--	--	--	--	●	●	--	--	●	--	--	--
		11 - 16	Styleside	8'	--	--	--	--	--	--	--	--	--	--	--	--	--	--	--	--	--	●	●	--	--	●	--	--	--
		99 - 10	Styleside	6' 9"	--	--	--	--	--	--	--	--	--	--	--	--	--	--	--	--	--	●	●	--	--	●	--	--	--
		99 - 10	Styleside	8'	--	--	--	--	--	--	--	--	--	--	--	--	--	--	--	--	--	●	●	--	--	●	--	--	--
	Standard	17 - 19	Styleside	8'	--	--	--	--	--	--	--	--	--	--	--	--	--	--	--	--	--	●	●	--	--	●	--	--	--
		11 - 16	Styleside	6' 9"	--	--	--	--	--	--	--	--	--	--	--	--	--	--	--	--	--	●	●	--	--	●	--	--	--
		11 - 16	Styleside	8'	--	--	--	--	--	--	--	--	--	--	--	--	--	--	--	--	--	●	●	--	--	●	--	--	--
		99 - 10	Styleside	6' 9"	--	--	--	--	--	--	--	--	--	--	--	--	--	--	--	--	--	●	●	--	--	●	--	--	--
		99 - 10	Styleside	8'	--	--	--	--	--	--	--	--	--	--	--	--	--	--	--	--	--	●	●	--	--	●	--	--	--

Applications continued on the following page



Available ordering options

Steel part#s are Semi-Gloss White. To select Matte Black, change '-W' of part# to '-MB'
 Aluminum part#s are Bright Aluminum. To select Gloss Black, add '-BLK' to end of part#. Rectangular part#s not available in Gloss Black.

Steel-Aluminum	Steel		Aluminum																				
	Combo	L-shaped	Rect.	Combo					L-shaped			Rect.											
ST-75-COMBO-W	ST-85-COMBO-W	ST-100-COMBO-W	ST-75-L-W	ST-85-L-W	ST-100-L-W	ST-45-R-W	ST-100-R-W	TT-45-COMBO	TT-50-COMBO	TT-75-COMBO	TT-85-COMBO	TT-100-COMBO	TT-100-CB-B (black)	TT-101-COMBO	TT-101-CB-B (black)	TT-50-L-T-P	TT-75-L-T-P	TT-85-L-T-P	TT-100-L-T-P	TT-101-L-T-P	TT-45-R-T-P	TT-50-R-T-P	TT-100-R-T-P

Make / Model

Cab Length **Years** **Bed Style** **Bed Length**

GMC (continued)

Sierra 2500	Crew	04 - 04	Fleetside	8'	--	--	●	--	--	●	--	--	●	--	--	--	--	--	●	--	--	●	--	●
	Extended	99 - 04	Fleetside	6' 6"	●	●	--	●	●	--	●	--	--	--	--	--	●	●	--	--	●	--	●	--
		99 - 04	Fleetside	8'	--	--	●	--	--	●	--	●	--	--	--	--	--	--	--	●	--	--	●	--
	Standard	99 - 04	Fleetside	6' 6"	●	●	--	●	●	--	●	--	--	--	--	--	●	●	--	--	●	--	●	--
99 - 04		Fleetside	8'	--	--	●	--	--	●	--	●	--	--	--	--	--	--	--	●	--	--	●	--	
Sierra 2500 HD	Crew	15 - 19	Fleetside	6' 6"	●	●	--	●	●	--	●	--	--	--	--	●	●	--	--	●	--	●	--	
		15 - 19	Fleetside	8'	--	--	●	--	--	●	--	●	--	--	--	--	--	--	--	●	--	--	●	--
		01 - 06	Fleetside	8'	--	--	●	--	--	●	--	●	--	--	--	--	--	--	--	●	--	--	●	--
	Extended	01 - 19	Fleetside	6' 6"	●	●	--	●	●	--	●	--	--	--	--	--	●	●	--	--	●	--	●	--
		01 - 19	Fleetside	8'	--	--	●	--	--	●	--	●	--	--	--	--	--	--	--	●	--	--	●	--
	Standard	01 - 19	Fleetside	8'	--	--	●	--	--	●	--	●	--	--	--	--	--	--	--	●	--	--	●	--
01 - 06		Fleetside	6' 6"	●	●	--	●	●	--	●	--	--	--	--	--	●	●	--	--	●	--	●	--	
Sierra 2500 HD Classic	Crew	07 - 07	Fleetside	8'	--	--	●	--	--	●	--	●	--	--	--	--	--	--	●	--	--	●	--	
		07 - 07	Fleetside	6' 6"	●	●	--	●	●	--	●	--	--	--	--	--	●	●	--	--	●	--	●	--
	Standard	07 - 07	Fleetside	8'	--	--	●	--	--	●	--	●	--	--	--	--	--	--	--	●	--	--	●	--
		07 - 07	Fleetside	6' 6"	●	●	--	●	●	--	●	--	--	--	--	--	●	●	--	--	●	--	●	--
Sierra 3500	Crew	01 - 06	Fleetside	8'	--	--	●	--	--	●	--	●	--	--	--	--	--	--	●	--	--	●	--	
	Extended	01 - 06	Fleetside	8'	--	--	●	--	--	●	--	●	--	--	--	--	--	--	--	●	--	--	●	--
		01 - 06	Fleetside	8'	--	--	●	--	--	●	--	●	--	--	--	--	--	--	--	●	--	--	●	--
Sierra 3500 Classic	Crew	07 - 07	Fleetside	8'	--	--	●	--	--	●	--	●	--	--	--	--	--	--	●	--	--	●	--	
		07 - 07	Fleetside	8'	--	--	●	--	--	●	--	●	--	--	--	--	--	--	--	●	--	--	●	--
	Standard	07 - 07	Fleetside	6' 6"	●	●	--	●	●	--	●	--	--	--	--	●	●	--	--	●	--	●	--	
Sierra 3500 HD	Crew	15 - 19	Fleetside	6' 6"	●	●	--	●	●	--	●	--	--	--	--	●	●	--	--	●	--	●	--	
		15 - 19	Fleetside	8'	--	--	●	--	--	●	--	●	--	--	--	--	--	--	--	●	--	--	●	--
	Extended	11 - 19	Fleetside	6' 6"	●	●	--	●	●	--	●	--	--	--	--	●	●	--	--	●	--	●	--	
		07 - 19	Fleetside	8'	--	--	●	--	--	●	--	●	--	--	--	--	--	--	--	●	--	--	●	--
	Standard	07 - 19	Fleetside	8'	--	--	●	--	--	●	--	●	--	--	--	--	--	--	--	●	--	--	●	--
Sonoma	Crew	01 - 04	Fleetside	4' 8"	--	--	--	--	--	--	--	--	--	--	--	●	--	--	--	--	--	●	--	
	Extended	94 - 03	Fleetside	6'	--	--	--	--	--	--	--	--	--	--	--	●	--	--	--	--	--	--	●	--
		96 - 03	Stepside	6'	--	--	--	--	--	--	--	--	--	--	--	●	--	--	--	--	--	--	●	--
	Standard	94 - 03	Fleetside	6'	--	--	--	--	--	--	--	--	--	--	●	--	--	--	--	--	--	--	●	--
		94 - 03	Fleetside	7' 6"	--	--	--	--	--	--	--	--	--	--	●	--	--	--	--	--	--	●	--	

Honda

Ridgeline	Crew	17 - 18	Fleetside	5' 5"	--	--	--	--	--	--	--	--	--	--	●	--	--	--	--	--	--	●	--	
		12 - 14	Fleetside	5'	--	--	--	--	--	--	--	--	--	--	--	●	--	--	--	--	--	--	●	--
		06 - 14	Fleetside	5'	--	--	--	--	--	--	--	--	--	--	--	●	--	--	--	--	--	--	●	--

Hummer

H3T	Crew	09 - 10	Styleside	5' 5"	--	--	--	--	--	--	--	--	--	--	●	--	--	--	--	--	--	●	--
-----	------	---------	-----------	-------	----	----	----	----	----	----	----	----	----	----	---	----	----	----	----	----	----	---	----

Isuzu

i-280	Extended	06 - 06	Styleside	6'	--	--	--	--	--	--	--	--	--	--	●	--	--	--	--	--	--	●	--
i-290	Extended	07 - 08	Styleside	6'	--	--	--	--	--	--	--	--	--	--	●	--	--	--	--	--	--	●	--
i-350	Crew	06 - 06	Styleside	5' 5"	--	--	--	--	--	--	--	--	--	--	●	--	--	--	--	--	--	●	--
i-370	Crew	07 - 08	Styleside	5' 5"	--	--	--	--	--	--	--	--	--	--	●	--	--	--	--	--	--	●	--

Lincoln

Mark LT	Crew	06 - 08	Styleside	5' 6"	--	--	--	--	--	--	--	--	--	--	●	--	--	--	--	--	--	●	--
---------	------	---------	-----------	-------	----	----	----	----	----	----	----	----	----	----	---	----	----	----	----	----	----	---	----

Mazda

B2300	Extended	03 - 04	Styleside	6'	--	--	--	--	--	--	--	--	--	--	●	--	--	--	--	--	--	●	--
	Standard	01 - 09	Styleside	6'	--	--	--	--	--	--	--	--	--	--	●	--	--	--	--	--	--	●	--
B2500	Extended	00 - 00	Styleside	6'	--	--	--	--	--	--	--	--	--	--	●	--	--	--	--	--	--	●	--
		98 - 99	Styleside	6'	--	--	--	--	--	--	--	--	--	--	●	--	--	--	--	--	--	●	--
	Standard	00 - 01	Styleside	6'	--	--	--	--	--	--	--	--	--	--	●	--	--	--	--	--	--	●	--
98 - 99		Styleside	6'	--	--	--	--	--	--	--	--	--	--	●	--	--	--	--	--	--	●	--	
B3000	Extended	00 - 07	Styleside	6'	--	--	--	--	--	--	--	--	--	--	●	--	--	--	--	--	--	●	--
		99 - 99	Styleside	6'	--	--	--	--	--	--	--	--	--	--	●	--	--	--	--	--	--	●	--
	Standard	00 - 07	Styleside	6'	--	--	--	--	--	--	--	--	--	--	●	--	--	--	--	--	--	●	--
		98 - 98	Styleside	6'	--	--	--	--	--	--	--	--	--	--	●	--	--	--	--	--	--	●	--
B4000	Extended	00 - 09	Styleside	6'	--	--	--	--	--	--	--	--	--	●	--	--	--	--	--	--	●	--	

Applications continued on the following page



Available ordering options

Steel part#s are Semi-Gloss White. To select Matte Black, change '-W' of part# to '-MB'
 Aluminum part#s are Bright Aluminum. To select Gloss Black, add '-BLK' to end of part#. Rectangular part#s not available in Gloss Black.

Make / Model	Cab Length	Years	Bed Style	Bed Length	Steel-Aluminum		Steel						Aluminum															
					Combo			L-shaped			Rect.			Combo			L-shaped			Rect.								
					ST-75-COMBO-W	ST-85-COMBO-W	ST-100-COMBO-W	ST-75-L-W	ST-85-L-W	ST-100-L-W	ST-45-R-W	ST-100-R-W	TT-45-COMBO	TT-50-COMBO	TT-75-COMBO	TT-85-COMBO	TT-100-COMBO	TT-100-CB-B (black)	TT-101-COMBO	TT-101-CB-B (black)	TT-50-L-T-P	TT-75-L-T-P	TT-85-L-T-P	TT-100-L-T-P	TT-101-L-T-P	TT-45-R-T-P	TT-50-R-T-P	TT-100-R-T-P
Mitsubishi																												
Raider	Extended	06 - 09	Styleside	5' 6"	--	--	--	--	--	--	--	--	--	--	--	--	--	--	--	--	--	--	--	--	--	--	--	--
Nissan																												
Frontier	Crew	05 - 19	Styleside	5'	--	--	--	--	--	--	--	--	--	--	--	--	--	--	--	--	--	--	--	--	--	--	--	
		05 - 19	Styleside	6'	--	--	--	--	--	--	--	--	--	--	--	--	--	--	--	--	--	--	--	--	--	--	--	--
		00 - 04	Styleside	5'	--	--	--	--	--	--	--	--	--	--	--	--	--	--	--	--	--	--	--	--	--	--	--	--
	Extended	05 - 19	Styleside	6'	--	--	--	--	--	--	--	--	--	--	--	--	--	--	--	--	--	--	--	--	--	--	--	--
		98 - 04	Styleside	6' 6"	--	--	--	--	--	--	--	--	--	--	--	--	--	--	--	--	--	--	--	--	--	--	--	--
	Standard	98 - 01	Styleside	6' 6"	--	--	--	--	--	--	--	--	--	--	--	--	--	--	--	--	--	--	--	--	--	--	--	--
Titan	Crew	17 - 19	Styleside	6' 6"	--	--	--	--	--	--	--	--	--	--	--	--	--	--	--	--	--	--	--	--	--	--	--	
		04 - 15	Styleside	5' 6"	--	--	--	--	--	--	--	--	--	--	--	--	--	--	--	--	--	--	--	--	--	--	--	
	Extended	04 - 15	Styleside	6' 6"	--	--	--	--	--	--	--	--	--	--	--	--	--	--	--	--	--	--	--	--	--	--	--	--
		08 - 14	Styleside	7'	--	--	--	--	--	--	--	--	--	--	--	--	--	--	--	--	--	--	--	--	--	--	--	--
		08 - 09	Styleside	8'	--	--	●	--	--	●	--	●	--	--	●	●	--	--	--	●	--	--	●	--	--	●	--	
Titan XD	Crew	16 - 19	Styleside	6' 6"	--	--	--	--	--	--	--	--	--	--	--	--	--	--	--	--	--	--	--	--	--	--	--	
Ram																												
1500	Crew	19 - 19	Fleetside	5' 7"	--	--	--	--	--	--	--	--	--	●	--	--	--	--	--	--	●	--	--	--	--	●	--	
		11 - 18	Fleetside	5' 7"	--	--	--	--	--	--	--	--	--	--	●	--	--	--	--	--	●	--	--	--	--	●	--	
	Extended	11 - 18	Fleetside	5' 7"	--	--	--	--	--	--	--	--	--	--	●	--	--	--	--	--	●	--	--	--	--	●	--	
		11 - 18	Fleetside	6' 4"	--	--	--	--	--	--	--	--	--	--	●	--	--	--	--	--	●	--	--	--	--	●	--	
		11 - 18	Fleetside	6' 4"	--	--	--	--	--	--	--	--	--	--	●	--	--	--	--	--	●	--	--	--	--	●	--	
Standard	11 - 18	Fleetside	6' 4"	--	--	--	--	--	--	--	--	--	--	●	--	--	--	--	--	●	--	--	--	--	●	--		
	11 - 18	Fleetside	8'	--	--	●	--	--	●	--	●	--	--	●	●	--	--	--	●	--	--	●	--	--	●	--		
1500 Classic	Extended	19 - 19	Fleetside	5' 7"	--	--	--	--	--	--	--	--	--	--	●	--	--	--	--	--	●	--	--	--	--	●	--	
		19 - 19	Fleetside	6' 4"	--	--	--	--	--	--	--	--	--	--	●	--	--	--	--	--	●	--	--	--	--	●	--	
	Standard	19 - 19	Fleetside	6' 4"	--	--	--	--	--	--	--	--	--	--	●	--	--	--	--	--	●	--	--	--	--	●	--	
19 - 19		Fleetside	8'	--	--	●	--	--	●	--	●	--	--	●	●	--	--	--	●	--	--	●	--	--	●	--		
2500	Crew	11 - 19	Fleetside	6' 4"	--	--	--	--	--	--	--	--	--	●	--	--	--	--	--	--	●	--	--	--	--	●	--	
		11 - 19	Fleetside	8'	--	--	●	--	--	●	--	●	--	--	●	●	--	--	--	●	--	--	●	--	--	●	--	
	Ext. Crew	11 - 19	Fleetside	6' 4"	--	--	●	--	--	●	--	●	--	--	●	●	--	--	--	●	--	--	●	--	--	●	--	
		11 - 19	Fleetside	8'	--	--	●	--	--	●	--	●	--	--	●	●	--	--	--	●	--	--	●	--	--	●	--	
	Standard	11 - 19	Fleetside	6' 4"	--	--	●	--	--	●	--	●	--	--	●	●	--	--	--	●	--	--	●	--	--	●	--	
11 - 19		Fleetside	8'	--	--	●	--	--	●	--	●	--	--	●	●	--	--	--	●	--	--	●	--	--	●	--		
3500	Crew	11 - 19	Fleetside	6' 4"	--	--	--	--	--	--	--	--	--	●	--	--	--	--	--	--	●	--	--	--	--	●	--	
		11 - 19	Fleetside	8'	--	--	●	--	--	●	--	●	--	--	●	●	--	--	--	●	--	--	●	--	--	●	--	
	Ext. Crew	11 - 19	Fleetside	6' 4"	--	--	●	--	--	●	--	●	--	--	●	●	--	--	--	●	--	--	●	--	--	●	--	
		11 - 19	Fleetside	8'	--	--	●	--	--	●	--	●	--	--	●	●	--	--	--	●	--	--	●	--	--	●	--	
	Standard	11 - 19	Fleetside	6' 4"	--	--	●	--	--	●	--	●	--	--	●	●	--	--	--	●	--	--	●	--	--	●	--	
11 - 19		Fleetside	8'	--	--	●	--	--	●	--	●	--	--	●	●	--	--	--	●	--	--	●	--	--	●	--		
Dakota	Extended	11 - 11	Fleetside	5' 6"	--	--	--	--	--	--	--	--	--	●	--	--	--	--	--	●	--	--	--	--	●	--		
Suzuki																												
Equator	Crew	09 - 12	Styleside	5'	--	--	--	--	--	--	--	--	--	●	--	--	--	--	--	--	●	--	--	--	--	●	--	
		09 - 12	Styleside	6'	--	--	--	--	--	--	--	--	--	--	●	--	--	--	--	--	●	--	--	--	--	●	--	
Toyota																												
Tacoma	Crew	19 - 19	Fleetside	5'	--	--	--	--	--	--	--	--	--	●	--	--	--	--	--	--	●	--	--	--	--	●	--	
		05 - 15	Fleetside	5'	--	--	--	--	--	--	--	--	--	--	●	--	--	--	--	--	●	--	--	--	--	●	--	
		05 - 15	Fleetside	6'	--	--	--	--	--	--	--	--	--	--	●	--	--	--	--	--	●	--	--	--	--	●	--	
	Extended	05 - 15	Fleetside	6'	--	--	--	--	--	--	--	--	--	--	●	--	--	--	--	--	●	--	--	--	--	●	--	
		01 - 04	Fleetside	5'	--	--	--	--	--	--	--	--	--	--	●	--	--	--	--	--	●	--	--	--	--	●	--	
	Standard	05 - 14	Fleetside	6'	--	--	--	--	--	--	--	--	--	--	●	--	--	--	--	--	●	--	--	--	--	●	--	
96 - 04		Fleetside	6' 5"	--	--	--	--	--	--	--	--	--	--	●	--	--	--	--	--	●	--	--	--	--	●	--		
Tundra	Crew	07 - 19	Fleetside	6' 6"	--	--	--	--	--	--	--	--	--	●	--	--	--	--	--	--	●	--	--	--	--	●	--	
		07 - 19	Fleetside	8'	--	--	●	--	--	●	--	●	--	--	●	●	--	--	--	●	--	--	●	--	--	●	--	
	Extended	00 - 06	Fleetside	6' 5"	--	--	--	--	--	--	--	--	--	--	●	--	--	--	--	--	●	--	--	--	--	●	--	
		07 - 19	Fleetside	5' 5"	--	--	--	--	--	--	--	--	--	--	●	--	--	--	--	--	●	--	--	--	--	●	--	
	Ext. Crew	07 - 17	Fleetside	6' 6"	--	--	--	--	--	--	--	--	--	--	●	--	--	--	--	--	●	--	--	--	--	●	--	
		07 - 17	Fleetside	8'	--	--	●	--	--	●	--	●	--	--	●	●	--	--	--	●	--	--	●	--	--	●	--	
Standard	00 - 04	Fleetside	6' 5"	--	--	--	--	--	--	--	--	--	--	●	--	--	--	--	--	●	--	--	--	--	●	--		
	00 - 06	Fleetside	8'	--	--	●	--	--	●	--	●	--	--	●	●	--	--	--	●	--	--	●	--	--	●	--		



DOG BOXES

COMFORTABLE CANINE TRANSPORT

A UWS truck dog box is the safe, comfortable way for your customers to bring their dogs along for the adventure. Our dog boxes are available in northern and southern styles, optimized for whichever region your customers will be driving in. We also offer an integrated storage chest option and a separate dog accessories box, providing extra, secure space for storing dog collars, training equipment and more. Each UWS dog box is made from aluminum, right here in the USA.



FEATURED PRODUCTS



Northern dog box

This double-door dog box features enclosed walls to help protect from wind and cold temps. It is also equipped with a top storage chest.



Southern dog boxes

These dog boxes have open rungs to let in cool breeze, and they are available with single or double doors. Both have a top tie-down rail.



Accessory box

This 34" wide box fits perfectly into the top of our dog boxes, providing secure storage of collars, training dummies and other accessories.

PRODUCT INDEX



100
Southern
Dog Boxes

Made in USA



101
Dog Box
Accessory

Made in USA



102
Northern
Dog Box

Made in USA

SOUTHERN DOG BOXES



KEY FEATURES

Premium design to transport your dogs and dog equipment safely and securely

Open rungs allow for consistent airflow to help keep dogs cool

Product Details

- Rail provides a reliable anchor for tying down cargo on top
- 0.058" one-piece aluminum to be strong, lightweight and corrosion-resistant
- Stainless steel lock handle for security and corrosion-resistant operation



DB-3636

Finish & Material



Finish:
Bright aluminum

Material:
Aluminum alloy



DB-4848

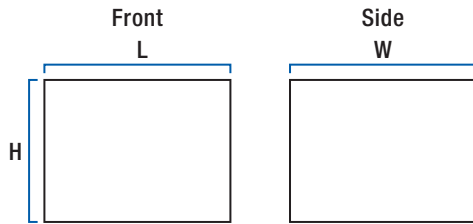

Southern Dog Boxes								
Part#	Finish	Cubic Feet	# of Doors	Door Opening Dims (in.)		Box Dimensions (inches)		
				L	H	L	W	H
DB-3636	Bright aluminum	18	1	18.4375	21	36	36	24
DB-4848	Bright aluminum	32	2	17.25	21	48	48	24



ACCESSORY BOX

- Storage box designed for securing dog tracking collars and other small items
- Suitable for mounting on truck-based dog box or other surfaces
- Patented RigidCore™ foam-filled lid to maximize strength and prevent binding
- 0.058" extra-thick, one-piece aluminum tub holds heavy tools and cargo
- Beveled lid limits sharp edges and promotes ease of opening
- Stainless steel lock handle for security and corrosion-resistant operation
- MicroSeal™ gasket helps seal out moisture, dust and dirt
- Lid self-opens to 90 degrees for convenient operation and loading

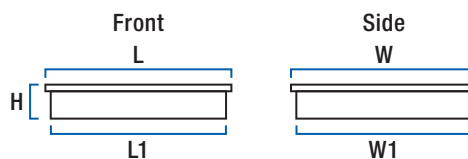

Accessory Box

Part#	Finish	Cubic Feet	Dimensions (inches)				
			L	L1	W	W1	H
TCB-34	Bright alum.	3.4	31.875	31	35	34	6.625

NORTHERN DOG BOX



KEY FEATURES

Premium design to transport your dogs and dog equipment safely and securely

Enclosed walls help keep dogs warm and protect them from wind and the elements

See page 101 for
accessory box

Product Details

- Rail provides a reliable anchor for tying down cargo on top
- 0.058" one-piece aluminum to be strong, lightweight and corrosion-resistant
- Stainless steel lock handles for security and corrosion-resistant operation
- Built-in tool box provides added storage without reducing truck bed space
- Patented RigidCore™ foam-filled lid to maximize strength and prevent binding
- MicroSeal™ gasket helps seal out moisture, dust and dirt
- Self-opening lid automatically opens for convenience when hands are full
- Cleanout ports at the back of each compartment for easy cleaning



DB-4848N

Finish & Material



Finish:
Bright
aluminum

Material:
Aluminum
alloy

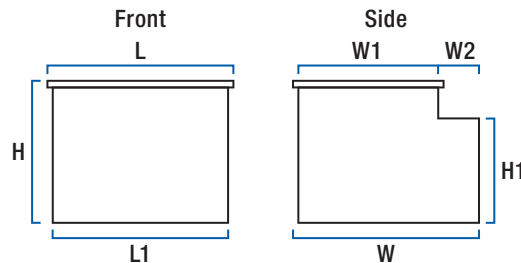

Northern Dog Box

Part#	Finish	Cubic Feet	# of Doors	Door Opening Dims (in.)		Dimensions (inches)						
				L	H	L	L1	W	W1	W2	H	H1
DB-4848N	Bright aluminum	35.2	2	15.625	17.4375	48	47.1875	48.25	34.625	13.625	28.125	23





ACCESSORIES

GO ABOVE AND BEYOND

UWS truck accessories add functionality to your customer's truck. We offer an aluminum cargo carrier with an as-needed, hitch-mounted design for convenient installation, as well as an aluminum ladder rack for transporting an extension ladder, siding, pipes or other length materials. We also offer a number of replacement parts to accommodate all UWS tool boxes, including handles, hardware, trays, drawers, logo badges and much more.



FEATURED PRODUCTS



Cargo carrier

This lightweight aluminum cargo carrier easily mounts onto any 2" hitch receiver and provides extra storage with a 500-lb. capacity.



Ladder racks

These aluminum brackets mount onto virtually any truck bed wall and provide a load capacity of up to 250 lbs. for hauling long materials.



Replacement parts

We offer a wide variety of replacement parts for our crossover tool boxes, utility chests, transfer tanks and much more.

PRODUCT INDEX



106

Cargo
Carrier

Made in USA



107

Ladder
Racks

Made in USA



108

Replacement
Parts

Made in USA

CARGO CARRIER



KEY FEATURES

Mounts onto any 2" x 2" receiver tube opening

Rated to carry loads up to 500 lbs.



UWS-CARRIER

Product Details

- Fully welded 0.058" aluminum construction with heavy-duty beam platform
- Optional chest #TBC-48-DD provides lockable, weatherproof rear hitch storage (see below)

Finish & Material



Finish:
Bright aluminum

Material:
Aluminum alloy

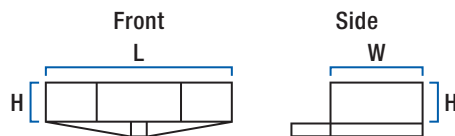

Cargo Carrier

Part#	Finish	Capacity	Dimensions (inches)		
			L	W	H
UWS-CARRIER	Bright aluminum	500 lbs.	51	23	6.38

UTILITY CHEST BOX

- Provides a perfect fit for the #UWS-CARRIER
- Patented RigidCore™ foam-filled lid
- 0.058" extra-thick, one-piece aluminum tub
- Stainless steel lock handles for security
- [See page 52 for more information](#)

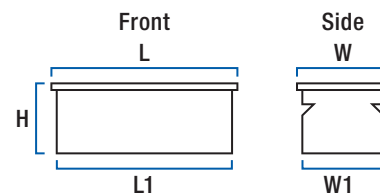

Utility Chest Box

Part#	Finish	Box Weight	Cubic Feet	Dimensions (inches)				
				L	L1	W	W1	H
TBC-48-DD	Bright aluminum	39.6 lbs.	11.1	47.875	47	20.6875	20	21.125

LADDER RACKS



KEY FEATURES

Designed to transport ladders, pipes, siding and other lengthy materials

Constructed from square aluminum tubing for maximum strength

Product Details

- Rated to carry loads up to 250 lbs.
- Easy to install with included mounting hardware
- Sold as a two-rack set

Finish & Material



Finish:
Anodized aluminum
Material:
Aluminum alloy

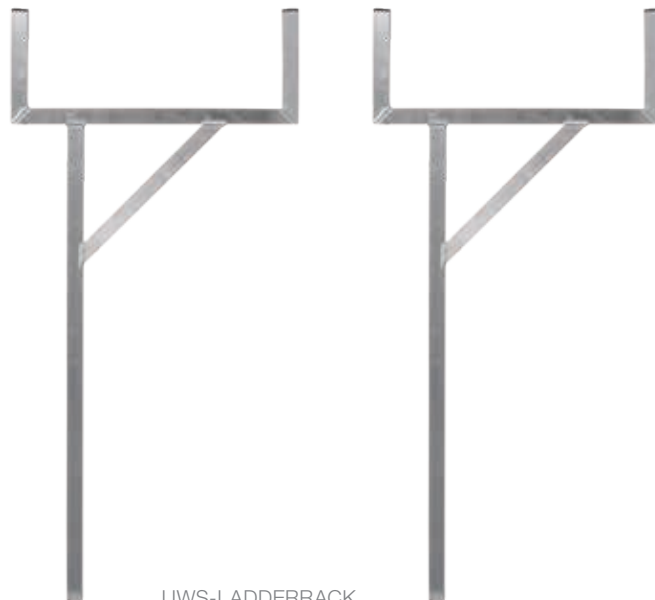
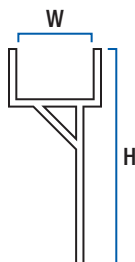

UWS-LADDERRACK



Ladder Rack

Part#	Finish	Dimensions (inches)	
		W	H
UWS-LADDERRACK	Anodized aluminum	25	57.50

REPLACEMENT PARTS



003-CH503CYLNDR



003-HDL



UWS-NHPIN



003-SLLKBLK



003-002LC



UWS-LOCKING



UWS-NONLOCKING



UWS-THLOCK



UWS-TWISTLOCK



003-NHPIN



UWS-SBRACKET



UWS-TCA



UWS-BALL-STUD



UWS-JBOLTKIT



UWS-ROD-CONNECT



UWS-STACHONS



UWS-CAPS



UWS-LIFT-CYLIND

Replacement Parts

Part#	Description	Fits
003-CH501CYLNDR	Lock cylinder and keys	Paddle handle boxes
003-CH502CYLNDR	Lock cylinder and keys	Paddle handle boxes
003-CH503CYLNDR	Lock cylinder and keys	Paddle handle boxes
003-CH504CYLNDR	Lock cylinder and keys	Paddle handle boxes
003-CH505CYLNDR	Lock cylinder and keys	Paddle handle boxes
003-CH506CYLNDR	Lock cylinder and keys	Paddle handle boxes
003-CH507CYLNDR	Lock cylinder and keys	Paddle handle boxes
003-CH508CYLNDR	Lock cylinder and keys	Paddle handle boxes
003-CH509CYLNDR	Lock cylinder and keys	Paddle handle boxes
003-CH510CYLNDR	Lock cylinder and keys	Paddle handle boxes
003-HDL	Locking pull handle	Pull handle boxes
003-HDL-KEY0001	Replacement keys	Pull handle boxes
003-HDL-KEY0002	Replacement keys	Pull handle boxes
003-HDL-KEY0003	Replacement keys	Pull handle boxes
003-HDL-KEY0004	Replacement keys	Pull handle boxes
003-HDL-KEY0005	Replacement keys	Pull handle boxes
003-HDL-KEY0006	Replacement keys	Pull handle boxes
003-HDL-KEY0007	Replacement keys	Pull handle boxes
003-HDL-KEY0008	Replacement keys	Pull handle boxes
003-HDL-KEY0009	Replacement keys	Pull handle boxes
003-HDL-KEY0010	Replacement keys	Pull handle boxes

Replacement Parts

Part#	Description	Fits
003-HDNL	Nonlocking pull handle	Pull handle boxes
003-NHPIN	Nail head striker pin, 1/4"	All boxes, excluding Secure Lock
003-RIVET-BLK	Black rivets , 3/16"	All boxes
003-SLLKBLK	Lockable handle	Secure Lock boxes
003-USTRIKER	Secure lock striker	Secure Lock boxes
003-001LC	Lock core replacement	Pull handle boxes
003-001THLC	T-handle lock cylinder and key	Topside, underbody, drawer and dog boxes
003-002LC	Lock core replacement	Pull handle boxes
003-002THLC	T-handle lock cylinder and key	Topside, underbody, drawer and dog boxes
003-003LC	Lock core replacement	Pull handle boxes
003-003THLC	T-handle lock cylinder and key	Topside, underbody, drawer and dog boxes
003-004LC	Lock core replacement	Pull handle boxes
003-004THLC	T-handle lock cylinder and key	Topside, underbody, drawer and dog boxes
003-005LC	Lock core replacement	Pull handle boxes
003-005THLC	T-handle lock cylinder and key	Topside, underbody, drawer and dog boxes
003-006LC	Lock core replacement	Pull handle boxes
003-006THLC	T-handle lock cylinder and key	Topside, underbody, drawer and dog boxes
003-007LC	Lock core replacement	Pull handle boxes
003-007THLC	T-handle lock cylinder and key	Topside, underbody, drawer and dog boxes
003-008LC	Lock core replacement	Pull handle boxes
003-008THLC	T-handle lock cylinder and key	Topside, underbody, drawer and dog boxes
003-009LC	Lock core replacement	Pull handle boxes
003-009THLC	T-handle lock cylinder and key	Topside, underbody, drawer and dog boxes
003-010LC	Lock core replacement	Pull handle boxes
003-010THLC	T-handle lock cylinder and key	Topside, underbody, drawer and dog boxes
UWS-BALL-STUD	10mm ball stud	All boxes with lift cylinder
UWS-BLD69A	Replacement BedRug™ liner	Secure Lock boxes (deep 69" angled)
UWS-BL69	Replacement BedRug™ liner	Secure Lock boxes (standard 69")
UWS-BL72	Replacement BedRug™ liner	Secure Lock boxes (standard 72")
UWS-BOXFOAM	Foam for bed rail protection	All crossover boxes
UWS-CABLE	12" stainless cable with eyes	Topside and underbody boxes
UWS-CAPS	Fuel cap	All transfer tanks
UWS-DSDIVIDER	Plastic divider, 3"	Drawer boxes
UWS-GRABHANDLE	Grab handle	TBC-38-DS (truck utility box with drawers)
UWS-HOOK60	Velcro hook, 1" x 60"	Secure Lock boxes
UWS-JBOLTKIT	J-bolt kit	All crossover boxes
UWS-LIFT-CYLIND	Lift cylinder	All boxes with 45 lb. lift cylinder
UWS-LOCKING	Locking paddle handle	All paddle handle boxes
UWS-MAGNETPULL	Magnetic door catch	TBC-38-DS (truck utility box with drawers)
UWS-NONLOCKING	Non locking paddle handle	All two-handle paddle handle boxes
UWS-P-TRAYS	Plastic tray	All standard crossover boxes
UWS-PULLHANDLE	Chest handles	ATV, foot locker and tote boxes
UWS-ROD-CONNECT	Rod connector with set screw	All two-handle boxes
UWS-SBRACKET	Striker bracket	All boxes excluding TB-1 and TB-2
UWS-TCA	Top cylinder bracket assembly	All boxes with lift cylinders
UWS-THLOCK	Folding T-handle, locking	Topside, underbody, dog boxes and fender boxes
UWS-TWISTLOCK	Twist lock	Tote boxes
UWS-1-4KEPNUT	Kep nut, 1/4"	Multiple applications
UWS-34CLOSEDCEL	MicroSeal™ gasket	Topside, underbody, dog boxes and fender boxes
UWSLGLIFTCYLNR	Extra long lift cylinder	Extra-wide crossover models only



MARKETING MATERIALS

FULLY SUPPORTING YOUR BUSINESS

We believe in providing our customers with unique products and fully supporting the sale of those products in-store and online. For in-store sales, we offer signage, display stands and literature to draw in more traffic and help your customers make an informed buying decision. For online sales, we offer extensive image, video and content libraries available for your use. To use these resources on your website, please speak to your sales representative.

Contact your sales representative for a complete list of available items and how to qualify.

Literature & Catalog

- Tri-fold literature (8-1/2" x 3-1/2") focuses on educating the consumer about the advantages of UWS tool boxes
- The catalog provides a complete listing of UWS products and vehicle applications (#9940010)
- Clear plastic stands available for displaying literature



9940007



9940011

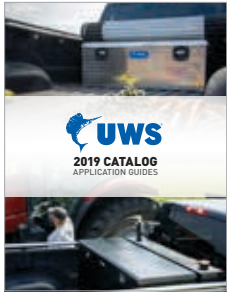

9940010

Banner & Retail Signage

- Bold graphics and clear messaging to draw attention to your store
- Banner for use in-store and outdoors to help identify and promote your UWS tool box offering



9940002



9940003

Tool Box Display Stand

- Contact your UWS sales representative to determine the products best tailored to your needs
- Floor stand display can mount various tool boxes



9940009 display stand and included header card (tool boxes sold separately)

Display Signage

- Promotional placards for use on display stands or as in-store signage to help promote key UWS tool box features. Set includes:
 - Header card
 - Tool tray insert
 - Built-in features insert
 - Made in USA banner
 - Product features header 1
 - Product features header 2



PRO428 sticker signage set (tool box sold separately)



**TOUGH.
RELIABLE.
USA-MADE.**

Dependability does not come automatically. It has to be earned. Whether it's an individual, a truck or a piece of equipment – earning a reputation for being dependable is something that comes through dedication, consistency and hard work.

At UWS, we are determined to provide dependable products for hardworking individuals. That is why each of our tool boxes is made right here in the USA and why we continue to pursue innovation and quality enhancement in our product line.

From farmers, contractors and sportsmen to everyday American families, we want to give our consumers something they can be proud to mount in their truck and that will give them the security and confidence to achieve a job well done.



Discover other truck bed accessories on our website.